



emco carpet mats

Clean – Custom options – Premium Quality

**EMCO**



## **emco – Designing clean entrances**

Take the first step towards cleanliness – on our entrance matting systems. We are one of the world's leading manufacturers of entrance mat systems that are designed to reduce dirt and damp trafficking into buildings. But our systems do much more than protect buildings and their users. Combining customised designs and high-quality workmanship, they help any entrance area make a grand entrance of its own.

**emco carpet mats****Variety, flexibility and quality right down to the last detail** ..... 4 – 11emco **IMAGE** ..... 12 – 15emco **IMAGE STYLE** ..... 16 – 21emco **CLASSIC** ..... 22 – 25**Materials and design** ..... 26 – 27**Label positions** ..... 28 – 29**Quality and warranty** ..... 30**Washing and storage** ..... 31**Benefits** ..... 32**The company** ..... 33**Order form** ..... 34**Sales offices** ..... 35 – 36

# Quality from the ground up

As the European leader in the entrance matting systems market, we aim to ensure that building interiors provide hygienic, safe environments – and our washable carpet mats are our solution to this. To create them, we combine decades of experience, innovative production processes and superior design standards. And the result? High-quality carpet mats that not only offer winning functional features, but also provide an attention-grabbing advertising medium. Our carpet mats are manufactured exclusively in Germany. For us, establishing our production processes here is an obvious choice; for you, it represents a promise of quality that we are glad to honour. Reap the benefits of our products, and pass them on to your customers.



**emco**









## A clean image

Our carpet mats come in two different styles.

With emco IMAGE carpet mats, there are virtually no limits on the printed image, design and mat shape you choose. And thanks to an almost inexhaustible range of colours, you can make any motif stand out – whether it's the company logo or a particular picture. What is more, innovative production technology allows the carpet mat to be cut to virtually any shape required.

emco CLASSIC, meanwhile, provides a more standardised alternative that is ideal for rental purposes.



# Perfectly positioned

Thanks to their high quality and the wide variety of options they offer, our carpet mats can be positioned anywhere in a building. Of course, it makes particular sense to place them in areas that high volumes of people are likely to spend time in or pass through – such as entrance areas, waiting areas, circulation areas like corridors and stairways, as well as inside and in front of lifts. Their ability to considerably reduce the risk of slippage caused by moisture ensures the areas stay clean and safe. As they are washable, they also offer a long and reliable service life.

If a carpet mat is intended to provide both a cleaning function and a representative image, then it is worth placing it in a prominent position in the room.

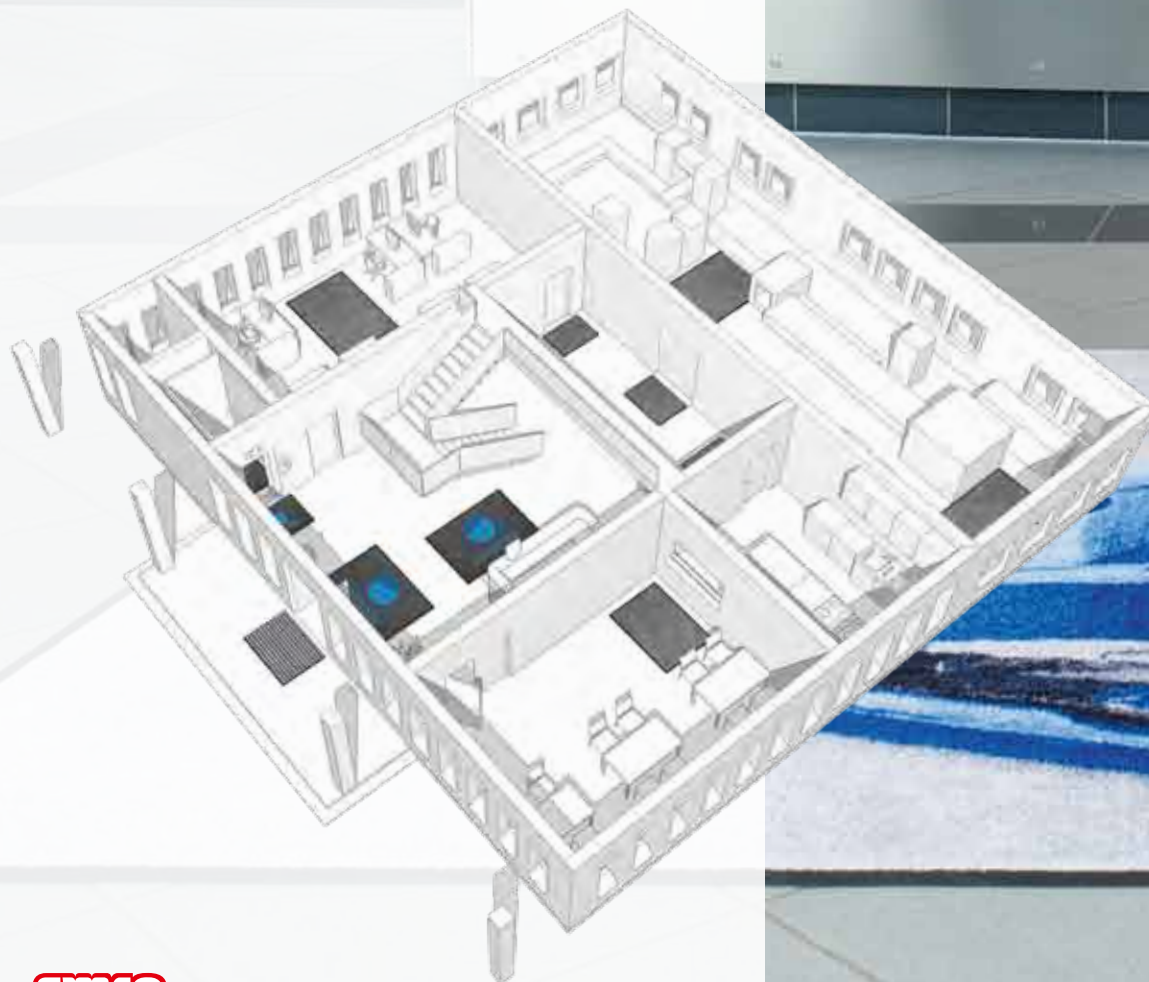



ELCOME

**NOVUS®**





# emco IMAGE

## Get your message across

If you want a carpet mat that provides information and advertising space in addition to being a cleaning system, then emco IMAGE is just what you are looking for.

Each mat can be printed with up to 32 bright colours, chosen from a total of 45 standard colours. Not only that, but special colours conforming to systems such as PMS, RAL and HKS can also be used. Thanks to the superior printing quality, it is possible to create detailed drawings, text and design elements as well as effects such as outlines, shadows and colour gradients. You can have a carpet mat in colours that match your corporate identity, or displaying a graphic design or an individual company logo. And with the option to produce patterned areas or single images of up to 2 m wide, the emco IMAGE carpet mat gives you virtually unlimited freedom to create the design you want.



**emco**



*Sechs Generationen und ihre Schiffe*



JOHANN MEYER  
1795-1868



Franz Joseph Meyer  
1838-1900



GUSTAV MEYER  
1868-1938



HUGO FRANZ MEYER  
1898-1978



GERHARD MEYER  
1918-2008





# emco IMAGE

Technical data	
Pile material	High twist nylon (100% polyamide 6.6), effective pile weight 900 g/m <sup>2</sup>
Pile height	Approx. 7-8 mm
Backing material	Nitrile rubber coating, thickness approx. 1,4 mm
Total height of mat	Approx. 8-9 mm
Total weight	2.600 g/m <sup>2</sup>
Border width	Approx. 20 mm
Printing method	Chromojet printing method
Colours	Max. 32 of 45
Water absorption	Approx. 3 to 4 litres per m <sup>2</sup>
Washing temperature	Max. 60 °C
Fastness to washing	Colourfast in acc. with DIN 54006
Electrostatic behaviour	Very low electrostatic discharge, volume resistance 2.2 x 10 <sup>11</sup> ohms, in acc. with DIN 54345
Oil resistance (nitrile rubber backing)	Very good
Fire resistance (on request, subject to additional charge)	Acc. to C <sub>n</sub> - s <sup>1</sup> (in acc. with EN 13501), flame resistant
Customer specific border label	On request
Backing material	Smooth or dimpled
Dimensional tolerance	+/- 3%

## Standard dimensions in cm

85 x 75	100 x 200	115 x 180	150 x 200	200 x 200
85 x 120		115 x 200	150 x 250	200 x 300
85 x 150		115 x 240		200 x 400

Special dimensions possible, up to 200 x 500 cm

## Material structure

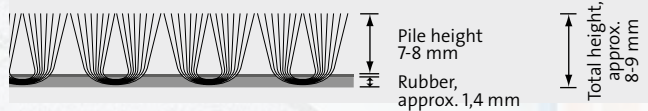

## Colours

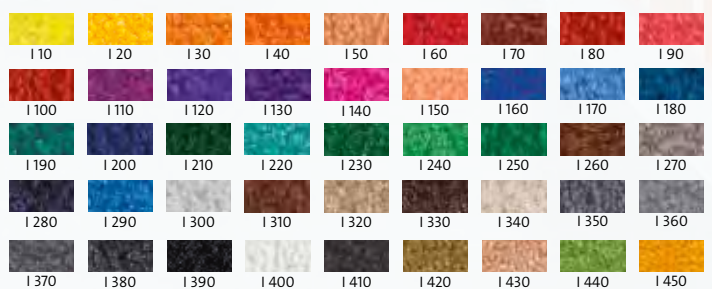

# emco **IMAGE STYLE**

## **Logo – A real eye-catcher**

The emco IMAGE STYLE special shape mat combines the brightness and variety of colour of emco IMAGE with the ability to create virtually any shape of your choosing. Thanks to the very latest technology, alongside the standard geometries with which you will no doubt be familiar, mats can now also be cut in special shapes (to represent products or company logos, for example).

Thanks to this ability to support custom designs, emco IMAGE STYLE mats exude quality and functionality, as well as grabbing the attention as a promotional medium. Company logos and brand names can be positioned where they will capture the most attention and make the biggest possible impact. Complex special formats to complement structural design can also be achieved.











## emco IMAGE STYLE

### Guiding and enticing

With their truly individual eye catching style, the emco IMAGE STYLE special shape mats turn floors into a promotional medium. They are ideal for both long-term campaigns and one-off promotions (for new products or special offers and seasonal marketing at Christmas or Easter, for example). Whilst slippery floor stickers have a limited service life after which they have to be disposed of, with regular cleaning, these high-quality mats will last and last. Furthermore, they are flexible in application as they can be moved to wherever they are needed the most.

The custom design mats function as guidance systems, as their design, format and size can be adapted to meet prevailing building requirements with ease, taking visitors and customers where you want them to go. In this regard they contribute to hygiene, because they keep entrance areas and floors permanently clean. As they are washable, they retain their looks and always provide a warm welcome.



# emco IMAGE STYLE

Technical data	
Pile material	High twist nylon (100% polyamide 6.6), effective pile weight 900g/m <sup>2</sup>
Pile height	Approx. 7-8 mm
Backing material	Nitrile rubber coating, thickness approx. 1.7 mm
Total height of mat	Approx. 8-9 mm
Total weight	2.600 g/m <sup>2</sup>
Border width	Approx. 20 mm
Printing method	Chromojet printing method
Colours	Max. 32 of 45
Water absorption	Approx. 3 to 4 litres per m <sup>2</sup>
Washing temperature	Max. 60 °C
Fastness to washing	Colourfast in acc. with DIN 54006
Electrostatic behaviour	Very low electrostatic discharge, volume resistance 2.2 x 10 <sup>11</sup> ohms, in acc. with DIN 54345
Oil resistance (nitrile rubber backing)	Very good
Fire resistance (on request, subject to additional charge)	Acc. to C <sub>n</sub> - s <sup>1</sup> (in acc. with EN 13501), flame resistant
Customer specific border label	On request
Backing material	Smooth or dimpled
Dimensional tolerance	+/- 3%

## Standard dimensions in cm

85 x 75	100 x 200	115 x 180	150 x 200	200 x 200
85 x 120		115 x 200	150 x 250	200 x 300
85 x 150		115 x 240		200 x 400

Special dimensions possible, up to 200 x 500 cm

## Material structure

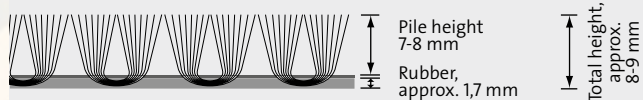

## Colours

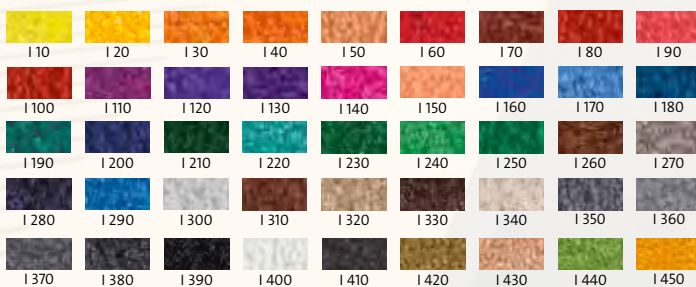

**emco**





# emco CLASSIC

## Traditional quality

Wherever neutrality and functionality are the order of the day, emco CLASSIC carpet mats can be relied upon to do their job in perfect harmony with their surroundings. In so doing, they provide the perfect complement to prominently positioned emco IMAGE carpet mats.

Thanks to optimum product quality, the mats are able to absorb dirt and moisture very well. Floors and floor coverings can be sure of long-term protection, as the hard-wearing mats are just as much a match for intense loads as they are for cleaning at frequent intervals. Without printed images, the mats are available in five standard colours measuring up to 200 x 500 cm.

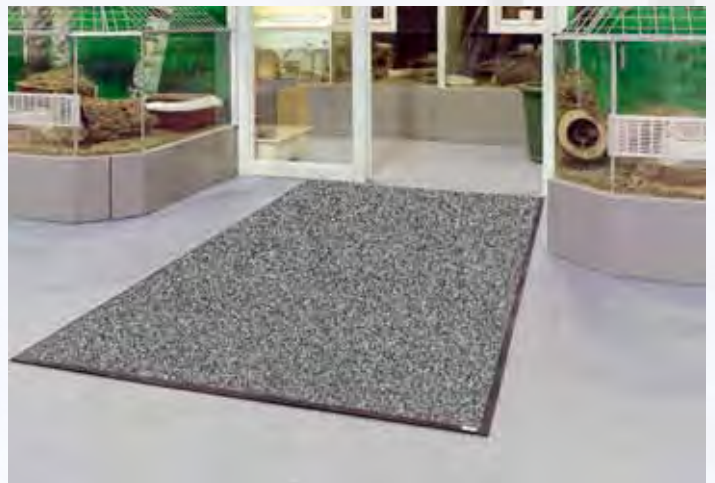

# emco CLASSIC

Technical data	
Pile material	High twist nylon (100% polyamide 6), effective pile weight 650 g/m <sup>2</sup>
Pile height	Approx. 8 mm
Backing material	Nitrile rubber coating, thickness approx. 1,4 mm
Total height of mat	Approx. 10 mm
Total weight	2.500 g/m <sup>2</sup>
Border width	Approx. 20 mm
Colours	5
Water absorption	Approx. 3 to 4 litres per m <sup>2</sup>
Washing temperature	Max. 80 °C
Electrostatic behaviour	Very low electrostatic discharge, volume resistance 2.2 x 10 <sup>11</sup> ohms, in acc. with DIN 54345
Oil resistance (nitrile rubber backing)	Very good
Fire resistance (on request, subject to additional charge)	Acc. to C <sub>0</sub> - s <sup>1</sup> (in acc. with EN 13501), flame resistant
Customer specific border label	On request
Backing material	Smooth or dimpled
Dimensional tolerance	+/- 3%

## Standard dimensions in cm

85 x 75	100 x 200	115 x 180	150 x 200	200 x 200
85 x 120		115 x 200	150 x 250	200 x 300
85 x 150		115 x 240		200 x 400

Special dimensions possible, up to 200 x 500 cm

## Material structure

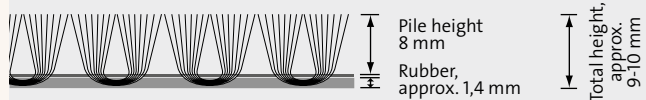

## Colours



C 10  
Grey

C 20  
Rock

C 30  
Graphite

C 50  
Dark Blue

C 60  
Dark Brown

**emco**