

Tile Substructure System

Aslon Systems has developed the Tile Substructure System specifically to maintain a well-laid terrace in different types of weather conditions.

The Tile Substructure System consists of three parts: aluminium girders, tile spacers and border edges. The aluminium girders can be placed on various surfaces, such as a concrete floor, a wooden frame, roofing, concrete tiles and edging.

By using tile spacers and tile stoppers, the tiles can be placed tightly into the system. Aslon Systems has developed three different aluminium girders, which make it possible to achieve different heights and spans.

Provisions for light or water

The installation of power points, lighting or a water supply under the terrace is possible.

The tiles can be removed temporarily and replaced again after the work is finished. If subsidence should occur in the substructure, you can remove the tiles, repair the substructure and then replace the tiles.

Advantages

- ✓ Frost-resistant
- ✓ Rapid drainage between the tiles, no puddles on the terrace
- ✓ Space under the terrace remains free for power points, lighting or water pipes
- ✓ Tiles can easily be taken up from the terrace
- ✓ No loss of superfluous materials such as grout and mortar
- ✓ Very eco-friendly thanks to the use of 100% recyclable material
- ✓ Easy to install

Specifications

Aluminium girders	35 x 23 mm, 35 x 25 mm, 40 x 40 mm, 40 x 75 mm
Length of girders	4,000 mm
Coupling	90 x 25 x 4 mm (for low girder)
Coupling	30 x 40 x 3 mm (for medium girder)
Coupling	60 x 40 x 2 mm (for high girder)
Multi-angle	60 x 40 x 4 mm
	Includes two hammer head screws and two collar knurled nuts. The multi-angle is not suitable for use with girders measuring 35 x 23 mm.
Tile spacer	Tile spacer with space of 3 mm
Tile stop	Tile stop including two bolts and nuts
Mounting plate	60 x 44 x 4 mm including one hammer head bolt and one collar knurled nut. (only for girder 40 x 75 mm)



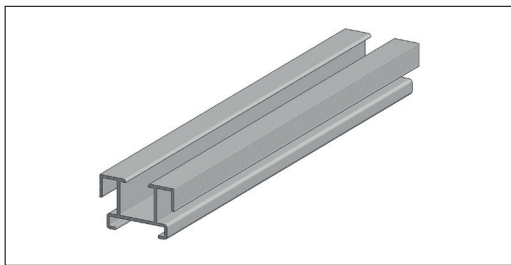

Low girder 35 x 23 mm

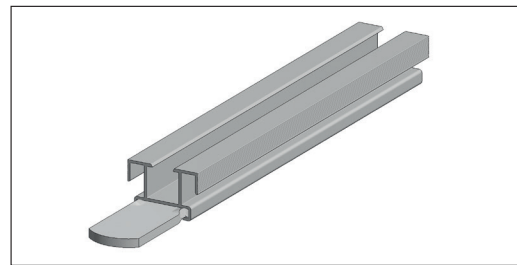

Coupling girder 35 x 23 mm

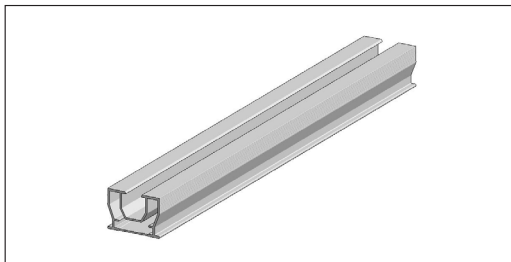

Low girder 35 x 25 mm

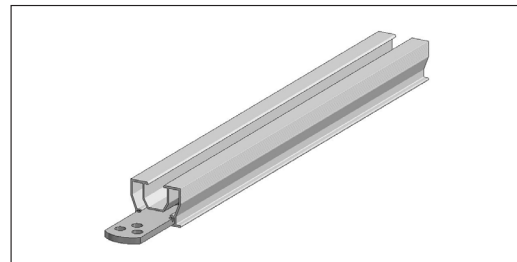

Coupling girder 35 x 25 mm

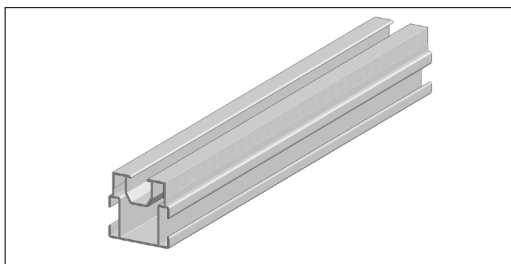

Medium girder 40 x 40 mm

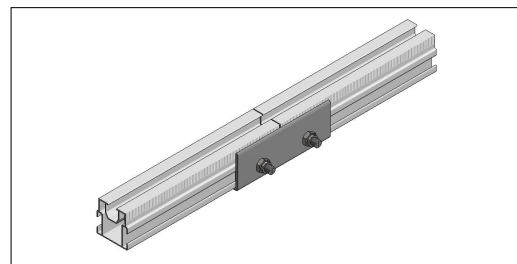

Coupling girder 40 x 40 mm

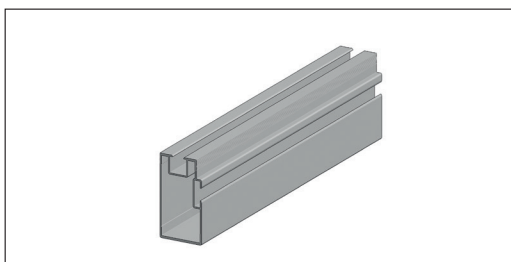

High girder 40 x 75 mm

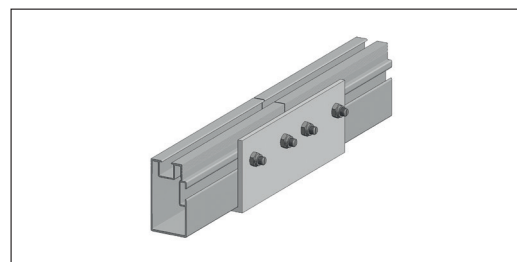

Coupling girder 40 x 75 mm

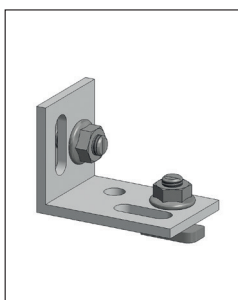

Multi-angle

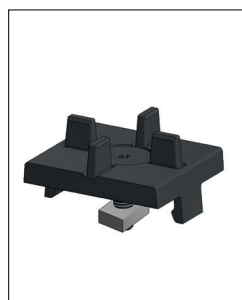

Tile spacer

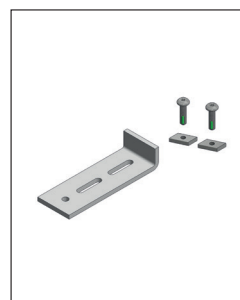

Tile stop

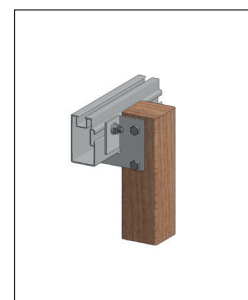

Mouting plate