

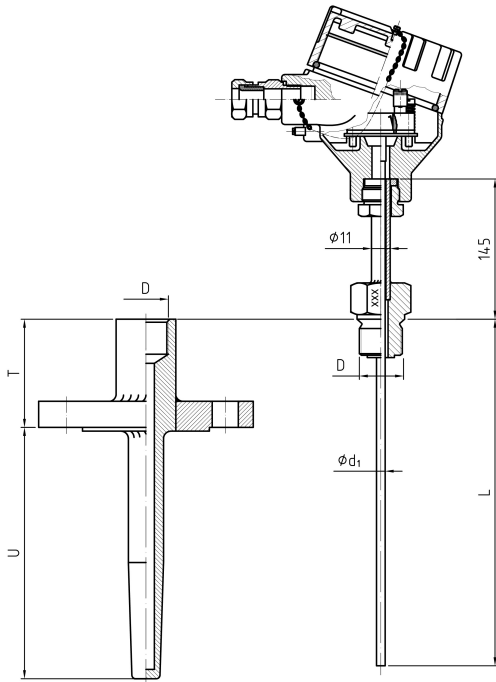

## THERMOCOUPLE Flame-proof acc. to ATEX - KDB 04 ATEX022X with additional flanged protection tube Type TER-Exd-PKG/PF-239



Thermocouple type TER-Exd-PKG/PF-239 signed  $\text{Ex}$  II 1/2 G Exd ia/lb IIA/IIB/IIC T6/T5 has been designed for temperature measurement in all explosion zones of gases, streams, fogs and dusts. In zone 0 can be only protection tube. Connection head can be only in zones 1 or 2. Limit between zones is threaded fitting and inside flame-proof protection tube can be placed only measuring insert, working in intrinsic safe wire configuration ia or ib.

Thermocouple type TER-Exd-PKG/PF-239 signed  $\text{Ex}$  II 2 G Exd IIC T6 has been designed for temperature measurement in zones 1 lub 2 and can work with non-intrinsic safe wire configuration.

Thermocouple type TER-Exd-PKG/PF-239 signed  $\text{Ex}$  II 1/2 D Ex tD A20/A21 IP67 T85°C has been designed for temperature measurement in zones 21 lub 22 and can work with non-intrinsic safe wire configuration.

Connection head is optionally equipped with 1 or 2 cable inserts, and with terminal block or transmitter.

### THERMOCOUPLE SPECIFICATION

Sheathed sensor insert	Temp. range - Class 1
1xFe-CuNi (J), 2xFe-CuNi (J)	-40°C..+600°C
1xNiCr-NiAl (K), 2xNiCr-NiAl (K)	-40°C..+800 (+1100*)°C

\*upper temperature depends on working conditions and protection tube material

#### Sheathed insert

Diameter d [mm]	Material	Length L [mm]
Ø6, Ø8	Inconel	as per client request (to 2000 mm)

Characteristic
acc. PN-EN 60584-1

Additional protection tube with flange
on request

#### Connection head

Type	Temp. range	Cable insert	Destination
Flame- proof XD-AD	-40°C..+100°C	Type 501/421	for basic cables
		Type 501/453	for armored cable

Junction
Ungrounded

Transmitter
on request acc. to ATEX

**NOTE: Non-standard models available**

## Ordering Information

TER-Exd-PKG/PF-239 - A - B - C - D - E - F - G - H - I

A. Type of thermocouple		A
	1xFe-CuNi	1xJ
	2xFe-CuNi	2xJ
	1xNiCr-NiAl	1xK
	2xNiCr-NiAl	2xK
B. Sheathed insert diameter d <sub>1</sub>		B
	Ø 6 mm	6
	Ø 8 mm	8
C. Protection tube diameter		C
		specify in mm
D. Protection tube length A		D
	A	specify in mm
E. Protection tube material		E
	1.4571	1.4571
	Hastelloy C22	C22
F. Flange of additional protection tube		F
		specify requirements and dimensions in mm
G. Cable insert		G
	1x typ 501/421	1x 501/421
	2x typ 501/421	2x 501/421
	1x typ 501/453	1x 501/453
	2x typ 501/453	2x 501/453
H. Thermocouple operating temperature		H
	T	specify in°C
I. Transmitter		I
		specify type and range in°C
K. Explosion Zone		K
	Intrinsic safe	Zone 0
	Intrinsic safe	Zone 20
	Non-intrinsic safe	Zone 1
	Non-intrinsic safe	Zone 21
	Non-intrinsic safe	Zone 2
	Non-intrinsic safe	Zone 22

## Ordering Example

**TER-Exd-PKG/PF-239-1xK-8-15-1000-1.4571-DN25PN40-400-1x501/421**

stands for : **Thermocouple flame-proof with additional flanged protection tube, with single resistor class A, configuration 3-wire, sheath diameter φ8, protection tube diameter φ15, length L=1500mm, material 1.4571, flange DN25PN40, operating temp. up to 400°C, cable insert 1 x typ 501/421, w/o transmitter.**