

SPECIFICATION

	CLASS	Wire Diameter	TEMPERATURE		THERMO-WELL	
			Normal Temp	Max. Temp	Material	Non- Material
K Type	A: ANSI-SP ±1.1°C or 0.4°C	3.2	1000°C	1200°C	21.7x16.1	17x13
		2.3	900°C	1100°C	21.7x16.1	17x13
	B: ANSI-SDT ±2.2°C or 0.75°C	1.6	850°C	1050°C	15x11	15x11
		1.0	750°C	950°C	12x9	15x11
		0.65	650°C	850°C	10x7	10x6
E Type		1.6	550°C	650°C	15x11	X
		1.0	500°C	550°C	12x9	X
		0.65	450°C	500°C	10x7	X
		0.32	300°C	400°C	10x7	X
J Type		2.3	550°C	750°C	21.7x16.1	17x13
		1.6	500°C	650°C	15x11	15x11
		1.0	450°C	550°C	12x9	15x11
		0.65	400°C	500°C	10x7	10x6
T Type		1.6	300°C	350°C	15x11	X
		1.0	250°C	300°C	12x9	X
		0.65	200°C	250°C	10x7	X
		0.32	200°C	250°C	10x7	X
B Type		0.5	1500°C	1700°C	X	15x11
R Type		0.5	1400°C	X	X	15x11
S Type		0.5	1400°C	X	X	15x11
Pt100 Ω	DIN 4370-79	8.0	L: -200~+100°C M: 0~+350°C H: 0~+650°C			
		6.4				
	A: ±(0.15+0.002 t)	4.8				
		3.2				
	B: ±(0.3+0.005 t)	1.6				
		1.0				
		0.5				

Electrical

Isolation Resistance: 1000MΩ/500Vdc

Mechanical

Material: Tube, Connection: St. Steel 316
Head: Aluminum case

Tube Diameter: 3.2, 4.8, 6.4, 8.0, 9.0, 12.75 mm

Connection: 1/4", 3/8", 1/2" NPT or PT male; 5.0Kg/cm²
Adjustment connection or Flange available

Thermo-Well: 1/4", 3/8", 1/2" NPT or PT male
Flange available

Flange Type

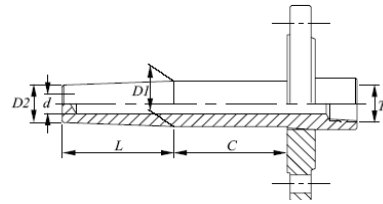

Screw Type

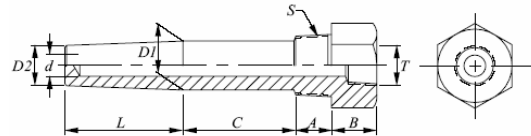

Economic Type

Lead Wire Type: PVC, Teflon..., Please specify

Wire Length: Specify

ORDER INFORMATION

