

# Single point latch with emergency opening

## PROGRAM 3000

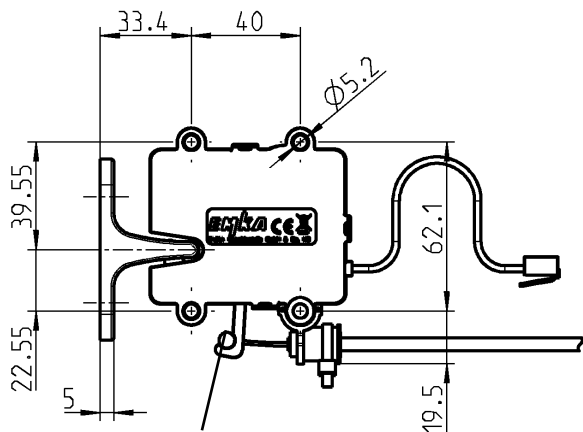

Lever for mechanic unlock, e.g. bowden cable

Single point latch with catch

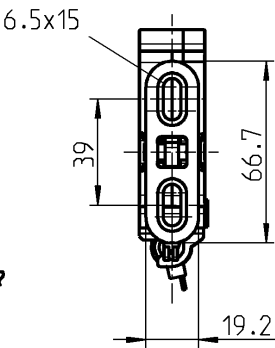

Single point latch with locking bolt

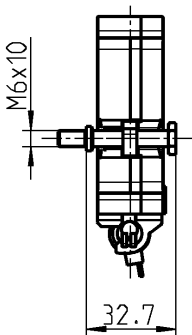

Single point latch with locking bolt

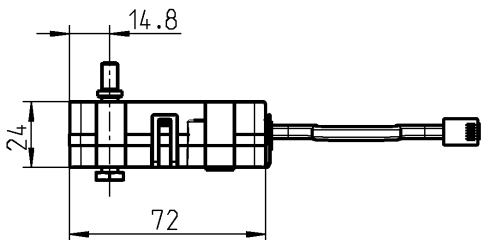

Single point latch with catch

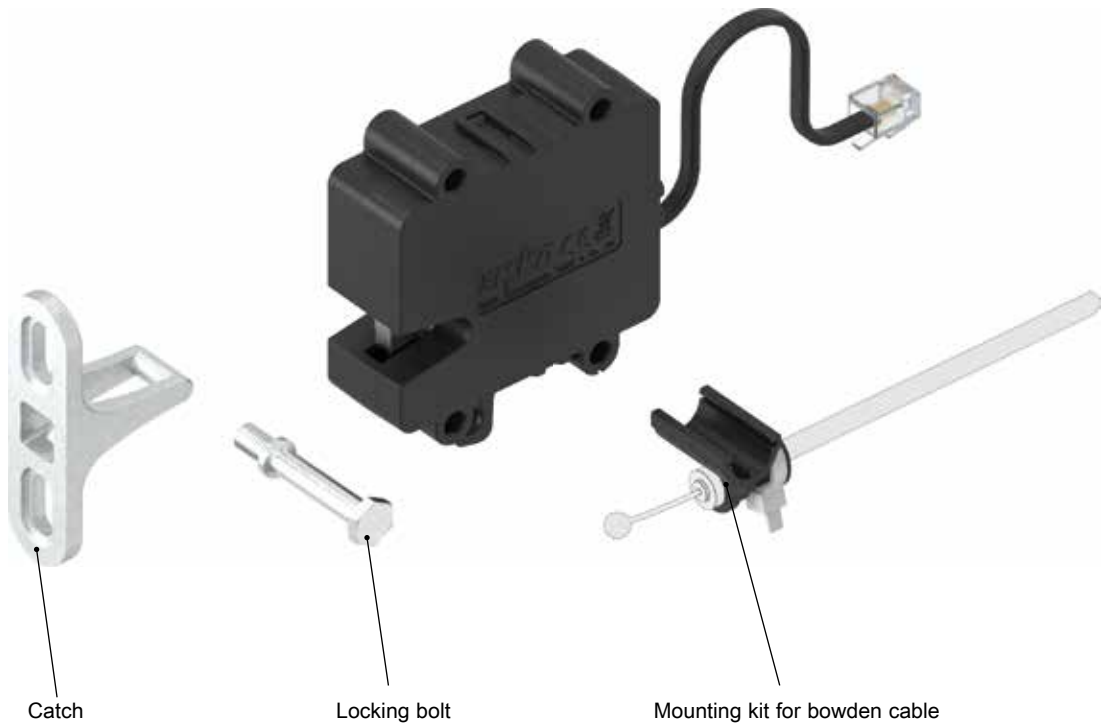
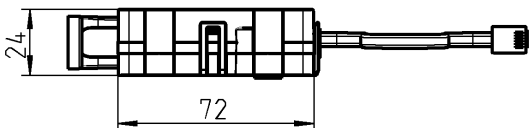

Catch

Locking bolt

Mounting kit for bowden cable

The single point latch is used in various applications as concealed lock.

The following types are available:

- Basic = latch is opened by switching on the power supply and locked as soon as the door is closed again
- Basic delayed Re-Lock = latch is opened by switching on the power supply and remains in the position 'open' as long as the power supply is applied
- Energy store = latch opens when switching off of the power supply (alternative to magnetic locks)
- Battery backup = latch is permanently powered and opened via electrical pulse; protection class IP 56



## Features

- Wide supply voltage range from 9 ... 32 V
- Potential-free switch for remote monitoring of latch status
- Emergency opening via bowden cable in case of power failure
- Locking Unit 3000-U32-x or Access Unit 3000-U47-x; adapter cable optional
- ATEX / UL-Ex approval in preparation

Connection possible to

Wiring information for

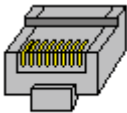
RJ45 plug front view	PIN	Basic Basic delayed Re-Lock Energy store	Battery backup	wire colours
 87654321	2	—	V -	white
	3	contact	contact	black
	4	V -	Release -	- red
	5	V - +	Release - +	- green
	6	contact	contact	yellow
	7	—	V - +	blue



Single point latch with integrated status contact,  
housing polyamide GF black;  
ratch and pawl steel lubricant varnished;  
cable 150 mm with RJ45 plug;  
with mounting and operating instructions

Power supply: 9 ... 32 VDC, 100 mA  
Contact switching power: max. 30 VDC, min. 1 mA, max. 100 mA

Basic	3000-U301-01
Basic delayed Re-Lock	3000-U301-02
Energy store; automatic unlock in case of power failure	3000-U301-03
Battery backup, IP56	3000-U301-04
<b>Catch material of your choice</b>	
AISI 316	3000-78-PH
zinc die zinc plated	3000-78-01KA
<b>Striker bolt m.s. zinc plated</b>	
	3000-102-JB
<b>Mounting kit for bowden cable polyamide GF black; washer m.s. zinc plated and cable tie</b>	
	3000-U303

On request:  
– Mounting plate  
– Bowden cable