



CAST IRON HOUSING

Y2 EY2 SERIES

THREE-PHASE ASYNCHRONOUS MOTORS

OPERATING CONDITIONS

- Ambient temperature: $-15^{\circ}\text{C} \leq \leq 40^{\circ}\text{C}$
- Above sea level: not exceed 1000m
- Rated voltage: $\pm 5\%$
- Protection Class: IP44/IP54
- Insulation Class: B/F
- Cooling method: IC0141
- Duty: continuous(S)

Y2 series three-phase asynchronous motor is designed specially for European market, whose terminal box is located on the top of motor. The motor has a very compact structure and attractive appearance, the sizes and mounting dimensions are all in conformity with IEC standard. The motor has some good feature, such as high efficiency, energy-saving. High starting torque and easy maintenance etc.

There are three kinds of installation construction for motor:
 B3 Frame with foot, end shield without flange,
 B35 Frame with foot, end shield with flange,
 B5 Frame without foot, end shield with flange.

TECHNICAL DATA AT 380V 50Hz

TYPE	Rated Output KW	At full load				Locked current Rated current	Locked torque Rated torque	Max torque Rated torque
		Speed (r/min)	Current (A)	Eff (%)	Power Factor			
Synchronous Speed 3000r/min 50Hz								
Y ₂ 56M1-2	0.09	2670	0.37	57	0.65	6	2.2	2.4
Y ₂ 56M2-2	0.12	2730	0.43	62	0.69	6	2.2	2.4
Y ₂ 56M3-2	0.18	2750	0.58	65	0.72	6	2.2	2.4
Y ₂ 63M1-2	0.18	2710	0.58	63	0.75	6	2.2	2.4
Y ₂ 63M2-2	0.25	2710	0.75	65	0.78	6	2.2	2.4
Y ₂ 63M3-2	0.37	2710	1.1	65	0.78	6	2.2	2.4
Y ₂ 71M1-2	0.37	2730	1.1	70	0.79	6	2.2	2.4
Y ₂ 71M2-2	0.55	2760	1.5	71	0.79	6	2.2	2.4
Y ₂ 71M3-2	0.75	2730	1.9	72	0.82	6	2.2	2.4
Y ₂ 80M1-2	0.75	2770	1.9	73	0.84	6	2.2	2.4
Y ₂ 80M2-2	1.1	2770	2.7	76	0.83	6	2.2	2.4
Y ₂ 80M3-2	1.5	2800	3.5	78	0.83	6	2.2	2.4
Y ₂ 90S-2	1.5	2840	3.5	78	0.84	6	2.2	2.4
Y ₂ 90L1-2	2.2	2840	4.9	81	0.85	6	2.2	2.4
Y ₂ 90L2-2	3	2840	6.5	82	0.86	6	2.2	2.4
Y ₂ 100L1-2	3	2840	6.4	82	0.87	7	2.2	2.3
Y ₂ 100L2-2	4	2850	8.3	84	0.87	7.5	2.2	2.3
Y ₂ 112M-2	4	2800	8.3	84	0.87	7.5	2.2	2.3
Y ₂ 112L-2	5.5	2880	11.1	85	0.88	7.5	2	2.3
Y ₂ 132S1-2	5.5	2900	11.1	85	0.88	7.5	2	2.2
Y ₂ 132S2-2	7.5	2920	15	87	0.88	7.5	2	2.2
Y ₂ 132M1-2	9.2	2930	17.9	88	0.89	7.5	2	2.2
Y ₂ 132M2-2	11	2930	21	88	0.9	7.5	2	2.2
Y ₂ 160M1-2	11	2940	21	88	0.9	7.5	2	2.2
Y ₂ 160M2-2	15	2940	28	89	0.91	7.5	2	2.2
Y ₂ 160L-2	18.5	2940	34.4	90	0.91	7.5	2	2.2
Y ₂ 180M-2	22	2940	39.2	90	0.9	7.5	2	2.3
Y ₂ 200L1-2	30	2950	52.8	91	0.9	7.5	2	2.3
Y ₂ 200L2-2	37	2950	64.5	92	0.9	7.5	2	2.3
Y ₂ 225M-2	45	2970	78.2	92	0.9	7.5	2	2.3
Y ₂ 250M1-2	55	2970	95.4	92.5	0.9	7.5	2	2.3
Y ₂ 250M2-2	75	2970	129.3	93	0.9	7.5	2	2.3
Y ₂ 280M1-2	90	2970	152.2	93.8	0.91	7.5	2	2.3
Y ₂ 280M2-2	110	2980	185.6	94	0.91	7.1	1.8	2.2
Y ₂ 315M1-2	132	2980	221.6	94.5	0.91	7.1	1.8	2.2
Y ₂ 315M2-2	160	2980	265.4	94.6	0.92	7.1	1.8	2.2
Y ₂ 315L1-2	200	2980	331	94.8	0.92	7.1	1.8	2.2
Y ₂ 315L2-2	250	2980	411.6	95.3	0.92	7.1	1.6	2.2
Y ₂ 355L1-2	315	2980	517	95.6	0.92	7.1	1.6	2.2
Synchronous Speed 1500r/min 50Hz								
Y ₂ 56M1-4	0.06	1320	0.32	48	0.59	6	2.3	2.4
Y ₂ 56M2-4	0.09	1320	0.45	50	0.61	6	2.3	2.4
Y ₂ 56M3-4	0.12	1320	0.56	52	0.63	6	2.2	2.4
Y ₂ 63M1-4	0.12	1350	0.5	57	0.64	6	2.2	2.4
Y ₂ 63M2-4	0.18	1350	0.71	59	0.65	6	2.2	2.4
Y ₂ 63M3-4	0.25	1350	0.96	60	0.66	6	2.2	2.4
Y ₂ 71M1-4	0.25	1350	0.88	60	0.72	6	2.2	2.4
Y ₂ 71M2-4	0.37	1370	1.17	65	0.74	6	2.2	2.4
Y ₂ 71M3-4	0.55	1380	1.69	66	0.75	6	2.2	2.4
Y ₂ 80M1-4	0.55	1370	1.66	69	0.75	6	2.2	2.4
Y ₂ 80M2-4	0.75	1380	2.03	72	0.78	6	2.2	2.4
Y ₂ 80M3-4	1.1	1390	2.18	76	0.78	6	2.2	2.4
Y ₂ 90S-4	1.1	1400	2.78	76	0.79	6	2.2	2.4
Y ₂ 90L1-4	1.5	1400	3.63	78	0.8	6	2.2	2.4
Y ₂ 90L2-4	2.2	1400	5.16	81	0.8	7	2.2	2.3
Y ₂ 100L1-4	2.2	1420	5.09	81	0.81	7	2.2	2.3
Y ₂ 100L2-4	3	1420	6.81	82	0.81	7	2.2	2.2
Y ₂ 112M-4	4	1430	8.8	84	0.82	7	2.2	2.2
Y ₂ 112L2-4	5.5	1440	11.75	85	0.83	7	2.2	2.2
Y ₂ 132S-4	5.5	1450	11.61	85	0.84	7	2.2	2.2
Y ₂ 132M-4	7.5	1450	15.41	87	0.85	7	2.2	2.2
Y ₂ 132L1-4	9.2	1460	18.79	87	0.85	7.5	2.2	2.2
Y ₂ 132L2-4	10	1460	20.31	88	0.85	7.5	2.2	2.2
Y ₂ 132L3-4	11	1460	21.98	88	0.86	7.5	2.2	2.2
Y ₂ 160M-4	11	1460	21.73	88	0.87	7.5	2.2	2.2
Y ₂ 160L-4	15	1460	29.63	88	0.87	7.5	2.2	2.2
Y ₂ 180M-4	18.5	1470	34.3	90	0.86	7.5	2.2	2.3
Y ₂ 180L-4	22	1470	40.6	91	0.86	7.5	2.2	2.3
Y ₂ 200L-4	30	1470	54.7	92	0.86	7.2	2.2	2.3
Y ₂ 225S-4	37	1480	66.4	92	0.87	7.2	2.2	2.3
Y ₂ 225M-4	45	1480	80.5	92	0.87	7.2	2.2	2.3
Y ₂ 250M1-4	55	1480	98.1	93	0.87	7.2	2.2	2.3
Y ₂ 280S1-4	75	1480	132.7	93.8	0.87	7.2	2.2	2.3
Y ₂ 280M1-4	90	1480	158.5	94.2	0.87	7.2	2.2	2.3
Y ₂ 315S1-4	110	1490	191	94.5	0.88	6.9	2.1	2.2
Y ₂ 315M1-4	132	1490	228.4	94.8	0.88	6.9	2.1	2.2
Y ₂ 315L1-4	160	1490	273	94.9	0.89	6.9	2.1	2.2
Y ₂ 315L2-4	200	1490	334.4	95	0.89	6.9	2.1	2.2
Y ₂ 355M1-4	250	1490	420.7	95.3	0.9	6.9	2.1	2.2
Y ₂ 355L1-4	315	1490	528.4	95.6	0.9	6.9	2.1	2.2

TECHNICAL DATA AT 380V 50Hz

TYPE	Rated Output KW	At full load				Locked current Rated current	Locked torque Rated torque	Max torque Rated torque
		Speed (r/min)	Current (A)	Eff (%)	Power Factor			
Synchronous Speed 1000r/min 50Hz								
Y ₂ 80M1-6	0.37	890	1.3	62	0.70	4.70	1.90	2.00
Y ₂ 80M2-6	0.55	890	1.7	65	0.72	4.70	1.90	2.10
Y ₂ 90S-6	0.75	910	2.2	69	0.72	5.50	2.00	2.10
Y ₂ 90L-6	1.1	910	3.0	72	0.73	5.50	2.00	2.10
Y ₂ 100L-6	1.5	920	3.8	76	0.75	5.50	2.00	2.10
Y ₂ 112M-6	2.2	940	5.3	79	0.76	6.50	2.00	2.10
Y ₂ 132S-6	3	960	7.0	81	0.76	6.50	2.10	2.10
Y ₂ 132M1-6	4	960	9.3	82	0.76	6.50	2.10	2.10
Y ₂ 132M2-6	5.5	960	12.3	84	0.77	6.50	2.10	2.10
Y ₂ 160M-6	7.5	970	16.4	86	0.77	6.50	2.00	2.10
Y ₂ 160L-6	11	970	23.3	87.5	0.78	6.50	2.00	2.10
Y ₂ 180L-6	15	970	30.0	89.0	0.81	7.00	2.00	2.10
Y ₂ 200L1-6	18.5	970	36.6	90.0	0.81	7.00	2.10	2.10
Y ₂ 200L2-6	22	970	42.5	90.0	0.83	7.00	2.10	2.10
Y ₂ 225M-6	30	980	56.3	91.5	0.84	7.00	2.00	2.10
Y ₂ 250M1-6	37	980	67.5	92	0.86	7	2.1	2.1
Y ₂ 280S1-6	45	980	81.7	92.5	0.86	7	2.1	2
Y ₂ 280M1-6	55	980	99.5	92.8	0.86	7	2.1	2
Y ₂ 315S1-6	75	990	134.6	93.5	0.86	7	2	2
Y ₂ 315M1-6	90	990	161.1	93.8	0.86	7	2	2
Y ₂ 315L1-6	110	990	196.1	94	0.86	6.7	2	2
Y ₂ 315L2-6	132	990	232.5	94.2	0.87	6.7	2	2
Y ₂ 355M1-6	160	990	227.7	94.5	0.88	6.7	1.9	2
Y ₂ 355M2-6	200	990	346.4	94.7	0.88	6.7	1.9	2
Y ₂ 355L1-6	250	990	432.1	94.9	0.88	6.7	1.9	2
Synchronous Speed 750r/min 50Hz								
Y ₂ 80M1-8	0.18	630	0.9	51.0	0.61	3.30	1.80	1.90
Y ₂ 80M2-8	0.25	640	1.1	54.0	0.61	3.30	1.80	1.90
Y ₂ 90S-8	0.37	660	1.4	62.0	0.61	4.00	1.80	1.90
Y ₂ 90L-8	0.55	660	2.1	63.0	0.61	4.00	1.80	2.00
Y ₂ 100L1-8	0.75	690	2.3	71.0	0.67	4.00	1.80	2.00
Y ₂ 100L2-8	1.1	690	3.2	73.0	0.69	5.00	1.80	2.00
Y ₂ 112M-8	1.5	680	4.2	75.0	0.69	5.00	1.80	2.00
Y ₂ 132S-8	2.2	710	5.8	78.0	0.71	6.00	1.80	2.00
Y ₂ 132M-8	3	710	7.5	79.0	0.73	6.00	1.80	2.00
Y ₂ 160M1-8	4	720	9.8	81.0	0.73	6.00	1.90	2.00
Y ₂ 160M2-8	5.5	720	12.9	83.0	0.74	6.00	2.00	2.00
Y ₂ 160L-8	7.5	720	16.9	85.5	0.75	6.00	2.00	2.00
Y ₂ 180L-8	11	730	23.9	87.5	0.76	6.60	2.00	2.00
Y ₂ 200L-8	15	730	32.4	88.0	0.76	6.60	2.00	2.00
Y ₂ 225S-8	18.5	730	39.1	90.0	0.76	6.60	1.90	2.00
Y ₂ 225M-8	22	740	45.0	90.5	0.78	6.60	1.90	2.00
Y ₂ 250M1-8	30	740	63.4	91	0.79	6.6	1.9	2
Y ₂ 280S1-8	37	740	73.9	91.5	0.79	6.6	1.9	2
Y ₂ 280M1-8	45	740	89.4	92	0.79	6.6	1.9	2
Y ₂ 315S1-8	55	740	105.6	92.8	0.81	6.6	1.8	2
Y ₂ 315M1-8	75	740	143.7	93	0.81	6.6	1.8	2
Y ₂ 315L1-8	90	740	168.9	93.8	0.82	6.6	1.8	2
Y ₂ 315L2-8	110	740	206	94	0.82	6.4	1.8	2
Y ₂ 355M1-8	132	740	248	93.7	0.82	6.4	1.8	2
Y ₂ 355M2-8	160	740	299	94.2	0.82	6.4	1.8	2
Y ₂ 355L1-8	200	740	368.1	94.5	0.83	6.4	1.8	2

NOMINAL MINIMUM EFFICIENCIES (η) FOR IE2 EFFICIENCY LEVEL(50/60Hz)

TYPE	Rated Output KW	At full load				Locked current Rated current	Locked torque Rated torque	Max torque Rated torque
		Speed (r/min)	Current (A)	Eff (%)	Power Factor			
Synchronous Speed 3000r/min 50Hz								
EY ₂ 80M1-2	0.75	2770	1.9	77.4	0.84	6	2.2	2.4
EY ₂ 80M2-2	1.1	2770	2.7	79.6	0.83	6	2.2	2.4
EY ₂ 90S-2	1.5	2840	3.5	81.3	0.84	6	2.2	2.4
EY ₂ 90L1-2	2.2	2840	4.9	83.2	0.85	6	2.2	2.4
EY ₂ 100L1-2	3	2840	6.4	84.6	0.87	7	2.2	2.3
EY ₂ 112M-2	4	2800	8.3	85.8	0.87	7.5	2.2	2.3
EY ₂ 132S1-2	5.5	2900	11.1	87.0	0.88	7.5	2	2.2
EY ₂ 132S2-2	7.5	2920	15	88.1	0.88	7.5	2	2.2
EY ₂ 160M1-2	11	2940	21	89.4	0.9	7.5	2	2.2
EY ₂ 160M2-2	15	2940	28	90.3	0.91	7.5	2	2.2
EY ₂ 160L-2	18.5	2940	34.4	90.9	0.91	7.5	2	2.2
EY ₂ 180M-2	22	2940	39.2	91.3	0.9	7.5	2	2.3
EY ₂ 200L1-2	30	2950	52.8	92.0	0.9	7.5	2	2.3
EY ₂ 200L2-2	37	2950	64.5	92.5	0.9	7.5	2	2.3
EY ₂ 225M-2	45	2970	78.2	92.9	0.9	7.5	2	2.3
EY ₂ 250M1-2	55	2970	95.4	93.2	0.9	7.5	2	2.3
EY ₂ 250M2-2	75	2970	129.3	93.8	0.9	7.5	2	2.3
EY ₂ 280M1-2	90	2970	152.2	94.1	0.91	7.5	2	2.3
EY ₂ 280M2-2	110	2980	185.6	94.3	0.91	7.1	1.8	2.2
EY ₂ 315M1-2	132	2980	221.6	94.6	0.91	7.1	1.8	2.2
EY ₂ 315M2-2	160	2980	265.4	94.8	0.92	7.1	1.8	2.2
EY ₂ 315L1-2	200	2980	331	95.0	0.92	7.1	1.8	2.2
EY ₂ 315L2-2	250	2980	411.6	95.0	0.92	7.1	1.6	2.2
EY ₂ 355L1-2	315	2980	517	95.0	0.92	7.1	1.6	2.2
Synchronous Speed 1500r/min 50Hz								
EY ₂ 80M1-4	0.55	1370	1.66	69	0.75	6	2.2	2.4
EY ₂ 80M2-4	0.75	1380	2.03	79.6	0.78	6	2.2	2.4
EY ₂ 90S-4	1.1	1400	2.78	81.4	0.79	6	2.2	2.4
EY ₂ 90L1-4	1.5	1400	3.63	82.8	0.8	6	2.2	2.4

NOMINAL MINIMUM EFFICIENCIES(η) FOR IE2 EFFICIENCY LEVEL(50/60Hz)

TYPE	Rated Output KW	At full load				Locked current Rated current	Locked torque Rated torque	Max torque Rated torque
		Speed (r/min)	Current (A)	Eff (%)	Power Factor			
Synchronous Speed 1500r/min 50Hz								
EY2100L1-4	2.2	1420	5.09	84.3	0.81	7	2.2	2.3
EY2100L2-4	3	1420	6.81	85.5	0.81	7	2.2	2.2
EY2112M-4	4	1430	8.8	86.6	0.82	7	2.2	2.2
EY2132S-4	5.5	1450	11.61	87.7	0.84	7	2.2	2.2
EY2132M-4	7.5	1450	15.41	88.7	0.85	7	2.2	2.2
EY2160M-4	11	1460	21.73	89.8	0.87	7.5	2.2	2.2
EY2160L-4	15	1460	29.63	90.6	0.87	7.5	2.2	2.2
EY2180M-4	18.5	1470	34.3	91.2	0.86	7.5	2.2	2.3
EY2180L-4	22	1470	40.6	91.6	0.86	7.5	2.2	2.3
EY2200L-4	30	1470	54.7	92.3	0.86	7.2	2.2	2.3
EY2225S-4	37	1480	66.4	92.7	0.87	7.2	2.2	2.3
EY2225M-4	45	1480	80.5	93.1	0.87	7.2	2.2	2.3
EY2250M1-4	55	1480	98.1	93.5	0.87	7.2	2.2	2.3
EY2280S1-4	75	1480	132.7	94.0	0.87	7.2	2.2	2.3
EY2280M1-4	90	1480	158.5	94.2	0.87	7.2	2.2	2.3
EY2315S1-4	110	1490	191	94.5	0.88	6.9	2.1	2.2
EY2315M1-4	132	1490	228.4	94.7	0.88	6.9	2.1	2.2
EY2315L1-4	160	1490	273	94.9	0.89	6.9	2.1	2.2
EY2315L2-4	200	1490	334.4	95.1	0.89	6.9	2.1	2.2
EY2355M1-4	250	1490	420.7	95.1	0.9	6.9	2.1	2.2
EY2355L1-4	315	1490	528.4	95.1	0.9	6.9	2.1	2.2
Synchronous Speed 1000r/min 50Hz								
EY ₂ 90S-6	0.75	910	2.2	75.9	0.72	5.50	2.00	2.10
EY ₂ 90L-6	1.1	910	3.0	78.1	0.73	5.50	2.00	2.10
EY ₂ 100L-6	1.5	920	3.8	79.8	0.75	5.50	2.00	2.10
EY ₂ 112M-6	2.2	940	5.3	81.8	0.76	6.50	2.00	2.10
EY ₂ 132S-6	3	960	7.0	83.3	0.76	6.50	2.10	2.10
EY ₂ 132M1-6	4	960	9.3	84.6	0.76	6.50	2.10	2.10
EY ₂ 132M2-6	5.5	960	12.3	86.0	0.77	6.50	2.10	2.10
EY ₂ 160M-6	7.5	970	16.4	87.2	0.77	6.50	2.00	2.10
EY ₂ 160L-6	11	970	23.3	88.7	0.78	6.50	2.00	2.10
EY ₂ 180L-6	15	970	30.0	89.7	0.81	7.00	2.00	2.10
EY ₂ 200L1-6	18.5	970	36.6	90.4	0.81	7.00	2.10	2.10
EY ₂ 200L2-6	22	970	42.5	90.9	0.83	7.00	2.10	2.10
EY ₂ 225M-6	30	980	56.3	91.7	0.84	7.00	2.00	2.10
EY ₂ 250M1-6	37	980	67.5	92.2	0.86	7	2.1	2.1
EY ₂ 280S1-6	45	980	81.7	92.7	0.86	7	2.1	2
EY ₂ 280M1-6	55	980	99.5	93.1	0.86	7	2.1	2
EY ₂ 315S1-6	75	990	134.6	93.7	0.86	7	2	2
EY ₂ 315M1-6	90	990	161.1	94.0	0.86	7	2	2
EY ₂ 315L1-6	110	990	196.1	94.3	0.86	6.7	2	2
EY ₂ 315L2-6	132	990	232.5	94.6	0.87	6.7	2	2
EY ₂ 355M1-6	160	990	227.7	94.8	0.88	6.7	1.9	2
EY ₂ 355M2-6	200	990	346.4	95.0	0.88	6.7	1.9	2
EY ₂ 355L1-6	250	990	432.1	95.0	0.88	6.7	1.9	2

IMB3

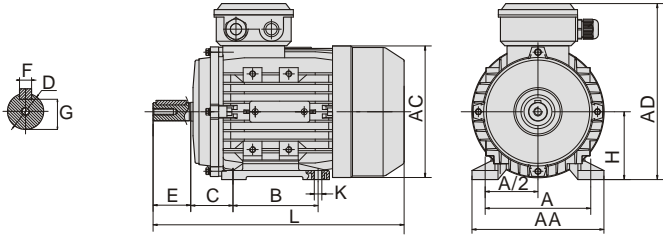

IMB5

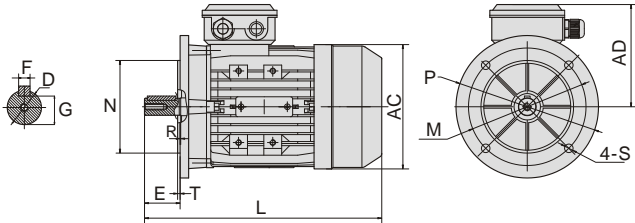

IMB14

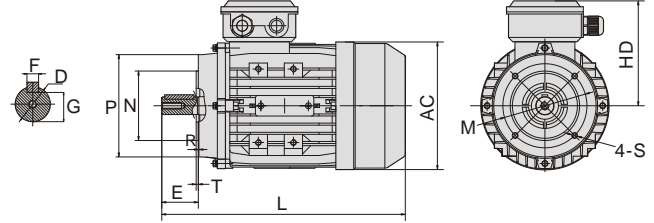

B3 OVERALL & INSTALLATION DIMENSION

Frame	Poles	H	A	A/2	B	C	D	E	F	G	K	AA	AD	AC	L
56	2, 4, 6, 8	56	90	45	71	36	φ 9	20	3	7.2	5.8X5.8	110	156/151	φ 120	195
63	2, 4, 6, 8	63	100	50	80	40	φ 11	23	4	8.5	7X10	120	173/165	φ 130	230
71**	2, 4, 6, 8	71	112	56	90	45	φ 14	30	5	11	7X10	132	188/180	φ 145	260
80	2, 4, 6, 8	80	125	62.5	100	50	φ 19	40	6	15.5	10X13	160	217	φ 165	295
90S	2, 4, 6, 8	90	140	70	100	56	φ 24	50	8	20	10X13	175	235	φ 185	335
90L1/L2	2, 4, 6, 8	90	140	70	125	56	φ 24	50	8	20	10X13	175	235	φ 185	365
100**	2, 4, 6, 8	100	160	80	140	63	φ 28	60	8	24	12X16	196	252	φ 205	400
112	2, 4, 6, 8	112	190	95	140	70	φ 28	60	8	24	12X16	220	292	φ 230	400
132S	2, 4, 6, 8	132	216	108	140	89	φ 38	80	10	33	12X16	252	325	φ 270	480
132M/L	2, 4, 6, 8	132	216	108	178	89	φ 38	80	10	33	12X16	252	325	φ 270	510/535
160M/L	2, 4, 6, 8	160	254	127	210/254	108	φ 42	110	12	37	15X19	290	390	φ 320	640
180M	2, 4, 6, 8	180	279	140	241	121	φ 48	110	14	42.5	15	355	455	φ 360	670
180L	2, 4, 6, 8	180	279	140	279	121	φ 48	110	14	42.5	15	355	455	φ 360	710
200L	2, 4, 6, 8	200	318	159	305	133	φ 55	110	16	49	19	375	505	φ 400	775
225S	4, 8	225	356	178	286	149	φ 60	140	18	53	19	435	560	φ 470	815
225M	2	225	356	178	311	149	φ 55	110	16	49	19	435	560	φ 470	820
225M	4, 6, 8	225	356	178	311	149	φ 60	140	18	53	19	435	560	φ 470	845
250M	2	250	406	203	349	168	φ 60	140	18	53	24	490	615	φ 510	910
250M	4, 6, 8	250	406	203	349	168	φ 65	140	18	58	24	490	615	φ 510	910
280S	2	280	457	228.5	368	190	φ 65	140	18	58	24	550	680	φ 580	985
280S	4, 6, 8	280	457	228.5	368	190	φ 75	140	20	67.5	24	550	680	φ 580	985
280M	2	280	457	228.5	419	190	φ 65	140	18	58	24	550	680	φ 580	1035
280M	4, 6, 8	280	457	228.5	419	190	φ 75	140	20	67.5	24	550	680	φ 580	1035
315S	2	315	508	254	406	216	φ 65	140	18	58	28	635	845	φ 645	1185
315S	4, 6, 8	315	508	254	406	216	φ 80	170	22	71	28	635	845	φ 645	1215
315M	2	315	508	254	457	216	φ 65	140	18	58	28	635	845	φ 645	1295
315M	4, 6, 8	315	508	254	457	216	φ 80	170	22	71	28	635	845	φ 645	1325
315L	2	315	508	254	508	216	φ 65	140	18	58	28	635	845	φ 645	1295
315L	4, 6, 8	315	508	254	508	216	φ 80	170	22	71	28	635	845	φ 645	1325
355M	2	355	610	305	560	254	φ 75	140	20	67.5	28	730	1010	φ 710	1500
355M	4, 6, 8	355	610	305	560	254	φ 95	170	25	86	28	730	1010	φ 710	1530
355L	2	355	610	305	630	254	φ 75	140	20	67.5	28	730	1010	φ 710	1500
355L	4, 6, 8	355	610	305	630	254	φ 95	170	25	86	28	730	1010	φ 710	1530

B5 OVERALL & INSTALLATION DIMENSION

Frame	Poles	M	N	P	T	S	D	E	F	G	AC	AD	L
56	2, 4, 6, 8	φ 98	φ 80	φ 120	3.0	φ 7	φ 9	20	3	7.2	φ 120	100/95	195
63	2, 4, 6, 8	φ 115	φ 95	φ 140	3.0	φ 10	φ 11	23	4	8.5	φ 130	110/102	230
71**	2, 4, 6, 8	φ 130	φ 110	φ 160	3.5	φ 10	φ 14	30	5	11	φ 145	117/109	260
80	2, 4, 6, 8	φ 165	φ 130	φ 200	3.5	φ 12	φ 19	40	6	15.5	φ 165	137	295
90S	2, 4, 6, 8	φ 165	φ 130	φ 200	3.5	φ 12	φ 24	50	8	20	φ 185	145	335
90L1/L2	2, 4, 6, 8	φ 165	φ 130	φ 200	3.5	φ 12	φ 24	50	8	20	φ 185	145	365
100**	2, 4, 6, 8	φ 215	φ 180	φ 250	4.0	φ 15	φ 28	60	8	24	φ 205	152	400
112	2, 4, 6, 8	φ 215	φ 180	φ 250	4.0	φ 15	φ 28	60	8	24	φ 230	180	400
132S	2, 4, 6, 8	φ 265	φ 230	φ 300	4.0	φ 15	φ 38	80	10	33	φ 270	193	480
132M/L	2, 4, 6, 8	φ 265	φ 230	φ 300	4.0	φ 15	φ 38	80	10	33	φ 270	193	510/535
160M/L	2, 4, 6, 8	φ 300	φ 250	φ 350	5.0	φ 19	φ 42	110	12	37	φ 320	230	640
180M	2, 4, 6, 8	φ 300	φ 250	φ 350	5.0	φ 19	φ 48	110	14	42.5	φ 380	180	670
180L	2, 4, 6, 8	φ 350	φ 300	φ 400	5.0	φ 19	φ 55	110	16	49	φ 420	180	710
200L	2, 4, 6, 8	φ 350	φ 300	φ 400	5.0	φ 19	φ 55	110	16	49	φ 400	280	775
225S	4, 8	φ 400	φ 350	φ 450	5.0	φ 19	φ 60	140	18	53	φ 470	305	815
225M	2	φ 400	φ 350	φ 450	5.0	φ 19	φ 55	110	16	49	φ 470	335	820
225M	4, 6, 8	φ 400	φ 350	φ 450	5.0	φ 19	φ 60	140	18	53	φ 470	335	845
250M	2	φ 500	φ 450	φ 550	5.0	φ 19	φ 60	140	18	53	φ 510	370	910
250M	4, 6, 8	φ 500	φ 450	φ 550	5.0	φ 19	φ 65	140	18	58	φ 510	370	910
280S	2	φ 500	φ 450	φ 550	5.0	φ 19	φ 65	140	18	58	φ 580	410	985
280S	4, 6, 8	φ 500	φ 450	φ 550	5.0	φ 19	φ 75	140	20	67.5	φ 580	410	985
280M	2	φ 500	φ 450	φ 550	5.0	φ 19	φ 65	140	18	58	φ 580	410	1035
280M	4, 6, 8	φ 500	φ 450	φ 550	5.0	φ 19	φ 75	140	20	67.5	φ 580	410	1035

**This frame size has two housing size, the rated output is for normal "L" size, and increased output is for the bigger "L" size (refer to the figures in the bracket "()")

B14 OVERALL & INSTALLATION DIMENSION

Frame	B14						B14B						D	E	F	G	KK	AC	HD	L
	N	M	P	T	S	R	N	M	P	T	S	R								
56	φ 50	φ 65	φ 80	2.5	M5	0							φ 9	20	3	7.2	1-M16X1.5	φ 120	100/95	195
63	φ 60	φ 75	φ 90	2.5	M5	0	φ 80	φ 100	φ 120	3.0	M6		φ 11	23	4	8.5	1-M16X1.5	φ 130	110/102	230
71**	φ 70	φ 85	φ 105	2.5	M6	0	φ 95	φ 115	φ 140	3.0	M8	φ 0	φ 14	30	5	11	1-M20X1.5	φ 145	117/109	260
80	φ 80	φ 100	φ 120	3.0	M6	0	φ 110	φ 130	φ 160	3.5	M8	φ 0	φ 19	40	6	15.5	1-M20X1.5	φ 165	137	295
90S	φ 95	φ 115	φ 140	3.0	M8	0	φ 110	φ 130	φ 160	3.5	M8	φ 0	φ 24	50	8	20	1-M20X1.5	φ 185	145	335
90L1/L2	φ 95	φ 115	φ 140	3.0	M8	0	φ 110	φ 130	φ 160	3.5	M8	φ 0	φ 24	50	8	20	1-M20X1.5	φ 185	145	365
100**	φ 110	φ 130	φ 160	3.5	M8	0	φ 130	φ 165	φ 200	3.5	M10	φ 0	φ 28	60	8	24	1-M20X1.5	φ 205	152	400
112	φ 110	φ 130	φ 160	3.5	M8	0	φ 130	φ 165	φ 200	3.5	M10	φ 0	φ 28	60	8	24	2-M25X1.5	φ 230	180	400
132S	φ 130	φ 165	φ 200	3.5	M10	0	φ 180	φ 215	φ 250	4.0	M12	φ 0	φ 38	80	10	33	2-M25X1.5	φ 270	193	480
132M/L	φ 130	φ 165	φ 200	3.5	M10	0	φ 180	φ 215	φ 250	4.0	M12	φ 0	φ 38	80	10	33	2-M25X1.5	φ 270	193	510/535

IMB35

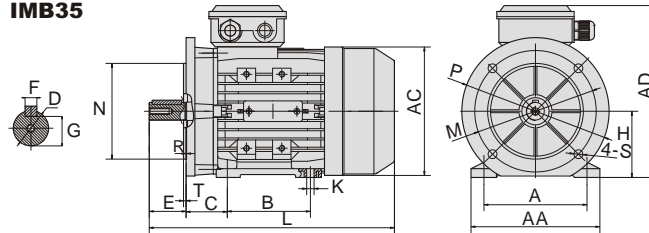

B35 OVERALL & INSTALLATION DIMENSION

Frame	Poles	H	M	N	P	T	S	A	B	C	D	E	F	G
56	2, 4, 6, 8	56	φ 80	φ 98	φ 120	3.0	φ 7	90	71	36	φ 9	20	3	7.2
63	2, 4, 6, 8	63	φ 95	φ 115	φ 140	3.0	φ 10	100	80	40	φ 11	23	4	8.5
71**	2, 4, 6, 8	71	φ 110	φ 130	φ 160	3.5	φ 10	112	90	45	φ 14	30	5	11
80	2, 4, 6, 8	80	φ 130	φ 165	φ 200	3.5	φ 12	125	100	50	φ 19	40	6	15.5
90S	2, 4, 6, 8	90	φ 130	φ 165	φ 200	3.5	φ 12	140	100	56	φ 24	50	8	20
90L1/L2	2, 4, 6, 8	90	φ 130	φ 165	φ 200	3.5	φ 12	140	125	56	φ 24	50	8	20
100**	2, 4, 6, 8	100	φ 180	φ 215	φ 250	4.0	φ 15	160	140	63	φ 28	60	8	24
112	2, 4, 6, 8	112	φ 180	φ 215	φ 250	4.0	φ 15	190	140	70	φ 28	60	8	24
132S	2, 4, 6, 8	132	φ 230	φ 265	φ 300	4.0	φ 15	216	140	89	φ 38	80	10	33
132M/L	2, 4, 6, 8	132	φ 230	φ 265	φ 300	4.0	φ 15	216	178	89	φ 38	80	10	33
160M/L	2, 4, 6, 8	160	φ 250	φ 300	φ 350	5.0	φ 19	254	210/254	108	φ 42	110	12	37
180M	2, 4, 6, 8	180	φ 300	φ 250	φ 350	5.0	φ 19	279	241	121	φ 48	110	14	42.5
180L	2, 4, 6, 8	180	φ 300	φ 250	φ 350	5.0	φ 19	279	279	121	φ 48	110	14	42.5
200L	2, 4, 6, 8	200	φ 350	φ 300	φ 400	5.0	φ 19	318/	305	133	φ 55	110	16	49
225S	4, 8	225	φ 400	φ 350	φ 450	5.0	φ 19	356	286	149	φ 60	140	18	53
225M	2	225	φ 400	φ 350	φ 450	5.0	φ 19	356	311	149	φ 55	110	16	49
225M	4, 6, 8	225	φ 400	φ 350	φ 450	5.0	φ 19	356	311	149	φ 60	140	18	53
250M	2	250	φ 500	φ 450	φ 550	5.0	φ 19	406	349	168	φ 60	140	18	49
250M	4, 6, 8	250	φ 500	φ 450	φ 550	5.0	φ 19	406	349	168	φ 65	140	18	58
280S	2	280	φ 500	φ 450	φ 550	5.0	φ 19	457	368	190	φ 65	140	18	58
280S	4, 6, 8	280	φ 500	φ 450	φ 550	5.0	φ 19	457	368	190	φ 75	140	20	68
280M	2	280	φ 500	φ 450	φ 550	5.0	φ 19	457	419	190	φ 65	140	18	58
280M	4, 6, 8	280	φ 500	φ 450	φ 550	5.0	φ 19	457	419	190	φ 75	140	20	68
315S	2	315	φ 600	φ 550	φ 660	6.0	φ 24	508	406	216	φ 65	140	18	58
315S	4, 6, 8	315	φ 600	φ 550	φ 660	6.0	φ 24	508	406	216	φ 80	170	22	71
315M	2	315	φ 600	φ 550	φ 660	6.0	φ 24	508	457	216	φ 65	140	18	58
315M	4, 6, 8	315	φ 600	φ 550	φ 660	6.0	φ 24	508	457	216	φ 80	170	22	71
315L	2	315	φ 600	φ 550	φ 660	6.0	φ 24	508	508	216	φ 65	140	18	58
315L	4, 6, 8	315	φ 600	φ 550	φ 660	6.0	φ 24	508	508	216	φ 80	170	22	71
355M	2	355	φ 740	φ 680	φ 800	6.0	φ 24	610	560	254	φ 75	140	20	68
355M	4, 6, 8	355	φ 740	φ 680	φ 800	6.0	φ 24	610	560	254	φ 95	170	25	86
355L	2	355	φ 740	φ 680	φ 800	6.0	φ 24	610	630	254	φ 75	140	20	68
355L	4, 6, 8	355	φ 740	φ 680	φ 800	6.0	φ 24	610	630	254	φ 95	170	25	86

Frame	Poles	K	AA	AD	AC	L
56	2, 4, 6, 8	5.8X5.8	110	156/151	φ 120	195
63	2, 4, 6, 8	7X10	120	173/165	φ 130	230
71**	2, 4, 6, 8	7X10	132	188/180	φ 145	260
80	2, 4, 6, 8	10X13	160	217	φ 165	295
90S	2, 4, 6, 8	10X13	175	235	φ 185	335
90L1/L2	2, 4, 6, 8	10X13	175	235	φ 185	365
100**	2, 4, 6, 8	10X13	196	252	φ 205	400
112	2, 4, 6, 8	12X16	220	292	φ 230	400
132S	2, 4, 6, 8	12X16	252	325	φ 270	480
132M/L	2, 4, 6, 8	12X16	252	325	φ 270	510/535
160M/L	2, 4, 6, 8	15X19	290	290	φ 320	640
180M	2, 4, 6, 8	φ 15	355	455	φ 360	670
180L	2, 4, 6, 8	φ 15	355	455	φ 360	710
200L	2, 4, 6, 8	φ 19	375	505	φ 400	775
225S	4, 8	φ 19	435	560	φ 470	815
225M	2	φ 19	435	560	φ 470	820
225M	4, 6, 8	φ 19	435	560	φ 470	845
250M	2	φ 24	490	615	φ 510	910
250M	4, 6, 8	φ 24	490	615	φ 510	910
280S	2	φ 24	550	680	φ 580	985
280S	4, 6, 8	φ 24	550	680	φ 580	985
280M	2	φ 24	550	680	φ 580	1035
280M	4, 6, 8	φ 24	550	680	φ 580	1035
315S	2	φ 28	635	845	φ 645	1185
315S	4, 6, 8	φ 28	635	845	φ 645	1215
315M	2	φ 28	635	845	φ 645	1295
315M	4, 6, 8	φ 28	635	845	φ 645	1325
315L	2	φ 28	635	845	φ 645	1295
315L	4, 6, 8	φ 28	635	845	φ 645	1325
355M	2	φ 28	730	1010	φ 710	1500
355M	4, 6, 8	φ 28	730	1010	φ 710	1530
355L	2	φ 28	730	1010	φ 710	1500
355L	4, 6, 8	φ 28	730	1010	φ 710	1530