



# SMARTSPACE

Industrial IoT at enterprise scale



Maximise  
**PRODUCTIVITY**



Improve  
**QUALITY**

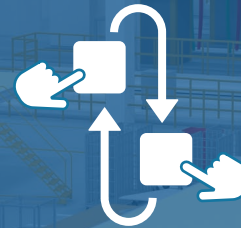

Increase  
**FLEXIBILITY**



Embrace  
**COMPLEXITY**

Bridge the data-gap between your business systems and your business process.

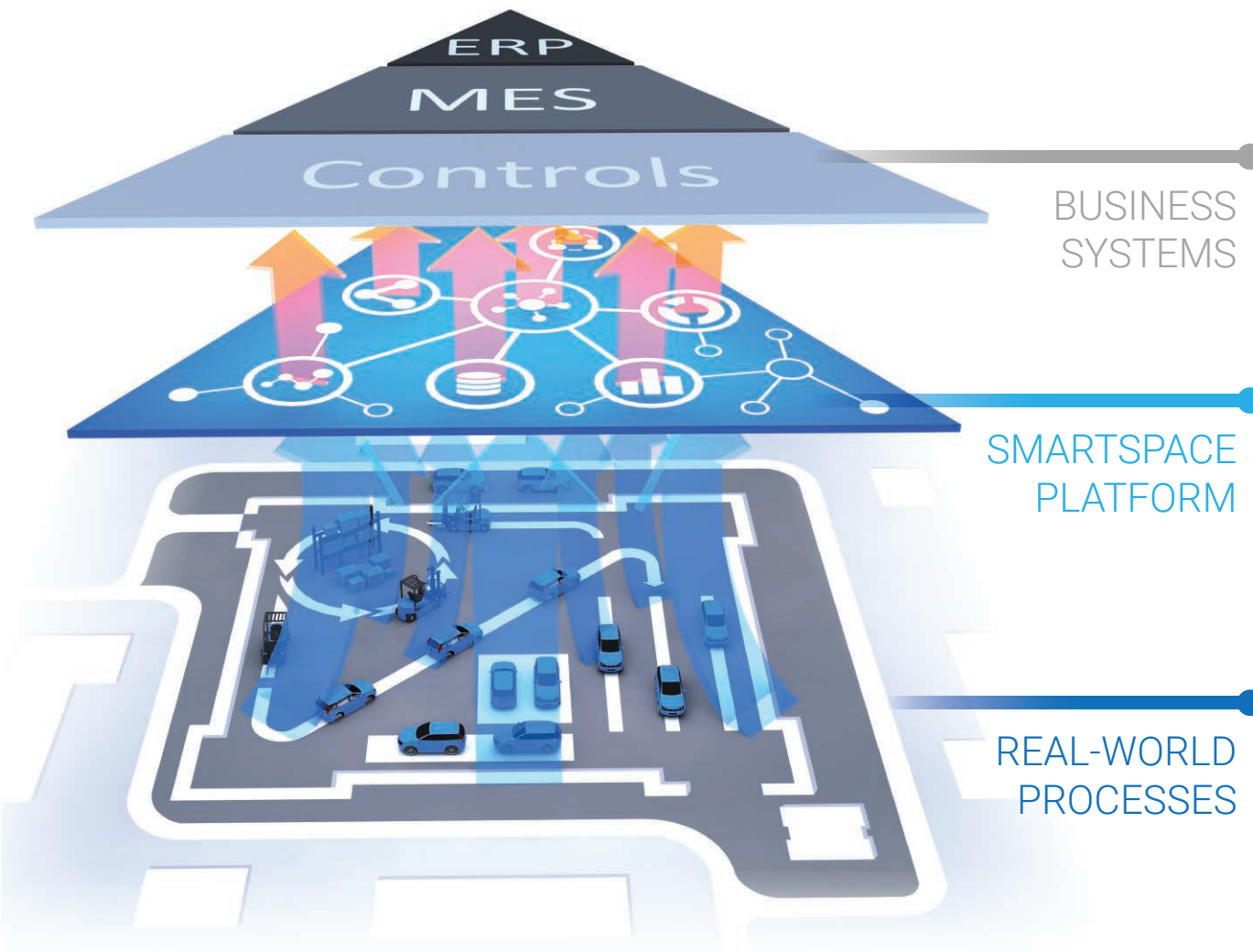

## SmartSpace brings visibility of the physical world

to planning, management and control systems, making **real-world processes** involving moving assets **visible and measurable**.

By **location-enabling the environment** with any number of location and identification technologies, SmartSpace handles the **complexity of location** so existing business systems don't have to. It turns location into **language that the business systems understand**.

# SENSOR INTEGRATION

Sensor-agnostic software platform that allows you to manage multiple sources of location and identification sensing data from a single platform.

Plug and play with everything  
from barcode to RFID to  
RTLS.

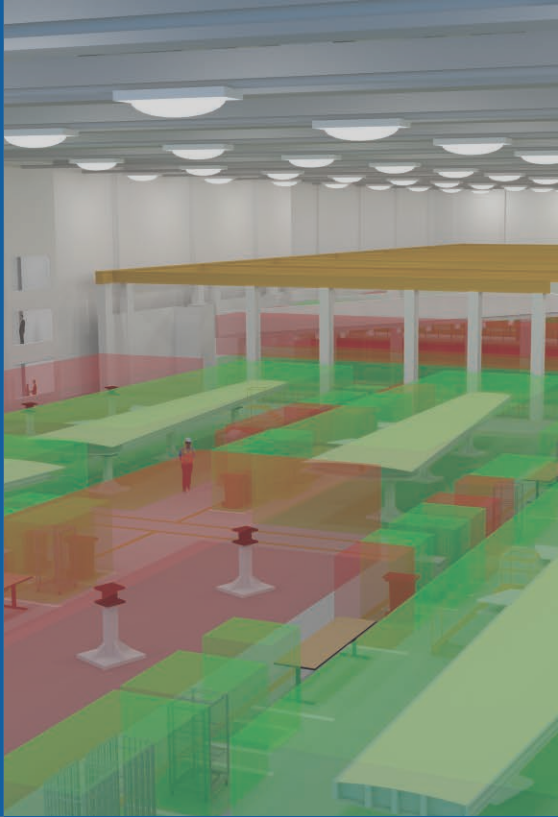

# CONTROL

Use software-defined  
identification at massive  
scale for real-time process  
control anywhere.

Enable workers to work flexibly and seamlessly switch between complex tasks without error.



## SPATIAL MONITORING

Unify location events using spatial monitoring, creating a common language for generating identification events that higher level systems understand.

Spatial events drive real-time rules logic to detect context-relevant events that have happened in the real-world.



## VISIBILITY

Monitoring and audit of complex processes involving moving objects.

## Configurable user-interfaces for maps, forms and reports .

Detect, notify and analyse process exceptions.



# SMARTSPACE SOFTWARE STACK



## SMART APPS

## SMART FACTORY ASSEMBLY

Build location driven assembly lines that adapt process in real-time to context-relevant events from tools, devices and product



## PROCESS MONITOR

Monitor complex flows of products and objects for real-time insight into process conformance and KPIs



## PROCESS IMPROVEMENT

Uncover hidden inefficiencies in production processes that involve the movement and flow of product and assets



## SMART DEVELOPER

## RULES ENGINE DEVELOPER

Develop custom business logic using a drag and drop interface for application specific context-relevant events and application behaviour

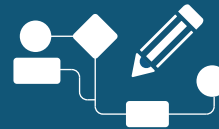

## REPORTS ENGINE DEVELOPER

Develop custom reports using a drag and drop editor for application-specific consumption of process data



## SMART WORKERS

### LOCATION RULES

Make location conform to real-world constraints



### BUSINESS RULES

Make location context-relevant with logic



### VISIBILITY

Configurable graphical interfaces for people to see processes



### REPORTING

Persistent storage and graphical reporting of process data



### APPS INTEGRATION

Integration with the business ecosystem



### CONTROLS INTEGRATION

Control industrial systems with real-time protocols



### RFID INTEGRATION

Integration with passive identification technologies



### RTLS INTEGRATION

Integration with 3rd party RTLS



### ADVANCED IT

Tools and interfaces for operational support and monitoring



## CORE

## OBJECTS & SPACES

Build rich object and environment models and describe the interactions between them using spatial relationships



## SENSORS

## LOCATION & IDENTIFICATION

Easily integrate and combine a broad array of location and identification sensing technologies

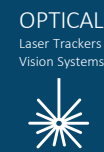

SmartSpace uses location and identification to create visibility of real-world objects and their interactions, enabling complex manufacturing processes with high levels of variability to be more flexible, easier to manage and easier to control.



**SmartSpace enables higher productivity, increased quality and reduced costs through:**

- More flexible assembly processes
- Context-aware error-proofing
- Reduced lead-time on finished product
- Reduction in waste from over-processing
- Reduction in WIP-inventory costs
- Reduced capital expenditure
- Reduction in necessary floor space
- Reduced payroll and overtime



#### **SENSOR-INDEPENDENT**

- Use any location or identification source to create new levels of visibility and control
- Combine different sensing modalities into a single unified architecture



#### **ENTERPRISE SCALABILITY**

- Designed to be massively scalable from the ground up through a cellular service architecture
- Support arbitrarily large installations with guaranteed real-time performance



#### **MISSION-CRITICAL RELIABILITY**

- Designed to filter and optimise location data in a way that generates accurate and reliable process-critical events
- Scalability, failover and redundancy are built deep into the core architecture



#### **INDUSTRIALLY-PROVEN**

- Deployed at very large scale in some of the harshest industrial environments
- Mature operational support tools enable mission critical applications with no downtime



<https://ubisense.net/en>



[globalenquiries@ubisense.net](mailto:globalenquiries@ubisense.net)