

"MGE 1000"

The new drive for AGV -
automated guided vehicles

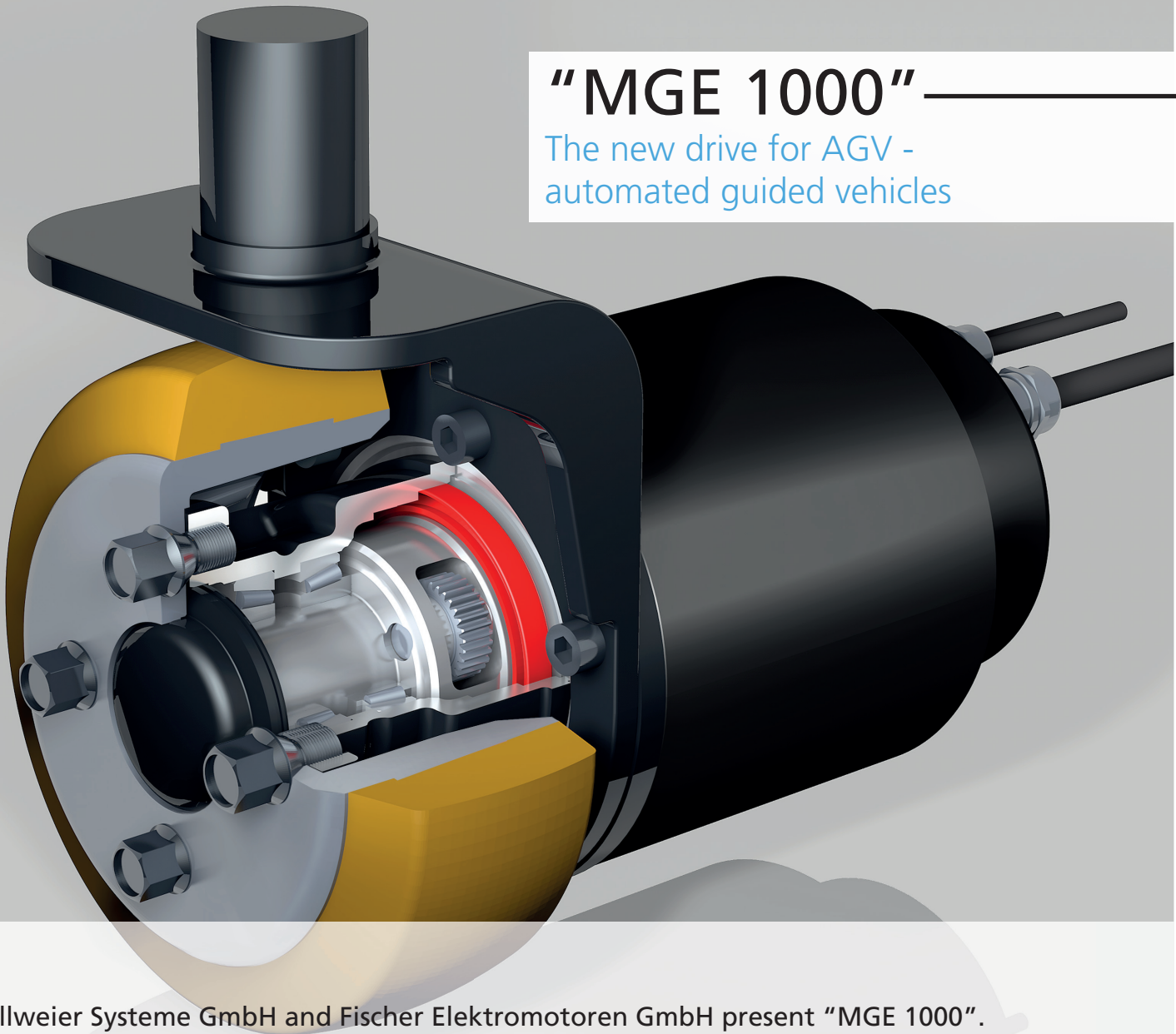

Allweier Systeme GmbH and Fischer Elektromotoren GmbH present "MGE 1000".
A powerful motorised gear unit of 1000 W power and up to 1000 kg radial load.

The advantage at a glance

- Compact and modular design
- Powerful
- Precise
- Efficient
- Modular design
- Optionally with brake and encoder
- Inclusive rim and wheel

Technical specifications "MGE 1000"

	i = 16	i = 24	i = 42
Motor data			
Nominal power	1 kW		
Max. motor speed	4 500 1/min		
Nom. motor torque	1,6 Nm		
Acceleration torque	6,2 Nm		
Peak torque	8,4 Nm		
Voltage	24 - 60 VDC		

Power at wheel			
Max. speed	3,3 m/s (12/km/h)	2,2 m/s (8 km/h)	1,2 m/s (4,3 km/h)
Nom. torque	25 Nm	38 Nm	67 Nm
Acceleration torque	100 Nm	149 Nm	260 Nm
Peak torque	135 Nm	202 Nm	353 Nm
Radial load	1000 Nm	1000 Nm	1000 Nm

On the basis of high-performance gear we developed high-efficiency powertrains for the needs of automated guided vehicles. It's compact design including rim and wheel open new possibilities of your vehicles.

MGE 1000 is modular built and can be set up with brake, encoder, and AC Motor Controller.

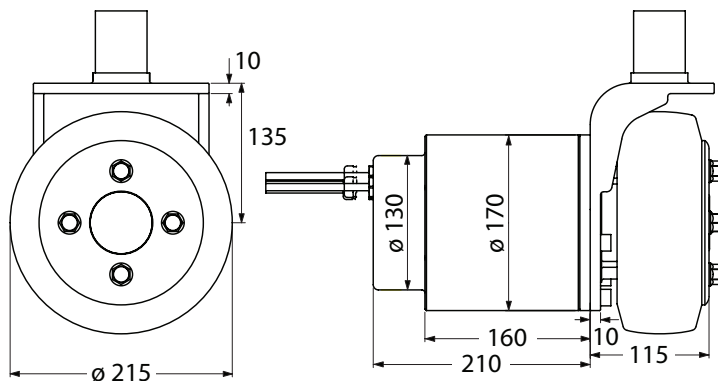

Fischer Elektromotoren GmbH
 Schützenstraße 19
 D-74842 Billigheim-Allfeld

Tel.: +49 6265 9222-0
 Fax: +49 6265 9222-22

info@fischer-elektromotoren.de
www.fischer-elektromotoren.de



ASG Allweier Systeme GmbH
 Zum Degenhardt 3
 D-88662 Überlingen

Tel.: +49 7551 9207-0
 Fax: +49 7551 9207-55

info@radnabengetriebe.de
www.radnabengetriebe.de