

MXL TYPE(mm) 节距 (Pitch) =2.032mm

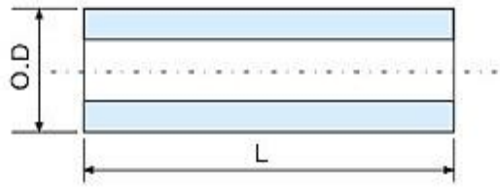

表示方法(Representation method):



No. of Grooves	P. D	O. D	Code Symbol	L
10	6.47	5.96	10MXL100	10-100
11	7.11	6.61	11MXL100	
12	7.76	7.25	12MXL100	
13	8.41	7.9	13MXL100	
14	9.06	8.55	14MXL100	
15	9.7	9.19	15MXL100	
16	10.35	9.84	16MXL100	
17	11	10.49	17MXL100	
18	11.64	11.14	18MXL100	
19	12.29	11.78	19MXL100	
20	12.94	12.43	20MXL100	
21	13.58	13.08	21MXL100	
22	14.23	13.72	22MXL100	
23	14.88	14.37	23MXL100	
24	15.52	15.02	24MXL100	
25	16.17	15.66	25MXL100	
26	16.82	16.31	26MXL100	
27	17.46	16.96	27MXL100	
28	18.11	17.6	28MXL100	
30	19.4	18.9	30MXL100	
32	20.7	20.19	32MXL100	
36	23.29	22.78	36MXL100	
40	25.87	25.36	40MXL100	
44	28.46	27.95	44MXL100	
48	31.05	30.54	48MXL100	
50	32.34	31.83	50MXL100	
60	38.81	38.3	60MXL100	
70	45.28	44.77	70MXL100	
72	46.57	46.06	72MXL100	
80	51.74	51.24	80MXL100	
84	54.33	53.82	84MXL100	
96	62.09	61.59	96MXL100	
100	64.68	64.17	100MXL100	
120	77.62	77.11	120MXL100	

MXL型齿形图(Tooth form diagram):

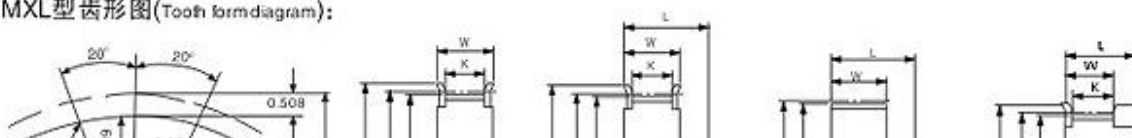

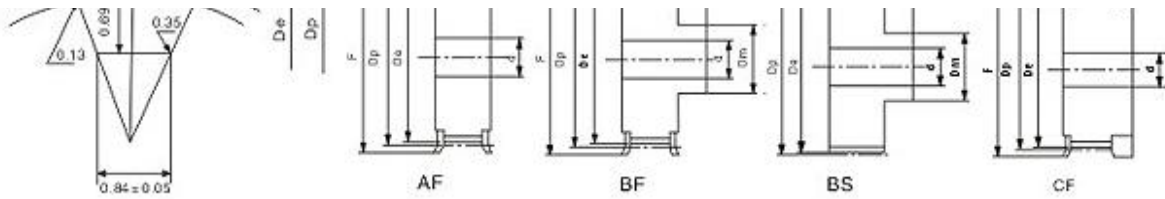

item	no. of grooves	type	P. D	O. D	W	L	1K	X
20MXL	20	C/A	12.94	12.43	11	16	7	-
21MXL	21	C/A	13.58	13.08	11	16	7	-
22MXL	22	C/A	14.23	13.72	11	16	7	-
23MXL	23	C/A	14.88	14.37	11	16	7	-
24MXL	24	C/A	15.52	15.02	11	16	7	-
25MXL	25	C/A	16.17	15.66	11	16	7	-
26MXL	26	C/A	16.82	16.31	11	16	7	-
27MXL	27	C/A	17.46	16.96	11	16	7	-
28MXL	28	C/A	18.11	17.6	11	16	7	-
30MXL	30	A/B	19.4	18.9	11	16	7	-
32MXL	32	A/B	20.7	20.19	11	16	7	-
36MXL	36	A/B	23.29	22.78	11	16	7	-
40MXL	40	A/B	25.87	25.36	11	18	7	-
48MXL	48	A/B	31.05	30.54	11	18	7	-
60MXL	60	A/B	38.81	38.3	11	18	7	-
72MXL	72	A/B	46.57	46.06	11	18	7	-
84MXL	84	A/B	54.33	53.82	11	18	7	-
96MXL	96	A/B	62.09	61.59	11	18	7	-
120MXL	120	A/B	77.62	77.11	11	18	7	-

XL型齿形图:  
Tooth form diagram

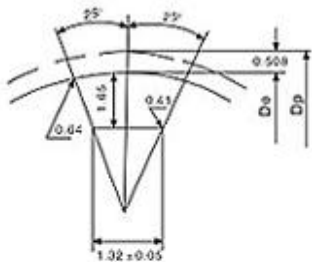

表示方法:  
Representation method

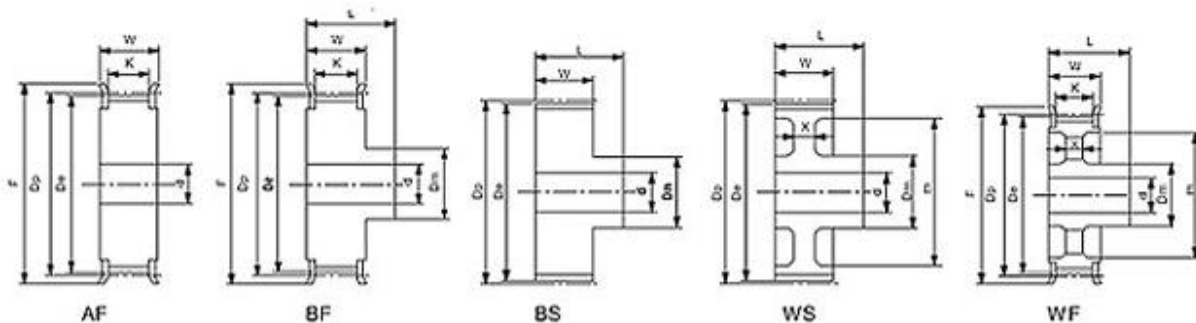
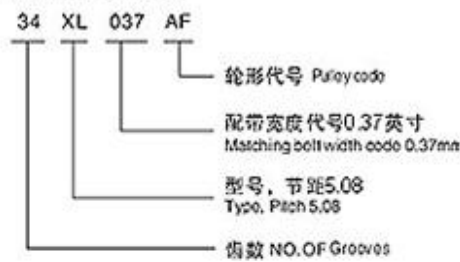

XL-std belt width037 (9.5mm)								
item	no. of grooves	type	P. D	O. D	W	L	1K	X
10XL	10	A\B	16.17	15.66	15	23	11	-
11XL	11	A\B	17.79	17.28	15	23	11	-
12XL	12	A\B	19.4	18.9	15	23	11	-
14XL	14	A\B	22.64	22.13	15	23	11	-
15XL	15	A\B	24.26	23.75	15	23	11	-
16XL	16	A\B	25.87	25.36	15	23	11	-
18XL	18	A\B	29.11	28.6	15	23	11	-
19XL	19	A\B	30.72	30.22	15	23	11	-
20XL	20	A\B	32.34	31.83	15	23	11	-
21XL	21	A\B	33.96	33.45	15	23	11	-
22XL	22	A\B	35.57	35.07	15	23	11	-
24XL	24	A\B	38.81	38.3	15	23	11	-
25XL	25	A\B	40.43	39.92	15	23	11	-
26XL	26	A\B	42.04	41.53	15	23	11	-
28XL	28	A\B	45.28	44.77	15	23	11	-
30XL	30	A\B	48.51	48	15	23	11	-
32XL	32	A\B	51.74	51.24	16	23	11	-
34XL	34	A\B	54.98	54.47	16	23	11	-
36XL	36	A\B	58.21	57.7	16	25	11	-
38XL	38	A\B	61.45	60.94	16	25	11	-
40XL	40	A\B	64.68	64.17	16	25	11	-
42XL	42	A\B	67.91	67.41	16	25	11	-
44XL	44	A\B	71.15	70.64	16	25	11	5
45XL	45	W	72.77	72.26	16	25	11	5
48XL	48	W	77.62	77.11	16	25	11	5
50XL	50	W	80.85	83.58	16	25	11	5
57XL	57	W	90.55	91.66	16	25	11	5
60XL	60	W	97.02	96.51	16	25	11	5
70XL	70	W	113.19	112.68	16	25	11	5
72XL	72	W	116.43	115.92	16	25	11	5

L型齿形图:  
Tooth form diagram

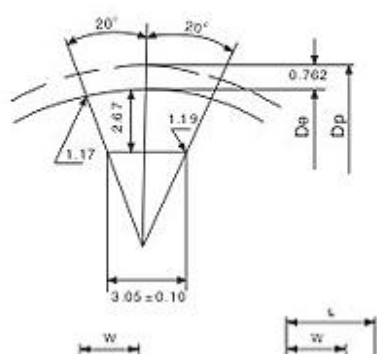

表示方法:  
Representation method

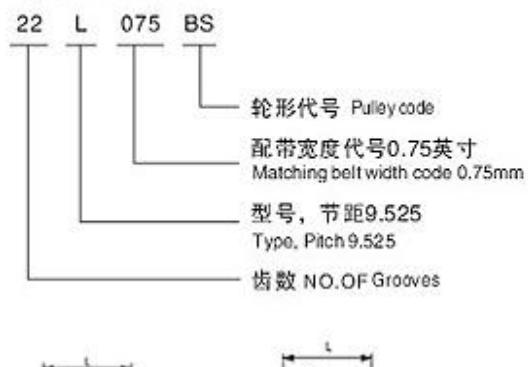

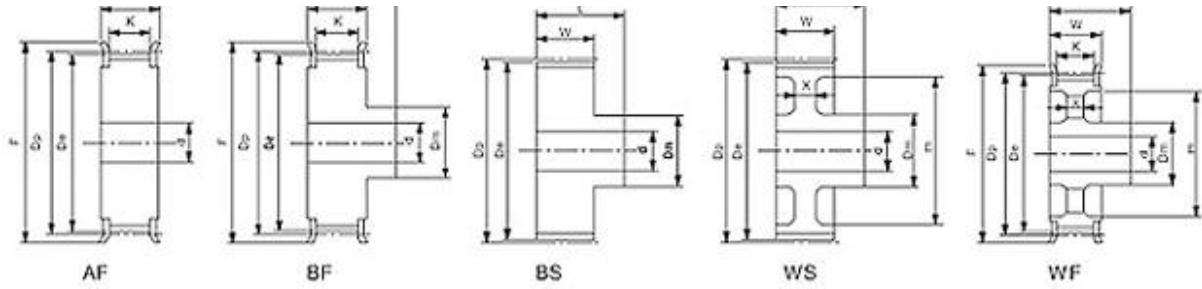

L-std belt width075 (19.1mm)

item	no. of grooves	type	P. D	O. D	W	L	1K	X
10L	10	A\B	30.32	29.56	26	38	21	-
12L	12	A\B	36.38	35.62	26	38	21	-
14L	14	A\B	42.45	41.68	26	38	21	-
15L	15	A\B	45.48	44.72	26	38	21	-
16L	16	A\B	48.51	47.75	26	38	21	-
17L	17	A\B	51.54	50.78	26	38	21	-
18L	18	A\B	54.57	53.81	26	38	21	-
19L	19	A\B	57.61	56.84	26	38	21	-
20L	20	A\B	60.64	59.88	26	38	21	-
21L	21	A\B	63.67	62.91	26	38	21	-
22L	22	A\B	66.7	65.94	26	38	21	-
24L	24	A\B	72.77	72	26	38	21	-
25L	25	A\B	75.8	75.04	26	38	21	-
26L	26	A\B	78.83	78.07	26	38	21	-
28L	28	A\B	84.89	84.13	26	38	21	-
30L	30	A\B	90.96	90.2	26	38	21	-
32L	32	A\B	97.02	96.26	26	38	21	-
34L	34	A\B	103.08	102.32	26	41	21	-
36L	36	A\B	109.15	108.39	26	41	21	-
38L	38	A\B	115.22	114.45	26	41	21	-
40L	40	A\B	121.28	120.51	26	41	21	-
42L	42	A\B	127.34	126.58	26	41	21	-
44L	44	A\B	133.4	132.64	26	46	21	-
45L	45	W	136.44	135.67	26	46	21	9
48L	48	W	145.53	144.77	26	46	21	9
50L	50	W	151.6	150.83	26	46	21	9
56L	56	W	169.79	169.02	26	46	21	9
60L	60	W	181.91	181.15	26	46	21	9
72L	72	W	218.3	217.53	26	46	21	9
84L	84	W	254.68	253.92	26	46	21	9

H型齿形图:

Tooth form diagram

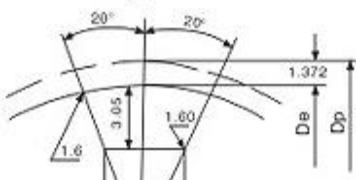

表示方法:

Representation method

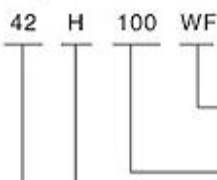

轮形代号 Pulleycode

配带宽度代号1.00英寸

Matching belt width code 1.00inch



Matching belt width code 1.00mm

型号, 节距12.7  
Type, Pitch 12.7

齿数 NO.OF Grooves

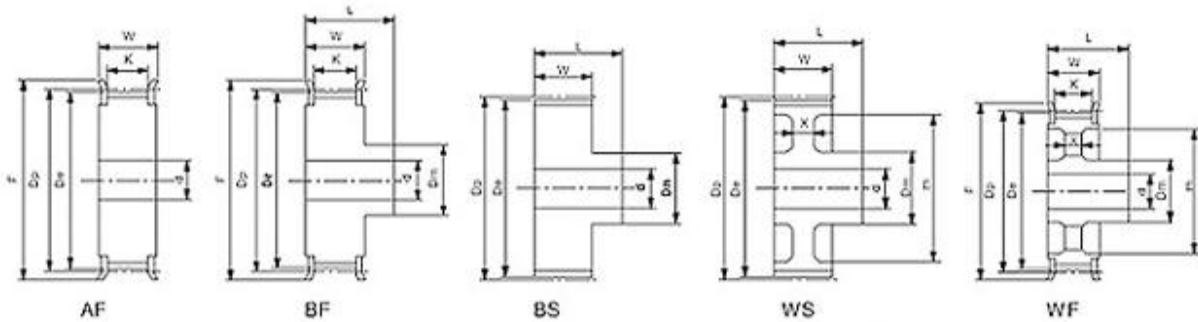

H-std belt width100 (25.4mm)

item	no. of grooves	type	P. D	O. D	W	L	1K	X
14H	14	A\B	56.6	55.22	33	48	28	-
15H	15	A\B	60.64	59.27	33	48	28	-
16H	16	A\B	64.68	63.31	33	48	28	-
18H	18	A\B	72.77	71.39	33	48	28	-
19H	19	A\B	76.81	75.44	33	48	28	-
20H	20	A\B	80.85	79.48	33	48	28	-
21H	21	A\B	84.89	83.52	33	48	28	-
22H	22	A\B	88.94	87.56	33	48	28	-
24H	24	A\B	97.02	96.65	33	48	28	-
25H	25	A\B	101.06	99.69	33	48	28	-
26H	26	A\B	105.11	103.73	33	48	28	-
28H	28	A\B	113.19	111.82	33	48	28	-
30H	30	A\B	121.28	119.9	33	48	28	-
32H	32	A\B	129.3	127.99	33	53	28	-
34H	34	A\B	137.45	136.07	33	53	28	-
36H	36	A\B	145.53	144.16	33	53	28	-
38H	38	A\B	153.62	152.24	33	53	28	-
40H	40	A\B	161.7	160.33	33	53	28	-
42H	42	B\W	169.79	168.41	33	53	28	11
44H	44	B\W	177.87	176.5	33	53	28	11
45H	45	B\W	181.91	180.54	33	53	28	11
48H	48	B\W	194.04	192.67	33	53	28	11
50H	50	B\W	202.13	200.76	33	53	28	11
58H	58	B\W	234.47	233.09	33	53	28	11
60H	60	B\W	242.55	241.18	33	53	28	11
70H	70	B\W	282.98	281.61	33	60	28	11
72H	72	B\W	291.06	289.69	33	60	28	11
84H	84	B\W	339.57	338.2	33	60	28	11
96H	96	B\W	388.08	386.71	33	60	28	11
120H	120	B\W	485.1	483.73	33	60	28	11

XH型齿形图:  
Tooth form diagram

表示方法:  
Representation method  
24 XH 200 WF

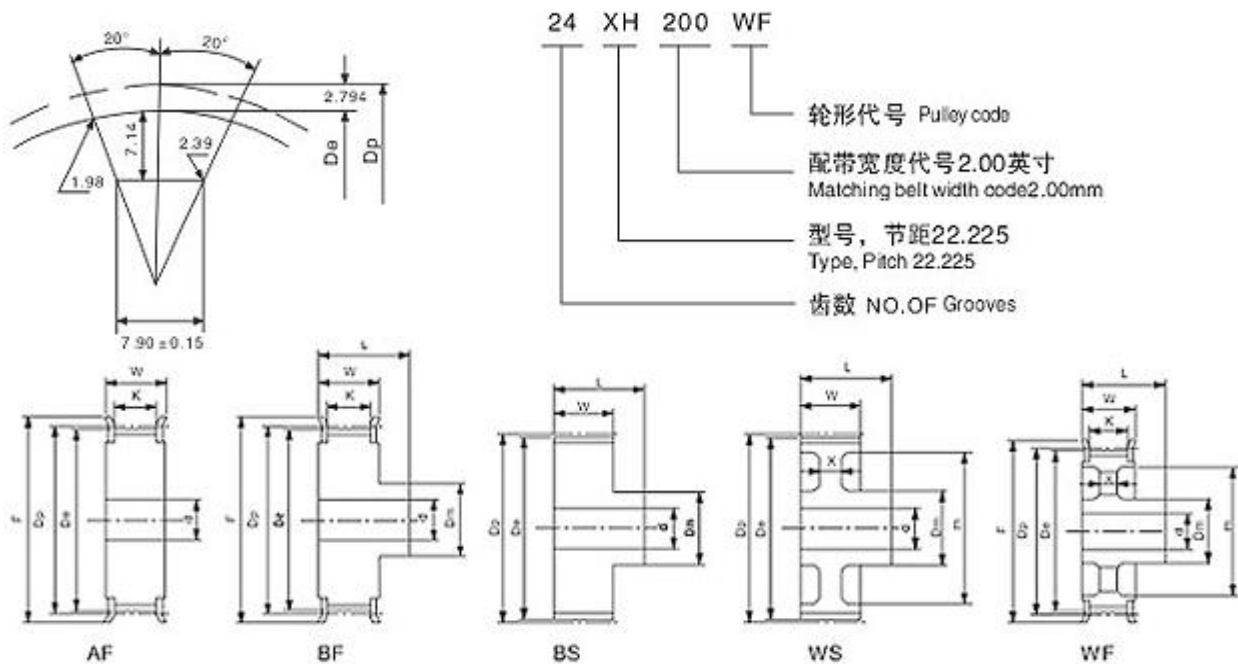

XH-std belt width300 (76.2mm)								
item	no. of grooves	type	P. D	O. D	W	L	1K	X
18XH	18	A/B	127.34	124.55	94	110	84	-
19XH	19	A/B	134.41	131.62	94	110	84	-
20XH	20	A/B	141.49	138.69	94	110	84	-
21XH	21	A/B	148.56	145.77	94	110	84	-
22XH	22	A/B	155.64	152.84	94	110	84	-
23XH	23	A/B	162.7	159.91	94	110	84	-
24XH	24	A/B	169.79	166.99	94	110	84	-
25XH	25	A/B	176.86	174.04	94	110	84	-
26XH	26	A/B	183.93	181.14	94	110	84	-
27XH	27	A/B	191.01	188.22	94	110	84	-
28XH	28	A/B	198.09	195.29	94	110	84	-
30XH	30	A/B	212.23	209.44	94	110	84	-
32XH	32	B/W	226.38	223.59	94	110	84	31
34XH	34	B/W	240.53	237.74	94	110	84	31
38XH	38	B/W	268.83	266.03	94	110	84	31
40XH	40	B/W	282.98	280.18	94	120	84	31
46XH	46	B/W	325.42	322.63	94	120	84	31
48XH	48	B/W	339.57	336.78	94	120	84	31
58XH	58	B/W	410.32	407.52	94	120	84	31
60XH	60	B/W	424.47	421.67	94	120	84	31
70XH	70	B/W	495.21	492.42	94	120	84	31
72XH	72	B/W	509.36	506.56	94	120	84	31
80XH	80	B/W	565.95	563.16	94	120	84	31
84XH	84	B/W	594.25	591.46	94	120	84	31
96XH	96	B/W	679.15	676.35	94	120	84	31
120XH	120	B/W	848.93	846.14	94	120	84	31

XXH型齿形图：

表示方法：

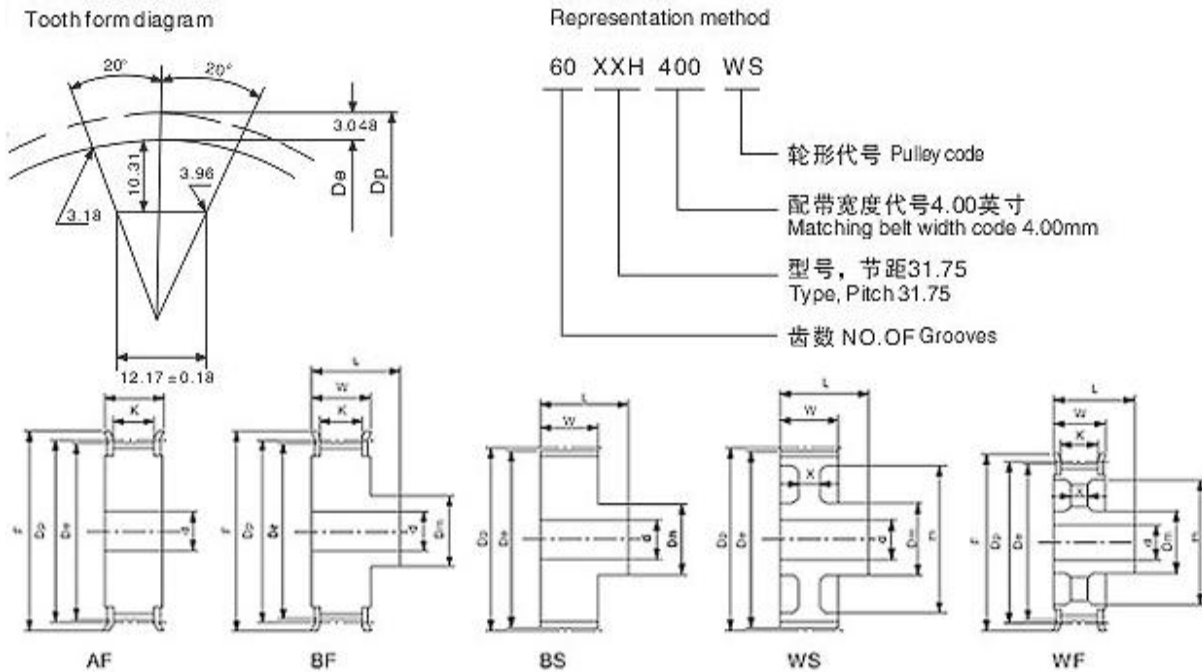

XXH-std belt width400 (101.6mm)								
item	no. of grooves	type	P. D	O. D	W	L	1K	X
18XXH	18	B/W	181.91	178.87	121	140	111	-
19XXH	19	B/W	192.02	188.97	121	140	111	-
20XXH	20	B/W	202.13	199.08	121	140	111	-
21XXH	21	B/W	212.23	209.19	121	140	111	-
22XXH	22	B/W	222.34	219.29	121	140	111	-
24XXH	24	B/W	242.55	239.5	121	140	111	45
25XXH	25	B/W	252.66	249.61	121	140	111	45
26XXH	26	B/W	262.76	259.72	121	140	111	45
27XXH	27	B/W	272.87	269.82	121	140	111	45
30XXH	30	B/W	313.19	300.14	121	140	111	45
40XXH	40	B/W	404.25	401.21	121	140	111	45
48XXH	48	B/W	485.1	482.06	121	140	111	45
60XXH	60	B/W	606.38	603.33	121	140	111	45
72XXH	72	B/W	727.66	724.61	121	140	111	45
90XXH	90	B/W	909.57	906.52	121	140	111	45
XXH-std belt width500 (127mm)								
item	no. of grooves	type	P. D	O. D	W	L	1K	X
18XXH	18	B/W	181.91	178.87	147	168	137	-
19XXH	19	B/W	192.02	188.97	147	168	137	-
20XXH	20	B/W	202.13	199.08	147	168	137	-
21XXH	21	B/W	212.23	209.19	147	168	137	-
22XXH	22	B/W	222.34	219.29	147	168	137	-
24XXH	24	B/W	242.55	239.5	147	168	137	55
25XXH	25	B/W	252.66	249.61	147	168	137	55
26XXH	26	B/W	262.76	259.72	147	168	137	55
27XXH	27	B/W	272.87	269.82	147	168	137	55

30XXH	30	B/W	313.19	300.14	147	168	137	55
40XXH	40	B/W	404.25	401.21	147	168	137	55
48XXH	48	B/W	485.1	482.06	147	168	137	55
60XXH	60	B/W	606.38	603.33	147	168	137	55
72XXH	72	B/W	727.66	724.61	147	168	137	55
90XXH	90	B/W	909.57	906.52	147	168	137	55

T2.5型齿形图:  
Tooth form diagram

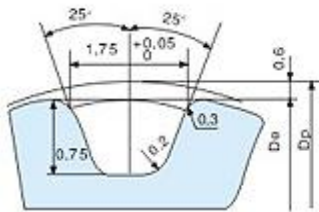

表示方法:  
Representation method

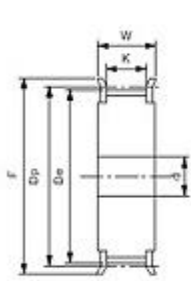
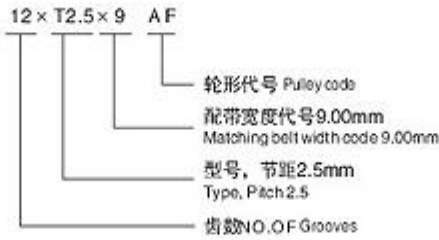

AF

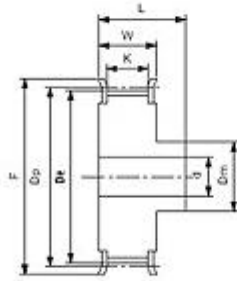

BF

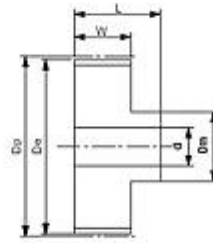

BS



CF

T2.5-std belt width (6mm)								
item	no. of grooves	type	P. D	O. D	W	L	1K	X
T2.5	12	C\A	9.55	9.04	10	18	7	-
T2.5	14	C\A	11.14	10.06	10	18	7	-
T2.5	15	C\A	11.94	11.41	10	18	7	-
T2.5	18	C\A	14.32	13.79	10	18	7	-
T2.5	19	C\A	15.12	14.59	10	18	7	-
T2.5	20	C\A	15.92	15.39	10	18	7	-
T2.5	24	C\A	19.1	18.55	10	18	7	-
T2.5	25	A\B	19.89	19.38	10	18	7	-
T2.5	30	A\B	23.87	23.34	10	18	7	-
T2.5	32	A\B	25.47	24.93	10	18	7	-
T2.5	36	A\B	28.65	28.12	10	18	7	-
T2.5	40	A\B	31.83	31.3	10	18	7	-
T2.5	48	A\B	38.2	37.69	10	18	7	-
T2.5	60	A\B	47.75	47.22	10	18	7	-

T5型齿形图:  
Tooth form diagram



表示方法:  
Representation method







型号, 节距5mm  
Type, Pitch 5mm  
齿数 NO. OF Grooves

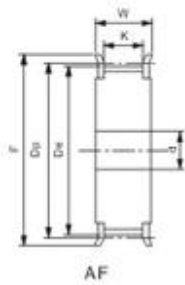

AF

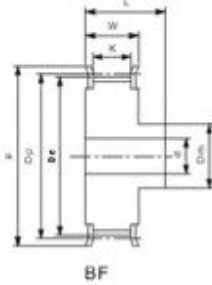

BF

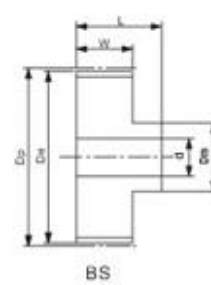

BS

T5-std belt width (6mm)								
item	no. of grooves	type	P. D	O. D	W	L	1K	X
T5	10	A/B	15.92	15.07	15	23	11	-
T5	12	A/B	19.1	18.25	15	23	11	-
T5	14	A/B	22.28	21.43	15	23	11	-
T5	15	A/B	23.87	23.02	15	23	11	-
T5	16	A/B	25.46	24.61	15	23	11	-
T5	18	A/B	28.65	27.8	15	23	11	-
T5	19	A/B	30.24	29.39	15	23	11	-
T5	20	A/B	31.83	30.98	15	23	11	-
T5	22	A/B	35.01	34.16	15	23	11	-
T5	24	A/B	38.2	37.35	15	23	11	-
T5	25	A/B	39.79	38.94	15	23	11	-
T5	26	A/B	41.36	40.53	15	23	11	-
T5	27	A/B	42.97	42.12	15	23	11	-
T5	28	A/B	44.56	43.71	15	23	11	-
T5	30	A/B	47.75	46.9	15	23	11	-
T5	32	A/B	50.93	50.08	15	23	11	-
T5	36	A/B	57.3	56.45	15	23	11	-
T5	40	A/B	63.66	62.81	15	23	11	-
T5	42	A/B	66.85	66	15	23	11	-
T5	44	A/B	70.03	69.18	15	23	11	-
T5	48	A/B	76.39	75.54	15	23	11	-
T5	50	A/B	79.58	78.73	15	23	11	-
T5	60	A/B	95.49	94.64	15	23	11	-

T10型齿形图:  
Tooth form diagram

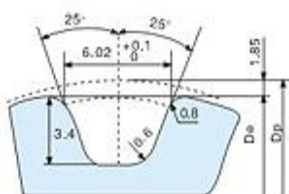

表示方法:  
Representation method



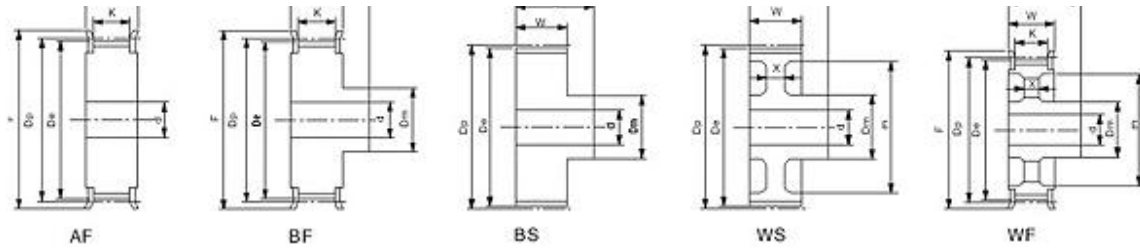

T10-std belt width (25mm)								
item	no. of grooves	type	P. D	O. D	W	L	1K	X
T10	12	A/B	38.2	36.35	32	42	27	-
T10	14	A/B	44.56	42.07	32	42	27	-
T10	15	A/B	47.75	45.9	32	42	27	-
T10	16	A/B	50.93	49.05	32	42	27	-
T10	18	A/B	57.3	55.45	32	42	27	-
T10	20	A/B	63.66	61.8	32	42	27	-
T10	22	A/B	70.03	68.15	32	42	27	-
T10	24	A/B	76.39	74.55	32	42	27	-
T10	25	A/B	79.58	77.73	32	42	27	-
T10	26	A/B	82.76	80.9	32	42	27	-
T10	28	A/B	89.13	87.28	32	42	27	-
T10	30	A/B	95.49	93.65	32	42	27	-
T10	32	A/B	101.86	100	32	42	27	-
T10	36	A/B	114.59	112.75	32	42	27	-
T10	40	A/B	127.32	125.45	32	42	27	-
T10	44	B/W	140.06	138.2	32	42	27	11
T10	48	B/W	152.79	150.9	32	42	27	11
T10	50	B/W	159.15	157.3	32	42	27	11
T10	60	B/W	190.99	189.14	32	42	27	11

T10型齿形图:  
Tooth form diagram

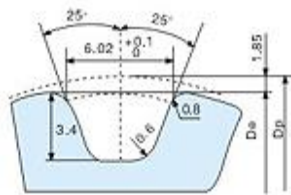

表示方法:  
Representation method

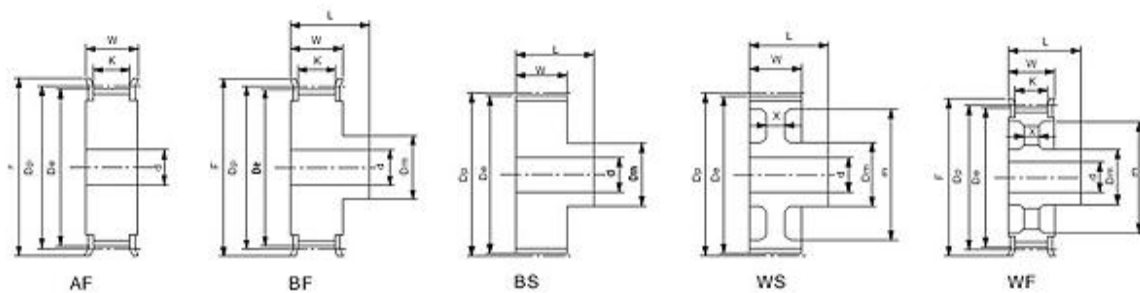

T20-std belt width (50mm)								
---------------------------	--	--	--	--	--	--	--	--

item	no. of grooves	type	P. D	O. D	W	L	1K	X
T20	18	A/B	114.59	111.76	65	73	56	-
T20	19	A/B	120.96	118.13	65	73	56	-
T20	20	A/B	127.35	124.49	65	73	56	-
T20	21	A/B	133.69	130.86	65	73	56	-
T20	22	A/B	140.06	137.23	65	73	56	-
T20	23	A/B	146.42	143.59	65	73	56	-
T20	24	A/B	152.79	149.96	65	73	56	-
T20	25	A/B	159.15	156.32	65	73	56	-
T20	26	A/B	165.52	162.69	65	73	56	-
T20	27	A/B	171.89	169.06	65	73	56	-
T20	28	A/B	178.25	175.42	65	73	56	-
T20	29	A/B	184.62	181.79	65	73	56	-
T20	30	A/B	190.99	188.16	65	73	56	-
T20	32	W	203.72	200.89	65	73	56	20
T20	34	W	216.45	213.62	65	73	56	20
T20	36	W	229.18	226.35	65	73	56	20
T20	38	W	241.92	239.09	65	73	56	20
T20	40	W	254.65	251.82	65	73	56	20
T20	42	W	267.38	264.55	65	73	56	20
T20	44	W	280.11	277.28	65	73	56	20
T20	46	W	292.85	290.02	65	73	56	20
T20	48	W	305.58	302.75	65	73	56	20
T20	50	W	318.31	315.48	65	73	56	20
T20	60	W	381.97	379.14	65	73	56	20
T20	72	W	458.37	455.54	65	73	56	20

3M型齿形图:  
Tooth form diagram

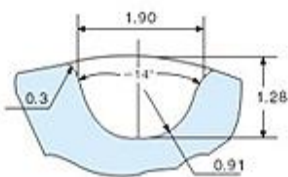

表示方法:  
Representation method

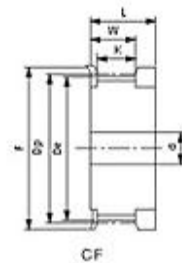
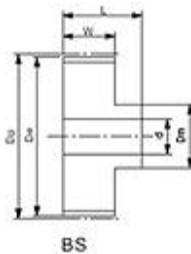
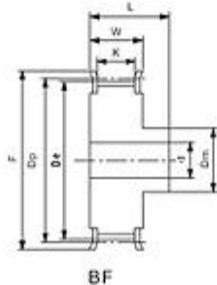
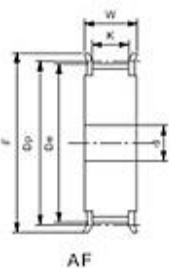
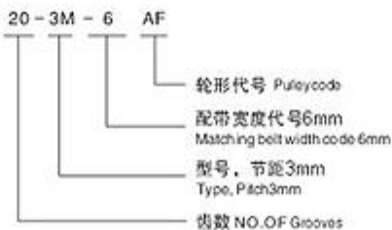

3M-std belt width 6mm

item	no. of grooves	type	P. D	O. D	W	L	1K	X
3M	10	C/A	9.55	8.79	11	19	7	-

3M	11	C/A	10.5	9.74	11	19	7	-
3M	12	C/A	11.46	10.7	11	19	7	-
3M	14	C/A	13.37	12.61	11	19	7	-
3M	15	C/A	14.32	13.56	11	19	7	-
3M	16	C/A	15.28	14.52	11	19	7	-
3M	18	C/A	17.19	16.43	11	19	7	-
3M	19	C/A	18.14	17.38	11	19	7	-
3M	20	C/A	19.1	18.34	11	19	7	-
3M	21	A/B	20.05	19.29	11	19	7	-
3M	22	A/B	21.01	20.25	11	19	7	-
3M	24	A/B	22.92	22.16	11	19	7	-
3M	25	A/B	23.87	23.11	11	19	7	-
3M	26	A/B	24.83	24.07	11	19	7	-
3M	28	A/B	26.74	25.98	11	19	7	-
3M	30	A/B	28.65	27.89	11	19	7	-
3M	32	A/B	30.56	29.8	11	19	7	-
3M	34	A/B	32.47	31.71	11	19	7	-
3M	36	A/B	34.38	33.62	11	19	7	-
3M	38	A/B	36.29	35.53	11	19	7	-
3M	40	A/B	38.2	37.44	11	19	7	-
3M	46	A/B	43.93	43.16	11	19	7	-
3M	48	A/B	45.84	45.07	11	19	7	-
3M	60	A/B	57.3	56.53	11	19	7	-

5M型齿形图:  
Tooth form diagram

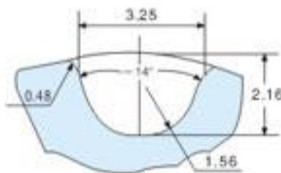

表示方法:  
Representation method

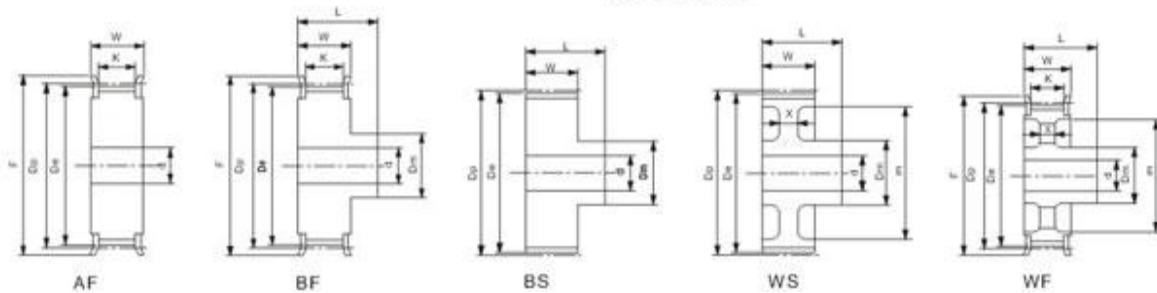
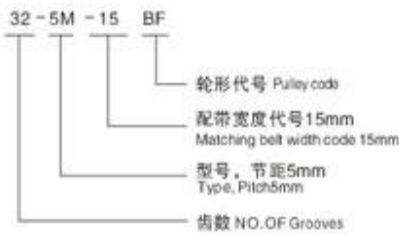

5M-std belt width 15mm								
item	no. of grooves	type	P. D	O. D	W	L	1K	X
5M	14	A/B	22.28	21.14	20	28	16	-
5M	15	A/B	23.87	22.73	20	28	16	-
5M	16	A/B	25.46	24.32	20	28	16	-
5M	18	A/B	28.65	27.5	20	28	16	-
5M	19	A/B	30.24	29.1	20	28	16	-

5M	20	A/B	31.83	30.69	20	28	16	-
5M	21	A/B	33.42	32.28	20	28	16	-
5M	22	A/B	35.01	33.87	20	28	16	-
5M	24	A/B	38.2	37.05	20	28	16	-
5M	25	A/B	39.79	38.65	20	28	16	-
5M	26	A/B	41.38	40.24	20	28	16	-
5M	28	A/B	44.56	43.42	20	28	16	-
5M	30	A/B	47.75	46.6	20	28	16	-
5M	32	A/B	50.93	49.79	21	28	16	-
5M	34	A/B	54.11	52.98	21	28	16	-
5M	36	A/B	57.3	56.15	21	28	16	-
5M	38	A/B	60.48	59.34	21	28	16	-
5M	40	A/B	63.66	62.52	21	28	16	-
5M	42	A/B	66.85	65.7	21	28	16	-
5M	46	A/B	73.21	72.07	21	28	16	-
5M	48	A/B	76.69	75.25	21	28	16	-
5M	50	W	79.58	78.43	21	28	16	7
5M	54	W	85.94	84.8	21	28	16	7
5M	56	W	89.13	87.98	21	28	16	7
5M	58	W	92.31	91.17	21	28	16	7
5M	60	W	95.48	94.35	21	28	16	7
5M	72	W	114.59	113.45	21	28	16	7

8M型齿形图:  
Tooth form diagram

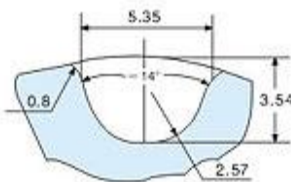

表示方法:  
Representation method

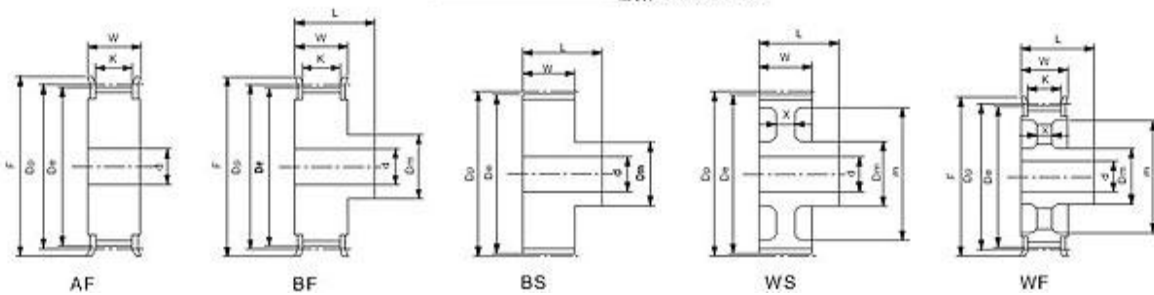
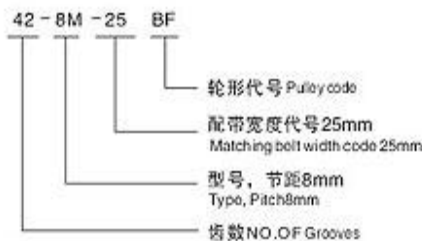

8M-std belt width 30mm								
item	no. of grooves	type	P. D	O. D	W	L	1K	X
8M	22	A/B	56.02	54.65	37	58	32	-
8M	24	A/B	61.12	59.74	37	58	32	-
8M	25	A/B	63.66	62.29	37	58	32	-
8M	26	A/B	66.21	64.84	37	58	32	-
8M	28	A/B	71.3	69.93	37	58	32	-
8M	30	A/B	76.39	75.02	37	58	32	-

8M	32	A/B	81.49	80.12	37	58	32	-
8M	34	A/B	86.58	85.21	37	58	32	-
8M	36	A/B	91.67	90.3	37	58	32	-
8M	38	A/B	96.77	95.39	37	58	32	-
8M	40	A/B	101.86	100.49	37	58	32	-
8M	42	A/B	106.95	105.58	37	58	32	-
8M	44	A/B	112.05	110.67	38	58	32	-
8M	46	A/B	117.14	115.77	38	58	32	-
8M	48	A/B	122.23	120.86	38	58	32	-
8M	50	B/W	127.32	125.95	38	58	32	9
8M	52	B/W	132.42	11.4	38	58	32	9
8M	56	B/W	142.6	141.23	38	58	32	9
8M	58	B/W	147.7	146.32	38	58	32	9
8M	60	B/W	152.79	151.42	38	58	32	9
8M	62	B/W	157.88	156.51	38	58	32	9
8M	64	B/W	162.97	161.6	38	58	32	9
8M	67	B/W	170.61	169.24	38	58	32	9
8M	72	B/W	183.35	181.97	38	58	32	9
8M	80	B/W	203.72	202.35	38	58	32	9
8M	84	B/W	213.9	212.53	38	58	32	9
8M	90	B/W	229.18	227.81	38	58	32	9
8M	96	B/W	244.46	243.09	38	58	32	9
8M	112	B/W	285.21	283.83	38	58	32	9

14M型齿形图:  
Tooth form diagram

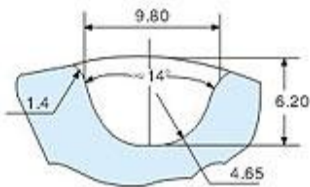

表示方法:  
Representation method

72-14M-55 WS

72-14M-55 WS  
 72 轮形代号 Pulley code  
 14M 配带宽度代号55mm  
 Matching belt width code 55mm  
 55 型号, 节距14mm  
 Type, Pitch 14mm  
 WS 齿数 NO. OF Grooves

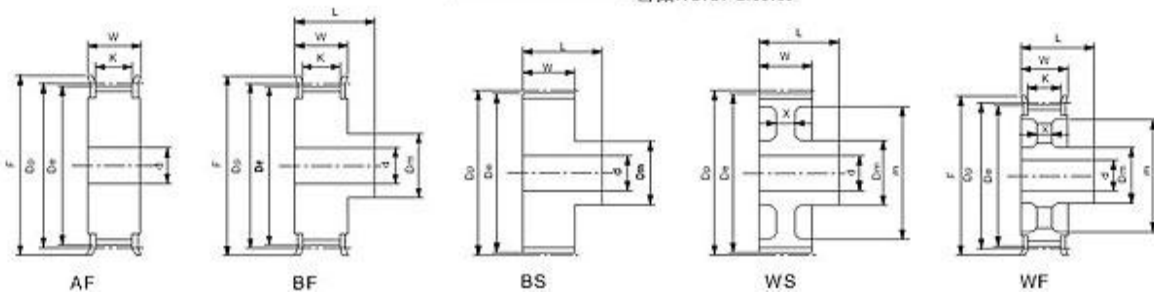

14M-std belt width 115mm								
item	no. of grooves	type	P. D	O. D	W	L	1K	X
28-14M	28	A/B	124.78	121.98	128	153	120	-
29-14M	29	A/B	129.23	126.44	128	153	120	-
30-14M	30	A/B	133.69	130.9	128	153	120	-
32-14M	32	A/B	142.6	139.81	128	153	120	-
34-14M	34	A/B	151.52	148.72	128	153	120	-

36-14M	36	A/B	160.43	157.63	128	153	120	-
38-14M	38	A/B	169.34	166.55	128	153	120	-
40-14M	40	B/W	178.25	175.46	128	153	120	26
42-14M	42	B/W	187.17	184.37	128	153	120	26
44-14M	44	B/W	196.08	193.28	128	153	120	26
46-14M	46	B/W	204.99	202.2	128	153	120	26
48-14M	48	B/W	213.9	211.11	128	153	120	26
56-14M	56	B/W	249.55	246.76	128	153	120	26
60-14M	60	B/W	267.38	364.59	128	153	120	26
64-14M	64	B/W	285.21	282.41	128	153	120	26
72-14M	72	B/W	320.86	318.06	128	153	120	26
80-14M	80	B/W	356.51	353.71	128	153	120	26
84-14M	84	B/W	374.33	371.54	128	153	120	26
90-14M	90	B/W	401.07	398.28	128	153	120	26
96-14M	96	B/W	427.81	425.01	128	153	120	26
112-14M	112	B/W	499.11	496.32	128	153	120	26
144-14M	144	B/W	641.71	638.92	128	153	120	26

20M型齿形图:  
Tooth form diagram

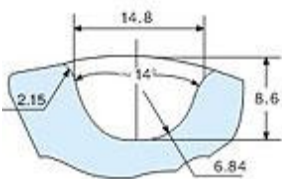

表示方法:  
Representation method

34-20M-115 WS

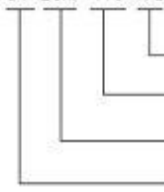

轮形代号 Pulley code  
配带宽度代号 115mm  
Matching belt width code 115mm  
型号, 节距20mm  
Type, Pitch 20mm  
齿数 NO. OF Grooves

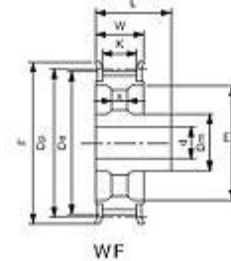
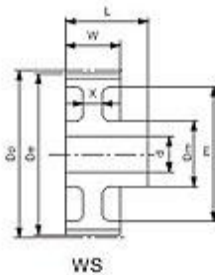
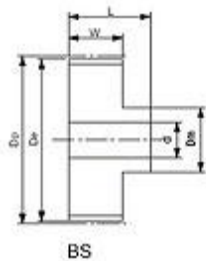
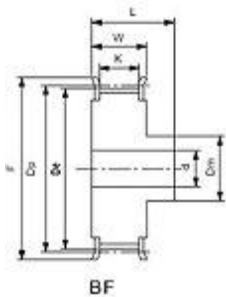

20M-std belt width 230mm								
item	no. of grooves	type	P. D	O. D	W	L	1K	X
34-20M	34	B/W	216.45	212.13	250	283	240	-
36-20M	36	B/W	229.18	224.87	250	283	240	-
38-20M	38	B/W	241.92	237.6	250	283	240	-
40-20M	40	B/W	254.56	250.33	250	283	240	-
44-20M	44	B/W	280.11	275.79	250	283	240	-
48-20M	48	B/W	305.88	301.26	250	283	240	-
52-20M	52	B/W	331.04	326.72	250	283	240	-
56-20M	56	B/W	356.51	352.19	250	283	240	-
60-20M	60	W	381.97	377.65	250	283	240	40
64-20M	64	W	407.44	403.12	250	283	240	40
68-20M	68	W	432.9	428.58	250	283	240	40

72-20M	72	W	458.37	454.05	250	283	240	40
80-20M	80	W	509.3	504.98	250	283	240	40
90-20M	90	W	572.96	568.64	250	283	240	40
20M-std belt width290mm								
item	no. of grooves	type	P. D	O. D	W	L	1K	X
34-20M	34	B/W	216.45	212.13	305	343	295	-
36-20M	36	B/W	229.18	224.87	305	343	295	-
38-20M	38	B/W	241.92	237.6	305	343	295	-
40-20M	40	B/W	254.56	250.33	305	343	295	-
44-20M	44	B/W	280.11	275.79	305	343	295	-
48-20M	48	B/W	305.88	301.26	305	343	295	-
52-20M	52	B/W	331.04	326.72	305	343	295	-
56-20M	56	B/W	356.51	352.19	305	343	295	-
60-20M	60	W	381.97	377.65	305	343	295	42
64-20M	64	W	407.44	403.12	305	343	295	42
68-20M	68	W	432.9	428.58	305	343	295	42
72-20M	72	W	458.37	454.05	305	343	295	42
80-20M	80	W	509.3	504.98	305	343	295	42
90-20M	90	W	572.96	568.64	305	343	295	42