



Non-contact Magnetostrictive
Position Sensors



Contents

model **MSW**

model **MST**

model **MSS**

CONNECTION INFORMATION

ACCESSORIES

APPLICATIONS



Non-Contact Absolute Position Transducers



Technical Specifications

Measurement stroke	100 to 2000 mm
Resolution	16 bit DAC output
Repeatability	±0.005% full scale
Output	0-10V, 4-20mA, 0-20mA, 10-0V, 20-4mA, 20-0mA
Power supply	24 VDC ±10%
Displacement speed	< 10 m/s
Sampling rate	1 KHz
Max. consumption	(50mA - 90mA) depends on model
Max. output noise	< 5mVpp
Max. output value	10.5 Volt
Linearity	±0,02% full scale (min. 100µm)
Update time	0,5ms up to 1000m / 0,8ms up to 2000m
Reverse polarity protection	Up to -30Vdc
Overvoltage protection	Up to 40Vdc

Mechanical Data

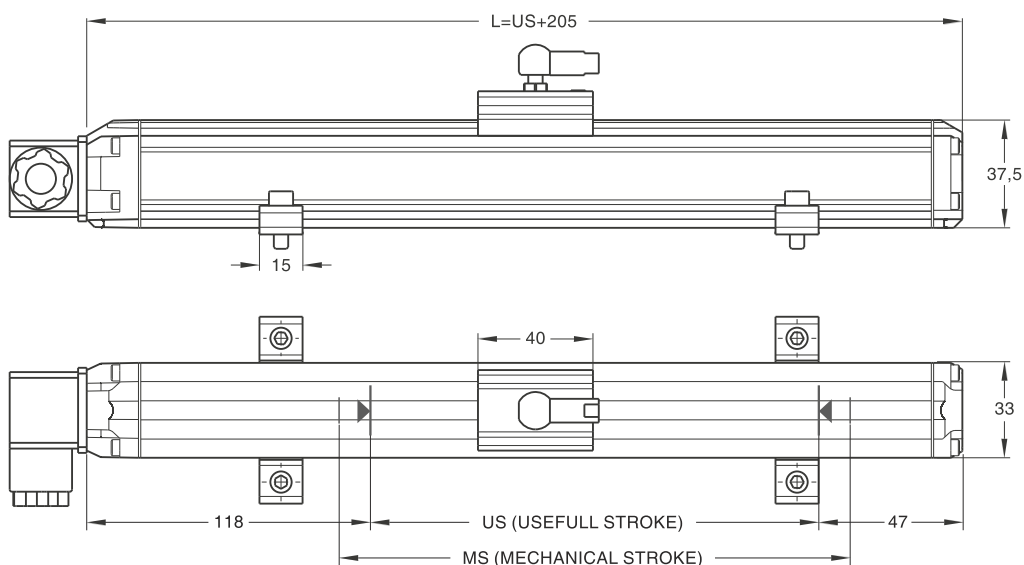

MSW (mm)	100	150	200	250	300	350	400	450	500	550	600	650	700	750	800	850	900	1000	1250	1500	1750	2000
US (Usefull Stroke)	140	190	240	290	340	390	440	490	540	590	640	690	740	790	840	890	940	1040	1290	1540	1790	2040
MS (Mechanical Stroke)	160	210	280	310	360	410	460	510	560	610	660	710	760	810	860	910	960	1060	1310	1560	1810	2060
L (Total Length)	305	355	405	455	505	555	605	655	705	755	805	855	905	955	1005	1055	1105	1205	1455	1705	1955	2205

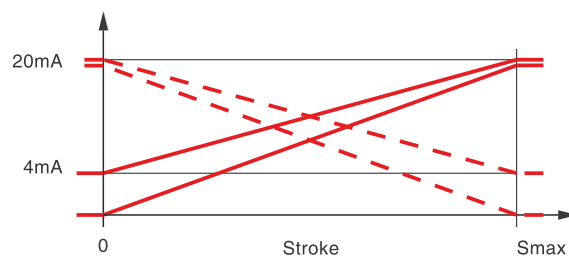
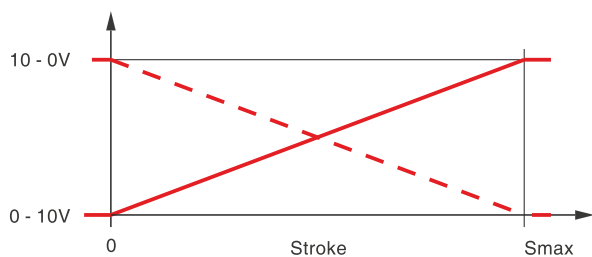

Mechanical Mounting

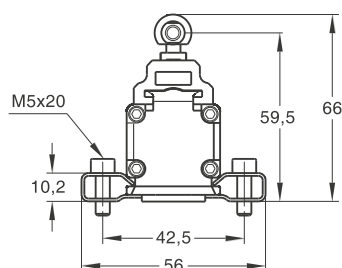
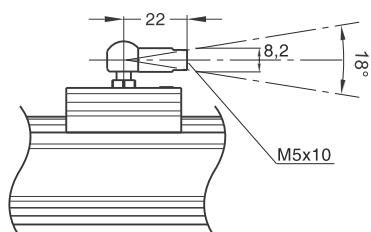

Ordering Procedure

	MSW	300	A	V10	C1	BR01
Model						
MSW						
Usefull stroke	100 - 2000mm in 50mm increments (custom sizes available on request)					
Resolution	A : 16 bit					
Outputs	V10 : 0-10V V01 : 10-0V I40 : 4-20mA I20 : 0-20mA I02 : 20-0mA I04 : 20-4mA V11 : 0-10V - 10-0V I41 : 4-20mA - 20-4mA I21 : 0-20mA - 20-0mA					
Connector / Cable (see page 10)	C1 : 4 pin connector C5 : 5 pin connector C8 : 8 pin connector M Cable (2M5=2,5m cable)					
Fixing Bracket (see page 12)	OP-BR01 OP-BR02 OP-BR03					

Designed For Position And Level Measurement



Technical Specifications

Measurement stroke	100 to 2000 mm
Resolution	16 bit DAC output
Repeatability	±0.005% full scale
Output	0-10V, 4-20mA, 0-20mA, 10-0V, 20-4mA, 20-0mA
Power supply	24 VDC ±10%
Displacement speed	< 10 m/s
Sampling rate	1 KHz
Max. consumption	(50mA - 90mA) depends on model
Max. output noise	< 5mVpp
Max. output value	10.5 Volt
Linearity	±0,02% full scale (min. 100µm)
Update time	0,5ms up to 1000m / 0,8ms up to 2000m
Reverse polarity protection	Up to -30Vdc
Overvoltage protection	Up to 40Vdc
Pressure rating	< 500 bar
Mounting	M18 x 1.5
Housing material	Profile: Anodized aluminium, Tube: Stainless steel, Caps: Stainless steel

Sensopulse®

Mechanical Data

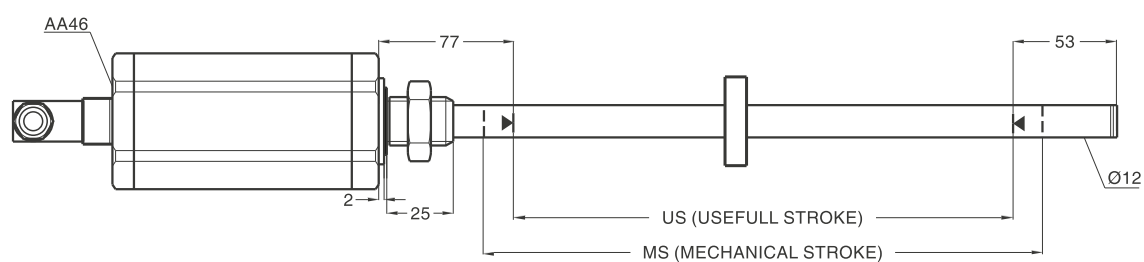
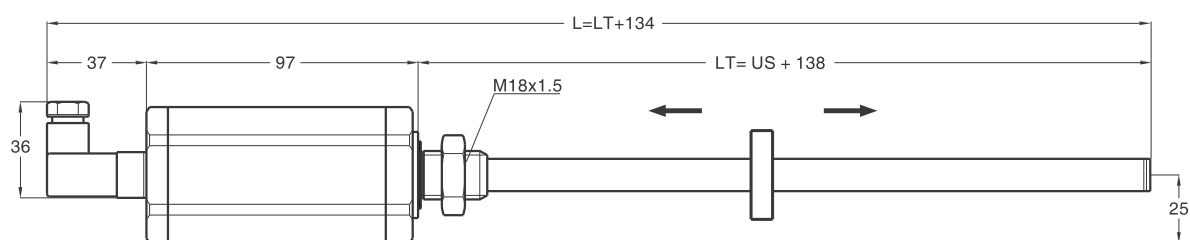

MST (mm)	100	150	200	250	300	350	400	450	500	550	600	650	700	750	800	850	900	1000	1250	1500	1750	2000
US (Usefull Stroke)	108	158	208	258	308	358	408	458	508	558	608	658	708	758	808	858	908	1008	1258	1508	1758	2008
MS (Mechanical Stroke)	128	178	228	278	328	378	428	478	528	578	628	678	728	778	828	878	928	1028	1278	1528	1778	2028
LT	238	288	338	388	438	488	538	588	638	688	738	788	838	888	938	988	1038	1138	1388	1638	1888	2138
L (Total Length)	372	422	472	522	572	622	672	722	772	822	872	922	972	1022	1072	1122	1172	1272	1472	1772	1972	1272

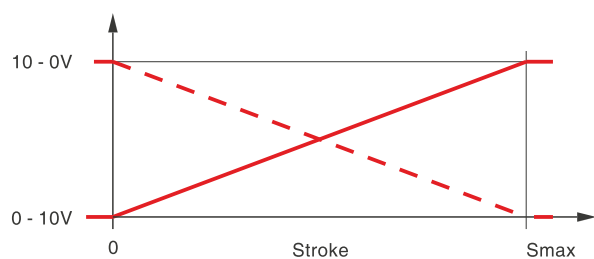

0 - 10V / 10 - 0V output

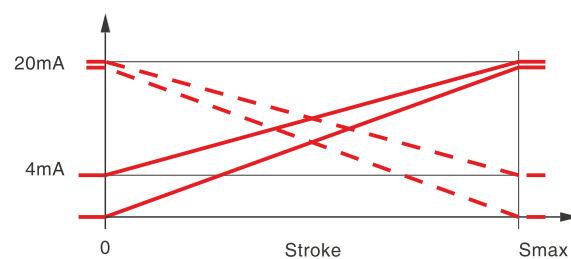

4 - 20mA / 0 - 20mA
20 - 4mA / 20 - 0mA output

Installation

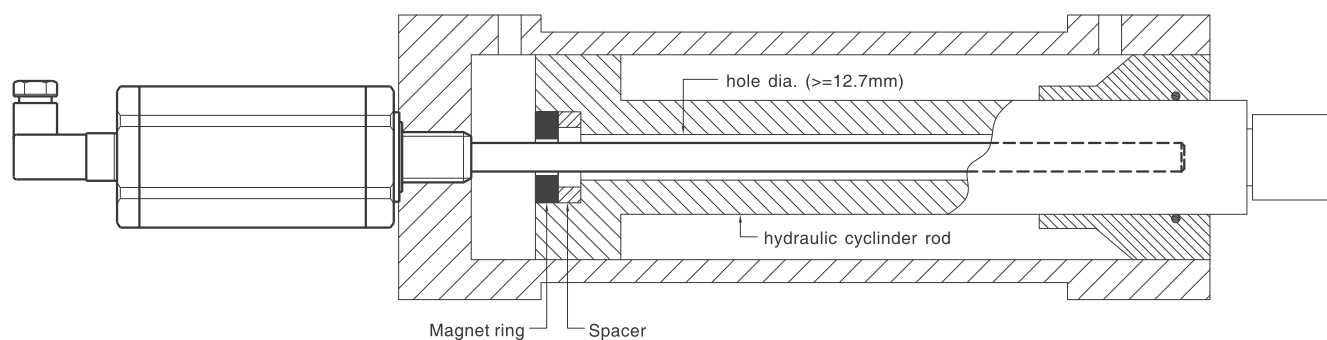

Sensopulse®

Ordering Procedure

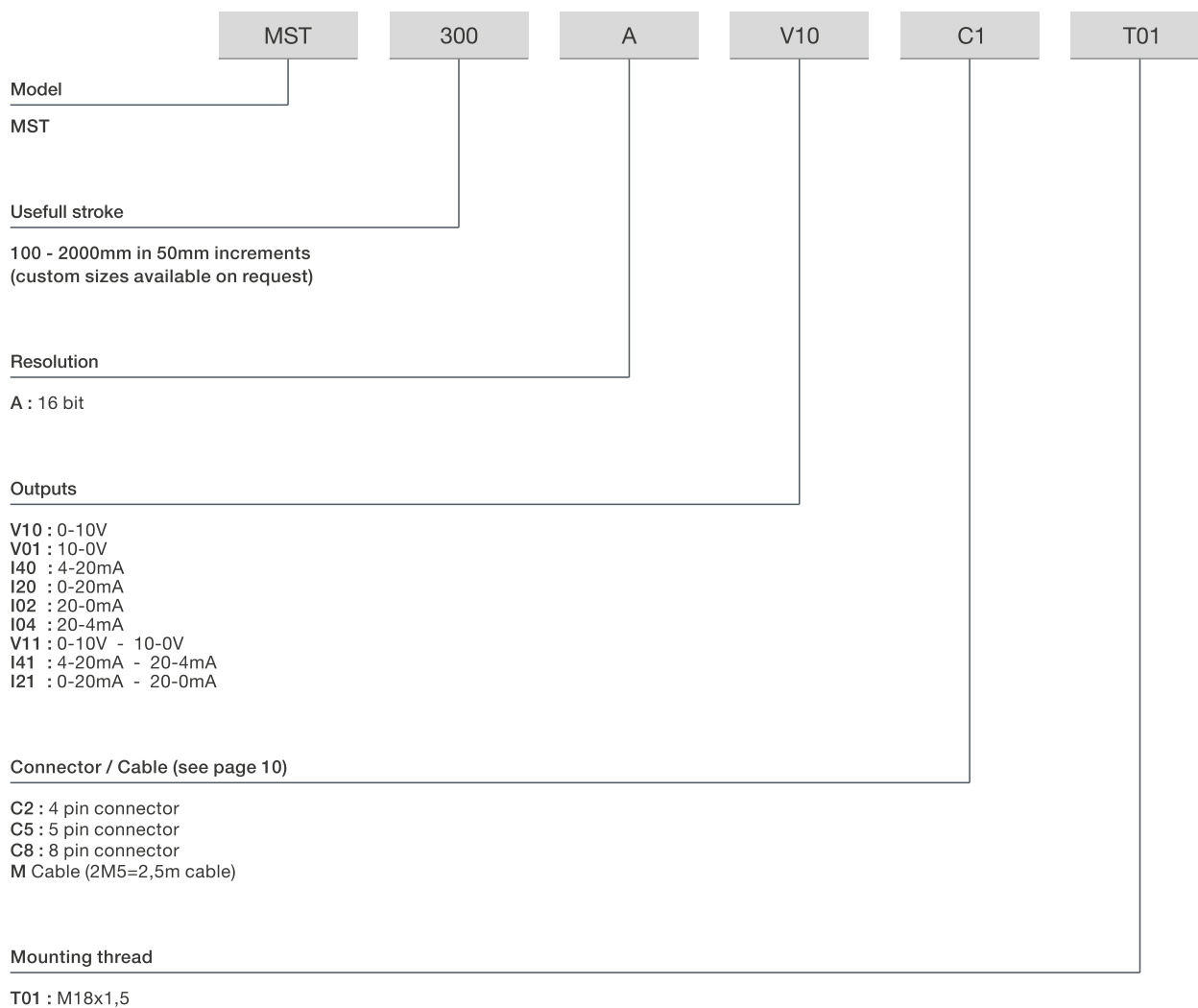

Wear Free Transducers With Unlimited Mechanical Life



Technical Specifications

Measurement stroke	100 to 2000 mm
Resolution	16 bit DAC output
Repeatability	±0.005% full scale
Output	0-10V, 4-20mA, 0-20mA, 10-0V, 20-4mA, 20-0mA
Power supply	24 VDC ±10%
Displacement speed	< 10 m/s
Sampling rate	1 KHz
Max. consumption	(50mA - 90mA) depends on model
Max. output noise	< 5mVpp
Max. output value	10.5 Volt
Linearity	±0,02% full scale (min. 100µm)
Update time	0,5ms up to 1000m / 0,8ms up to 2000m
Reverse polarity protection	Up to -30Vdc
Overvoltage protection	Up to 40Vdc



Mechanical Data

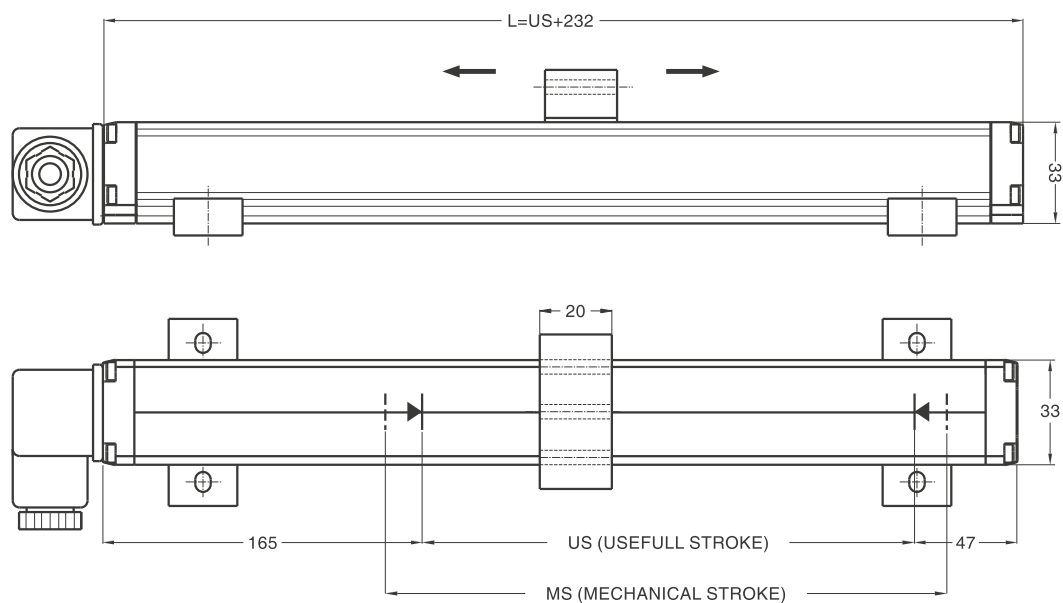

MSS (mm)	100	150	200	250	300	350	400	450	500	550	600	650	700	750	800	850	900	1000	1250	1500	1750	2000
US (Usefull Stroke)	120	170	220	270	320	370	420	470	520	570	620	670	720	770	820	870	920	1020	1270	1520	1770	2020
MS (Mechanical Stroke)	160	210	260	310	360	410	460	510	560	610	660	710	760	810	860	910	960	1060	1310	1560	1810	2060
L (Total Length)	332	382	432	482	532	582	632	682	732	782	832	882	932	982	1032	1082	1132	1232	1482	1732	1982	2232

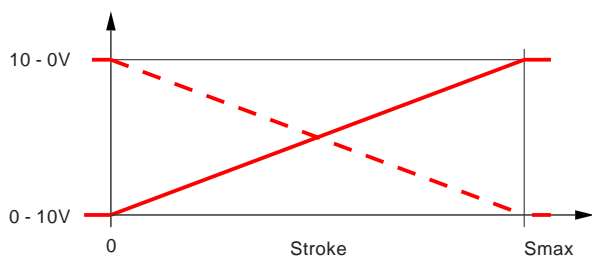

0 - 10V / 10 - 0V output

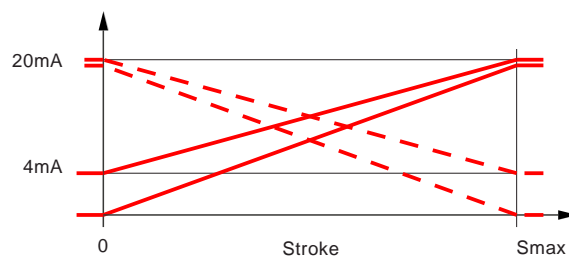

4 - 20mA / 0 - 20mA
20 - 4mA / 20 - 0mA output

Mechanical Mounting

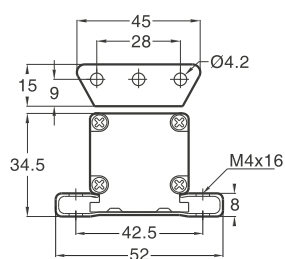

Standard bracket

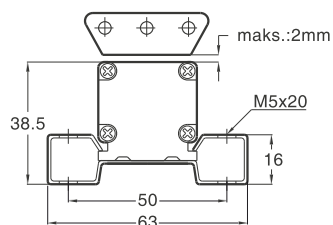

Optional bracket

Ordering Procedure

	MSS	300	A	V10	C1	BR01
Model	MSS					
Usefull stroke	100 - 2000mm in 50mm increments (custom sizes available on request)					
Resolution	A : 16 bit					
Outputs	V10 : 0-10V V01 : 10-0V I40 : 4-20mA I20 : 0-20mA I02 : 20-0mA I04 : 20-4mA V11 : 0-10V - 10-0V I41 : 4-20mA - 20-4mA I21 : 0-20mA - 20-0mA					
Connector / Cable (see page 10)	C1 : 4 pin connector C5 : 5 pin connector C8 : 8 pin connector M Cable (2M5=2,5m cable)					
Fixing Bracket (see page 12)	OP-BR01 OP-BR02 OP-BR03					

Function	C1 / C2 ⁽¹⁾	C5/M12	C5/M16	C8/M12	C8/M16	Cable channels
Output Cursor 1 0-10V 0-20mA 4-20mA	2	2	2	6	6	White
Inverse output cursor 1 10-0V, 20-0mA, 20-4mA or Output cursor 2 0-10V, 0-20mA, 4-20mA	4 ⁽²⁾	4 ⁽²⁾	4 ⁽²⁾	4	4	Yellow
Power Supply +24V	3	1	1	5	5	Brown
Power Supply GND	1	3	3	2	2	Blue
Output cursor 1 GND	4 ⁽²⁾	5	5	8	8	Grey
Output cursor 1 Output cursor 2 GND	-	-	-	3	3	Green
NC	-	4 ⁽²⁾	4 ⁽²⁾	1	1	-
NC	-	-	-	7	7	-

(1) : for MST

(2) : optional due to output configuration

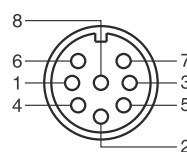
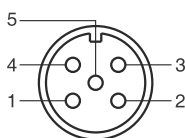
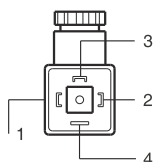

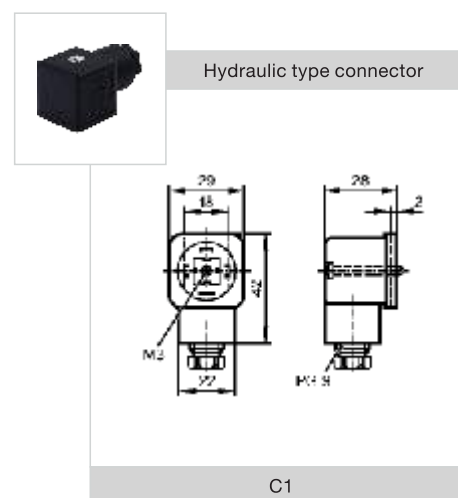
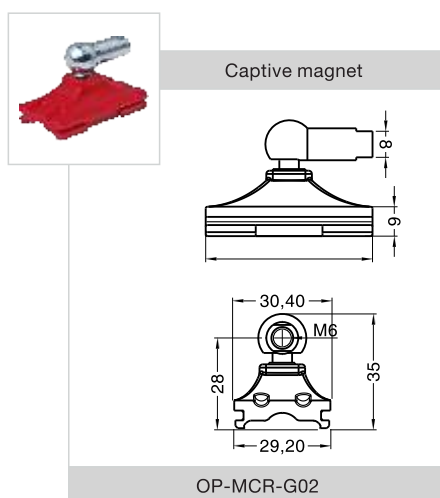
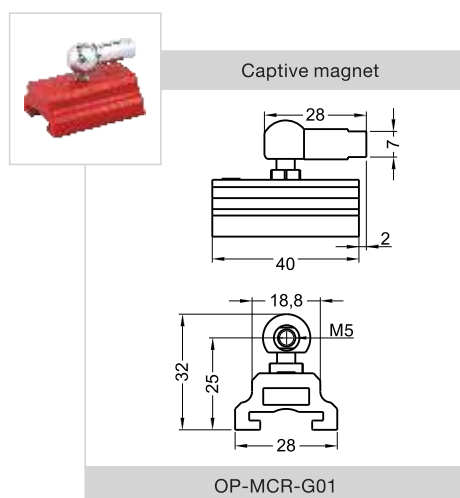
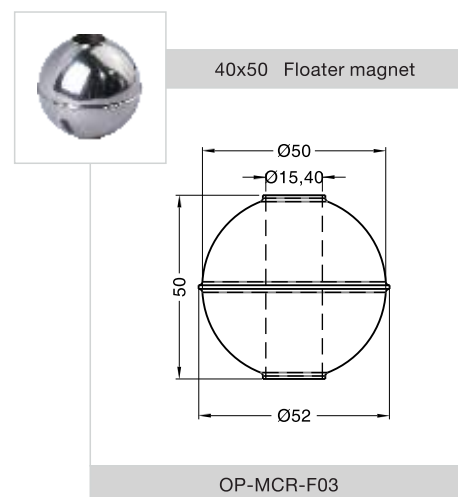
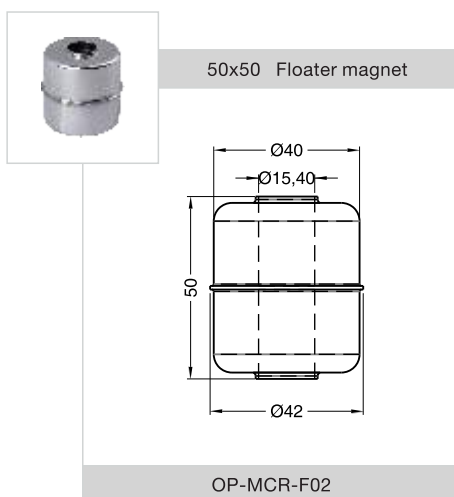
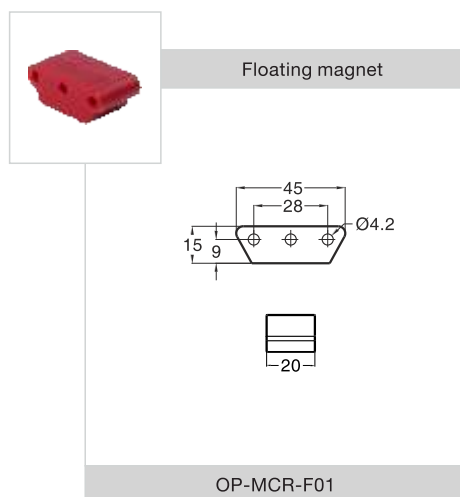
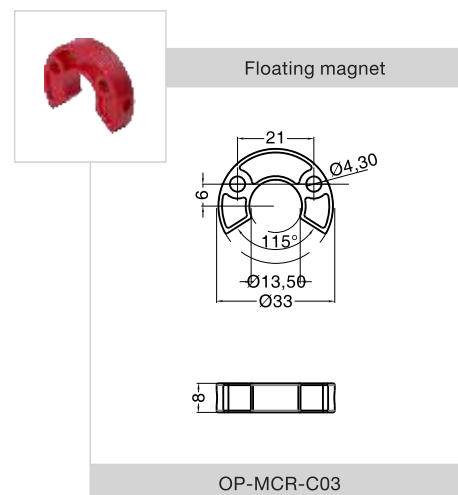
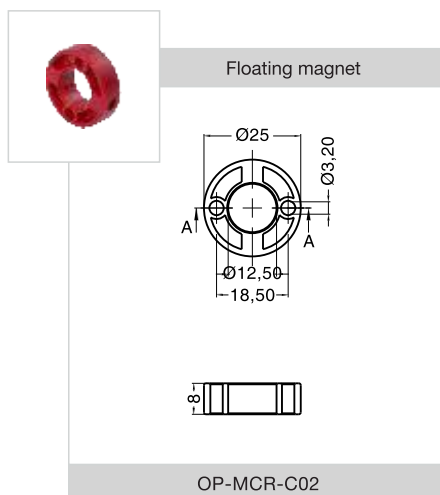
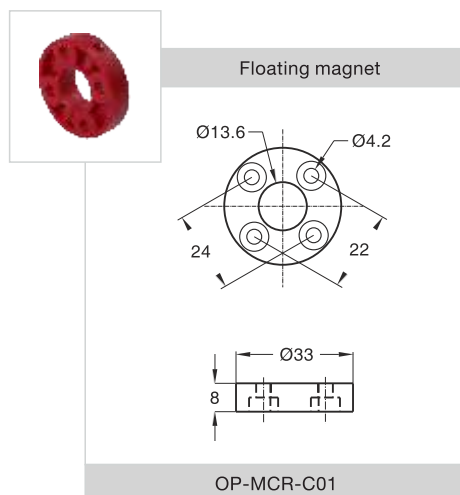



Hydraulic type connector

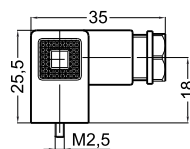

C2



5 pin connector

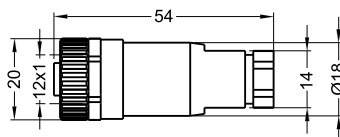

C5



8 pin connector

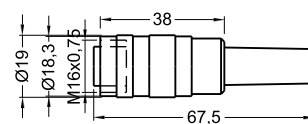

C8



Fixing bracket

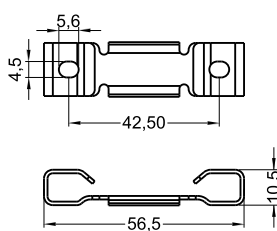

OP-BR-01



Fixing bracket

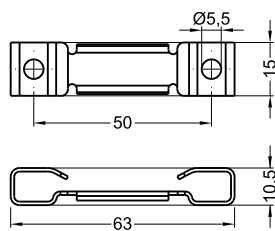

OP-BR-02



Fixing bracket

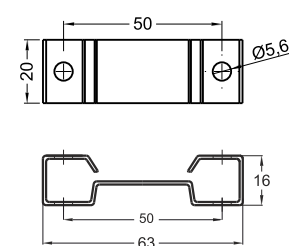

OP-BR-03

APPLICATIONS

Magnetostrictive Position Sensor



Plastic Injection



Level Measuring



Marble / Stone Polishing



Hydraulic Press



Automotive



Food Processing



Water Dam Controls



Medical Equipments

 **Sensopulse**[®]



OPKON Optik Elektronik Kont. San. ve Tic. Ltd. Şti.
Terazidere Mah. 60. Yıl Cad. No:46 Bayrampaşa / İstanbul / TURKEY
Tel : +90 (212) 501 48 63 Pbx Fax : +90 (212) 501 48 83
Web : www.opkon.com.tr E-mail : info@opkon.com.tr