

Resistive Linear Position Transducer



- Measuring range 50mm – 1250mm
- Long mechanical life 100.000.000 cycles
- Excellent repeatability
- Very low temperature drift
- Infinite resolution

Main Applications

Metal Forming Machineries, Textile Machineries, Packing Machineries, Printing Machineries, Marble/ Stone Machineries and General Automation Applications

Specifications

| | |
|-----------------------------|------------------------------|
| Mechanical stroke | 50mm to 1250mm |
| Linearity | ± %0,05 |
| Resolution | Infinite |
| Resistance output | 5 Kohm or 10 Kohm |
| Resistance tolerance | ± %20 |
| Load resistance | Min. 10 Kohm |
| Repeatability | ≤ %0.01 |
| Mechanical life | 100 * 10 ⁶ Cycles |
| Displacement speed | ≤ 5 m/s |
| Permissible applied voltage | 28 VDC max |
| Recommended cursor current | < 1 µA |
| Electrical connections | 4 Pole connector |
| Case dimensions | Ø 38mm |
| Case material | Anodized aluminium |
| Rod diameter | 10mm |
| Rod material | Stainless steel |
| IP Degree | IP 65 |
| Working temperature | - 20 / + 80 °C |
| Mechanical fixing | 2 Ball joints |

Dimensions

| Model | LM | Mechanical stroke (MS) | Electrical measuring stroke (EMS) | Total lengt (L) |
|-------|------|------------------------|-----------------------------------|-----------------|
| LPC | 50 | 52mm | 50mm | 222mm |
| LPC | 100 | 102mm | 100mm | 272mm |
| LPC | 125 | 127mm | 125mm | 297mm |
| LPC | 150 | 152mm | 150mm | 322mm |
| LPC | 175 | 177mm | 175mm | 347mm |
| LPC | 200 | 202mm | 200mm | 372mm |
| LPC | 225 | 227mm | 225mm | 397mm |
| LPC | 250 | 252mm | 250mm | 422mm |
| LPC | 275 | 277mm | 275mm | 447mm |
| LPC | 300 | 302mm | 300mm | 472mm |
| LPC | 325 | 327mm | 325mm | 497mm |
| LPC | 350 | 352mm | 350mm | 522mm |
| LPC | 375 | 377mm | 375mm | 547mm |
| LPC | 400 | 402mm | 400mm | 572mm |
| LPC | 450 | 452mm | 450mm | 622mm |
| LPC | 500 | 502mm | 500mm | 672mm |
| LPC | 450 | 452mm | 450mm | 622mm |
| LPC | 500 | 502mm | 500mm | 672mm |
| LPC | 550 | 552mm | 550mm | 722mm |
| LPC | 600 | 602mm | 600mm | 772mm |
| LPC | 650 | 652mm | 650mm | 822mm |
| LPC | 700 | 702mm | 700mm | 872mm |
| LPC | 750 | 752mm | 750mm | 922mm |
| LPC | 800 | 802mm | 800mm | 972mm |
| LPC | 850 | 852mm | 850mm | 1022mm |
| LPC | 900 | 902mm | 900mm | 1072mm |
| LPC | 1000 | 1002mm | 1000mm | 1172mm |
| LPC | 1250 | 1252mm | 1250mm | 1422mm |

Mechanical dimensions

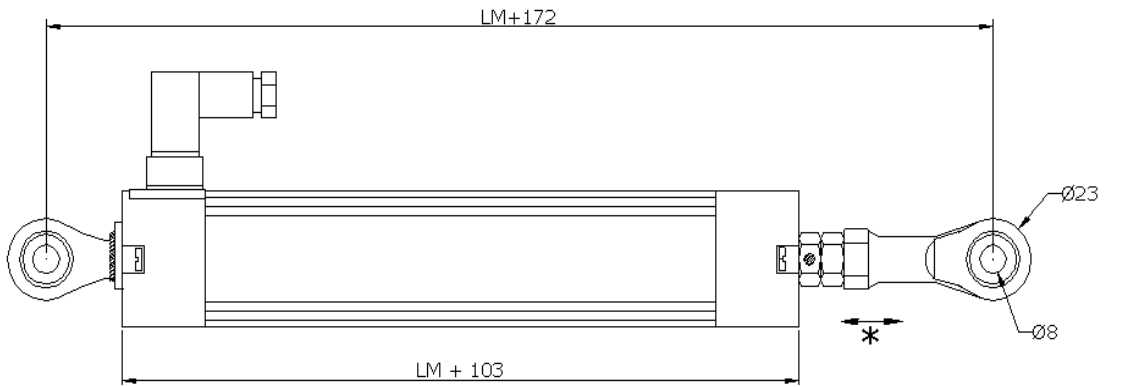

* (LM+172) - (LM+180)

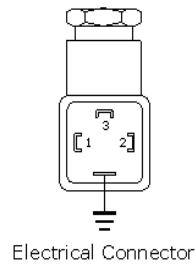
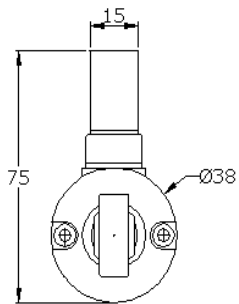

Electrical Connector

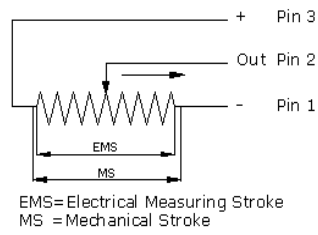

EMS= Electrical Measuring Stroke
MS = Mechanical Stroke