

## Timing Pulley HTD 3M-06

3mm Pitch

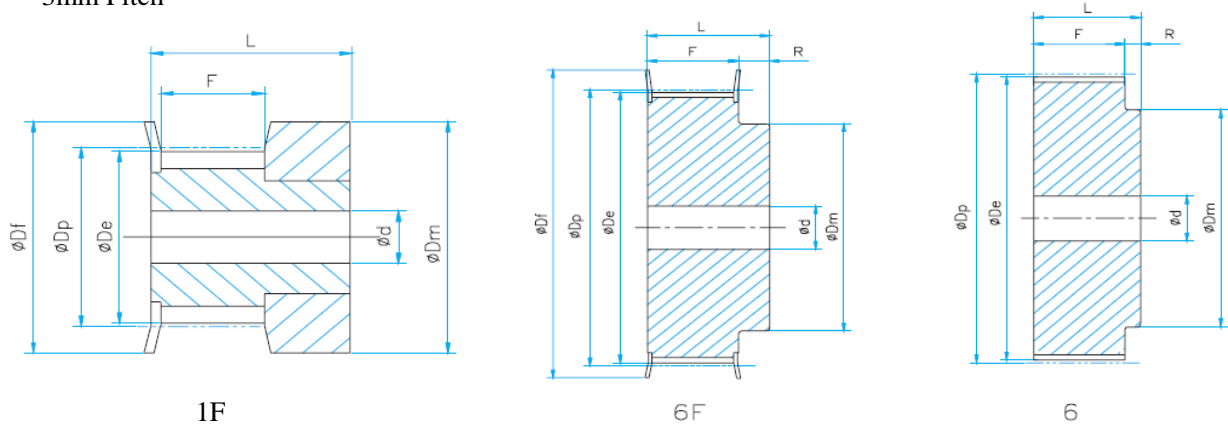

\*All dimensions are mm

Part No.	Teeth No.	Confi.	Material	Dp	De	Df	Hub Dia. Dm	Width F	Length L	Bore d	Flange Dimension
10-3M-06	10	1F	AL	9.55	8.79	13	13	7.2	14.5	-	13.0x6.0x0.5
12-3M-06	12	1F		11.46	10.70	15	15	7.2	14.5	-	15.0x8.0x0.5
14-3M-06	14	1F		13.37	12.61	16	16	7.2	14.5	-	16.0x9.5x0.5
15-3M-06	15	1F		14.32	13.56	17.5	17.5	7.2	14.5	-	17.5x10.5x0.5
16-3M-06	16	6F		15.28	14.52	17.5	10	9.8	17.5	-	17.5x11.6x0.5
18-3M-06	18	6F		17.19	16.43	20	11	9.8	17.5	-	20.0x12.2x0.5
20-3M-06	20	6F		19.10	18.34	23	13	9.8	17.5	-	23.0x14.0x0.5
21-3M-06	21	6F		20.05	19.29	25	13	9.8	17.5	-	25.0x15.0x0.5
22-3M-06	22	6F		21.01	20.25	25	13	9.8	17.5	-	25.0x15.0x0.5
24-3M-06	24	6F		22.92	22.16	25	13	9.8	17.5	-	25.0x15.0x0.5
26-3M-06	26	6F		24.83	24.07	28	16	9.8	17.5	-	28.0x20.0x0.5
28-3M-06	28	6F		26.74	25.98	32	18	9.8	17.5	-	32.0x23.0x0.5
30-3M-06	30	6F		28.65	27.89	32	20	9.8	17.5	-	32.0x23.0x0.5
32-3M-06	32	6F		30.56	29.80	36	22	9.8	17.5	-	36.0x25.0x0.5
36-3M-06	36	6F		34.38	33.62	39	26	10.3	18	-	39.0x28.0x0.5
40-3M-06	40	6F		38.20	37.44	42	28	10.3	18	-	42.0x30.5x0.5
44-3M-06	44	6F		42.02	41.26	48	33	10.3	18	-	48.0x37.0x0.5
48-3M-06	48	6		45.84	45.08	-	33	10.3	18.6	8	-
60-3M-06	60	6		57.30	56.54	-	33	10.3	18.6	8	-
72-3M-06	72	6	68.75	67.99	-	33	10.3	18.6	8	-	

Note: 1, Setscrew hole available with request; finished bore with keyway & setscrews available with request;

2, Center hole provided if there is no bore size listed;

3, Flange dimension: O.D.x I.D.x Thickness.

## Timing Pulley HTD 3M-09

HTD 3mm Pitch for 9mm width belt

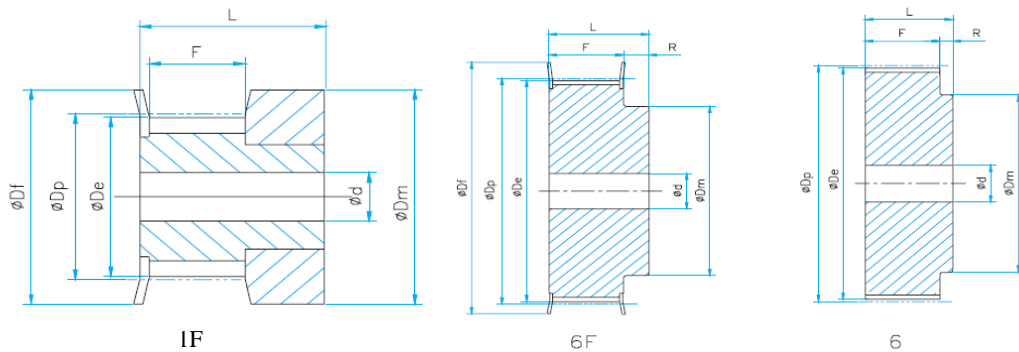

**Note:**

- 1, Setscrew hole available with request; finished bore with keyway & setscrews available with request;
- 2, Center hole provided if there is no bore size listed;
- 3, Flange dimension: O.D.x I.D.x Thickness.

\*All dimensions are mm

Part No.	Teeth No.	Config.	Material	Dp	De	Df	Hub Dia. Dm	Width F	Length L	Bore d	Flange Dimension
10-3M-09	10	1F	AL	9.55	8.79	13	13	10.2	17.5	-	13.0x6.0x0.5
12-3M-09	12	1F		11.46	10.70	15	15	10.2	17.5	-	15.0x8.0x0.5
14-3M-09	14	1F		13.37	12.61	16	16	10.2	17.5	-	16.0x9.5x0.5
15-3M-09	15	1F		14.32	13.56	17.5	17.5	10.2	17.5	-	17.5x10.5x0.5
16-3M-09	16	6F		15.28	14.52	17.5	10	12.8	20.6	-	17.5x11.6x0.5
18-3M-09	18	6F		17.19	16.43	20	10.6	12.8	20.6	-	20.0x12.2x0.5
20-3M-09	20	6F		19.10	18.34	23	12.4	12.8	20.6	-	23.0x14.0x0.5
21-3M-09	21	6F		20.05	19.29	25	13	12.8	20.6	-	25.0x15.0x0.5
22-3M-09	22	6F		21.01	20.25	25	13	12.8	20.6	-	25.0x15.0x0.5
24-3M-09	24	6F		22.92	22.16	25	13	12.8	20.6	-	25.0x15.0x0.5
26-3M-09	26	6F		24.83	24.07	28	16	12.8	20.6	-	28.0x20.0x0.5
28-3M-09	28	6F		26.74	25.98	32	18	12.8	20.6	-	32.0x23.0x0.5
30-3M-09	30	6F		28.65	27.89	32	20	12.8	20.6	-	32.0x23.0x0.5
32-3M-09	32	6F		30.56	29.80	36	22	12.8	20.6	-	36.0x25.0x0.5
36-3M-09	36	6F		34.38	33.62	39	26	13.4	22.2	-	39.0x28.0x0.5
40-3M-09	40	6F		38.20	37.44	42	28	13.4	22.2	-	42.0x30.5x0.5
44-3M-09	44	6F		42.02	41.26	48	33	13.4	22.2	-	48.0x37.0x0.5
48-3M-09	48	6		45.84	45.08	-	33	13.4	22.2	8	-
60-3M-09	60	6	57.30	56.54	-	33	13.4	22.2	8	-	
72-3M-09	72	6	68.75	67.99	-	33	13.4	22.2	8	-	

## Timing Pulley HTD 3M-15

3mm Pitch

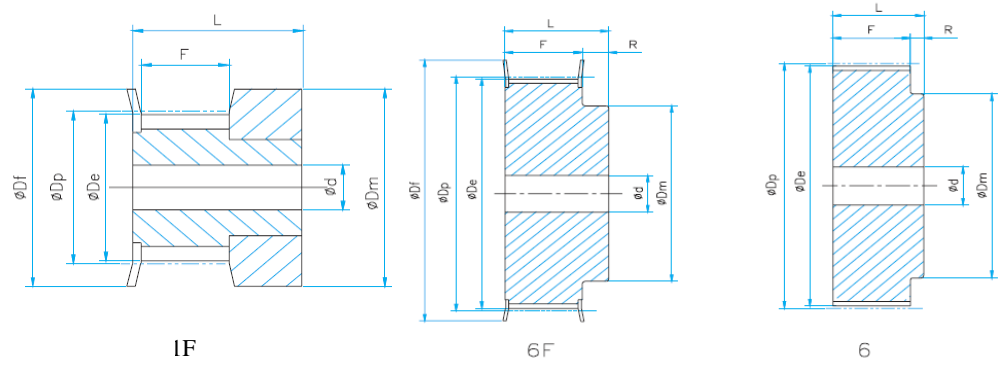

**Note:**

- 1, Setscrew hole available with request; finished bore with keyway & setscrews available with request;
- 2, Center hole provided if there is no bore size listed;
- 3, Flange dimension: O.D.x I.D.x Thickness.

\*All dimensions are mm

Part No.	Teeth No.	Config.	Material	Dp	De	Df	Hub Dia. Dm	Width F	Length L	Bore d	Flange Dimension
10-3M-15	10	1F	AL	9.55	8.79	13	13	17	26	-	13.0x6.0x0.5
12-3M-15	12	1F		11.46	10.70	15	15	17	26	-	15.0x8.0x0.5
14-3M-15	14	1F		13.37	12.61	16	16	17	26	-	16.0x9.5x0.5
15-3M-15	15	1F		14.32	13.56	17.5	17.5	17	26	-	17.5x10.5x0.5
16-3M-15	16	6F		15.28	14.52	17.5	10	19.5	26	-	17.5x11.6x0.5
18-3M-15	18	6F		17.19	16.43	20	10.6	19.5	26	-	20.0x12.2x0.5
20-3M-15	20	6F		19.10	18.34	23	12.4	19.5	26	-	23.0x14.0x0.5
21-3M-15	21	6F		20.05	19.29	25	13	19.5	26	-	25.0x15.0x0.5
22-3M-15	22	6F		21.01	20.25	25	13	19.5	26	-	25.0x15.0x0.5
24-3M-15	24	6F		22.92	22.16	25	13	19.5	26	-	25.0x15.0x0.5
26-3M-15	26	6F		24.83	24.07	28	16	19.5	26	-	28.0x20.0x0.5
28-3M-15	28	6F		26.74	25.98	32	18	19.5	26	-	32.0x23.0x0.5
30-3M-15	30	6F		28.65	27.89	32	20	19.5	26	-	32.0x23.0x0.5
32-3M-15	32	6F		30.56	29.80	36	22	19.5	26	-	36.0x25.0x0.5
36-3M-15	36	6F		34.38	33.62	39	26	20	30	-	39.0x28.0x0.5
40-3M-15	40	6F		38.20	37.44	42	28	20	30	-	42.0x30.5x0.5
44-3M-15	44	6F		42.02	41.26	48	33	20	30	-	48.0x37.0x0.5
48-3M-15	48	6		45.84	45.08	-	33	20	30	8	-
60-3M-15	60	6		57.30	56.54	-	33	20	30	8	-
72-3M-15	72	6		68.75	67.99	-	33	20	30	8	-

## Timing Pulley HTD 5M-09

5mm Pitch

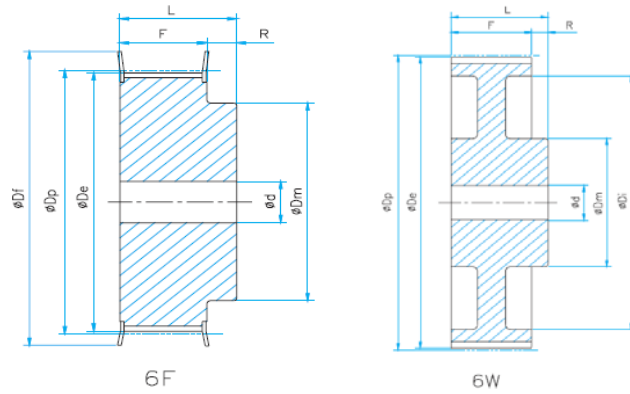

**Note:**

- 1, Setscrew hole available with request; finished bore with keyway & setscrews available with request;
- 2, Center hole provided if there is no bore size listed;
- 3, Flange dimension: O.D.x I.D.x Thickness.

\*All dimensions are mm

Part No.	Teeth No.	Config.	Material	Dp	De	Df	Hub Dia. Dm	Di	Width F	Length L	Bore d	Flange Dimension
12-5M-09	12	6F	STEEL	19.10	17.96	23	12	-	14.5	20	-	23.0x14.0x1.0
14-5M-09	14	6F		22.28	21.14	25	13	-	14.5	20	-	25.0x15.0x1.0
15-5M-09	15	6F		23.87	22.73	28	16	-	14.5	20	-	28.0x17.8x1.0
16-5M-09	16	6F		25.46	24.32	28	16.2	-	14.5	20	-	28.0x17.8x1.0
18-5M-09	18	6F		28.65	27.51	32	20	-	14.5	20	-	32.0x23.0x1.0
20-5M-09	20	6F		31.83	30.69	36	23	-	14.5	22.5	-	36.0x25.0x1.0
21-5M-09	21	6F		33.42	32.28	38	24	-	14.5	22.5	-	38.0x26.5x1.0
22-5M-09	22	6F		35.01	33.87	39	25.5	-	14.5	22.5	-	39.0x28.0x1.0
24-5M-09	24	6F		38.20	37.06	42	27	-	14.5	22.5	-	42.0x30.5x1.0
26-5M-09	26	6F		41.38	40.24	44	30	-	14.5	22.5	-	44.0x32.5x1.0
28-5M-09	28	6F		44.56	43.42	48	30.5	-	14.5	22.5	-	48.0x37.0x1.0
30-5M-09	30	6F		47.75	46.60	51	35	-	14.5	22.5	-	51.0x40.0x1.0
32-5M-09	32	6F		50.93	49.79	54	38	-	14.5	22.5	8	54.0x43.0x1.0
36-5M-09	36	6F		57.30	56.16	60	38	-	14.5	22.5	8	60.0x47.0x1.0
40-5M-09	40	6F	63.66	62.52	71	38	-	14.5	22.5	8	71.0x56.0x1.0	
44-5M-09	44	6W	AL	70.03	68.89	-	38	54	14.5	25.5	8	-
48-5M-09	48	6W		76.39	75.25	-	45	61	14.5	25.5	8	-
60-5M-09	60	6W		95.49	94.35	-	45	80	14.5	25.5	8	-
72-5M-09	72	6W		114.59	113.45	-	45	100	14.5	25.5	8	-

## Timing Pulley HTD 5M-15

5mm Pitch

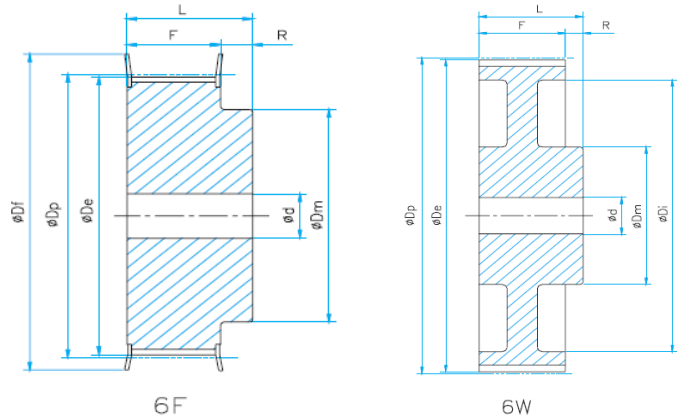

**Note:**

- 1, Setscrew hole available with request; finished bore with keyway & setscrews available with request;
- 2, Center hole provided if there is no bore size listed;
- 3, Flange dimension: O.D.x I.D.x Thickness.

\*All dimensions are mm

Part No.	Teeth No.	Config.	Material	Dp	De	Df	Hub Dia. Dm	Di	Width F	Length L	Bore d	Flange Dimension
12-5M-15	12	6F	STEEL	19.10	17.96	23	12	-	20.5	26	-	23.0x14.0x1.0
14-5M-15	14	6F		22.28	21.14	25	13	-	20.5	26	-	25.0x15.0x1.0
15-5M-15	15	6F		23.87	22.73	28	16	-	20.5	26	-	28.0x17.8x1.0
16-5M-15	16	6F		25.46	24.32	28	16.2	-	20.5	26	-	28.0x17.8x1.0
18-5M-15	18	6F		28.65	27.51	32	20	-	20.5	26	-	32.0x23.0x1.0
20-5M-15	20	6F		31.83	30.69	36	23	-	20.5	26	-	36.0x25.0x1.0
21-5M-15	21	6F		33.42	32.28	38	24	-	20.5	26	-	38.0x26.5x1.0
22-5M-15	22	6F		35.01	33.87	39	25.5	-	20.5	26	-	39.0x28.0x1.0
24-5M-15	24	6F		38.20	37.06	42	27	-	20.5	28	-	42.0x30.5x1.0
26-5M-15	26	6F		41.38	40.24	44	30	-	20.5	28	-	44.0x32.5x1.0
28-5M-15	28	6F		44.56	43.42	48	30.5	-	20.5	28	-	48.0x37.0x1.0
30-5M-15	30	6F		47.75	46.60	51	35	-	20.5	28	-	51.0x40.0x1.0
32-5M-15	32	6F		50.93	49.79	54	38	-	20.5	28	8	54.0x43.0x1.0
36-5M-15	36	6F		57.30	56.16	60	38	-	20.5	28	8	60.0x47.0x1.0
40-5M-15	40	6F	63.66	62.52	71	38	-	20.5	28	8	71.0x56.0x1.0	
44-5M-15	44	6W	AL	70.03	68.89	-	38	54	20.5	30	8	-
48-5M-15	48	6W		76.39	75.25	-	45	61	20.5	30	8	-
60-5M-15	60	6W		95.49	94.35	-	45	80	20.5	30	8	-
72-5M-15	72	6W		114.59	113.45	-	45	100	20.5	30	8	-

## Timing Pulley HTD 5M-25

5mm Pitch

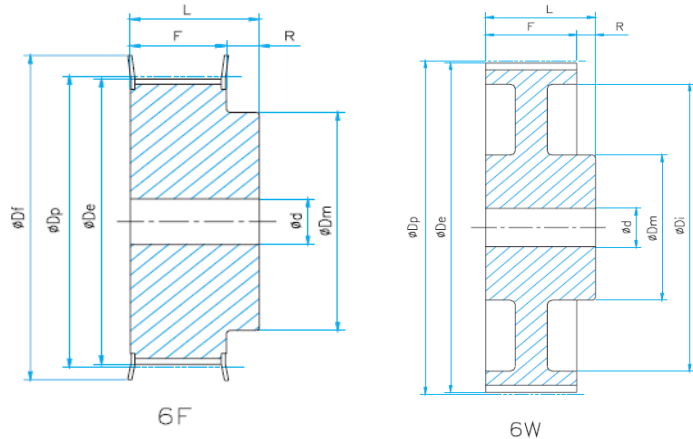

**Note:**

- 1, Setscrew hole available with request; finished bore with keyway & setscrews available with request;
- 2, Center hole provided if there is no bore size listed;
- 3, Flange dimension: O.D.x I.D.x Thickness.

\*All dimensions are mm

Part No.	Teeth No.	Config.	Material	Dp	De	Df	Hub Dia. Dm	Di	Width F	Length L	Bore d	Flange Dimension
12-5M-25	12	6F	STEEL	19.10	17.96	23	12	-	30.5	36	-	23.0x14.0x1.0
14-5M-25	14	6F		22.28	21.14	25	13	-	30.5	36	-	25.0x15.0x1.0
15-5M-25	15	6F		23.87	22.73	28	16	-	30.5	36	-	28.0x17.8x1.0
16-5M-25	16	6F		25.46	24.32	28	16.5	-	30.5	36	-	28.0x17.8x1.0
18-5M-25	18	6F		28.65	27.51	32	20	-	30.5	36	-	32.0x23.0x1.0
20-5M-25	20	6F		31.83	30.69	36	23	-	30.5	36	-	36.0x25.0x1.0
21-5M-25	21	6F		33.42	32.28	38	24	-	30.5	38.5	-	38.0x26.5x1.0
22-5M-25	22	6F		35.01	33.87	39	25.5	-	30.5	38.5	-	39.0x28.0x1.0
24-5M-25	24	6F		38.20	37.06	42	27	-	30.5	38.5	-	42.0x30.5x1.0
26-5M-25	26	6F		41.38	40.24	44	30	-	30.5	38.5	-	44.0x32.5x1.0
28-5M-25	28	6F		44.56	43.42	48	30.5	-	30.5	38.5	-	48.0x37.0x1.0
30-5M-25	30	6F		47.75	46.60	51	35	-	30.5	38.5	-	51.0x40.0x1.0
32-5M-25	32	6F		50.93	49.79	54	38	-	30.5	38.5	8	54.0x43.0x1.0
36-5M-25	36	6F		57.30	56.16	60	38	-	30.5	38.5	8	60.0x47.0x1.0
40-5M-25	40	6F	63.66	62.52	71	38	-	30.5	38.5	8	71.0x56.0x1.0	
44-5M-25	44	6W	AL	70.03	68.89	-	38	54	30.5	40.5	8	-
48-5M-25	48	6W		76.39	75.25	-	45	61	30.5	40.5	8	-
60-5M-25	60	6W		95.49	94.35	-	45	80	30.5	40.5	8	-
72-5M-25	72	6W		114.59	113.45	-	45	100	30.5	40.5	8	-

## Timing Pulley HTD 8M-20

8mm Pitch

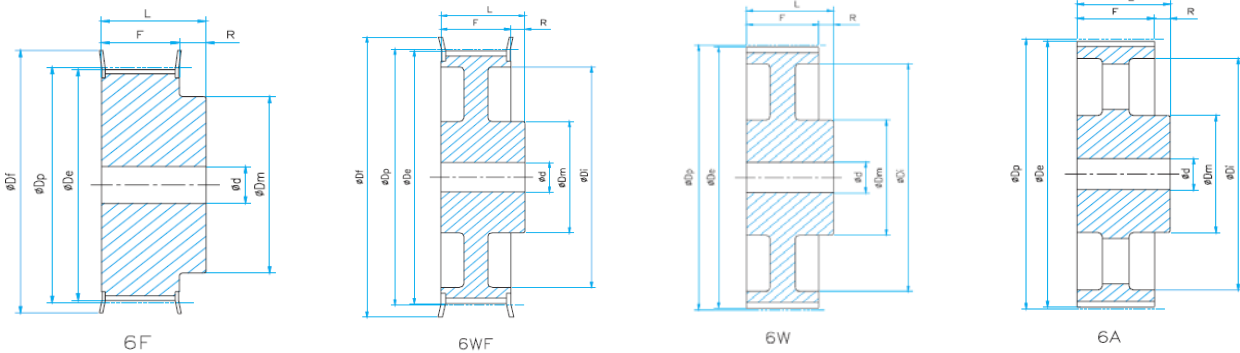

Part No.	Teeth No.	Config.	Material	Dp	De	Df	Hub Dia. Dm	Di	Width F	Length L	Bore d	Flange Dimension
22-8M-20	22	6F	STEEL	56.02	54.65	60	43	-	28	38	12	60.0x47.0x1.5
24-8M-20	24	6F		61.12	59.75	66	45	-	28	38	12	66.0x52.0x1.5
26-8M-20	26	6F		66.21	64.84	70	48	-	28	38	12	70.0x53.0x1.5
28-8M-20	28	6F		71.30	69.93	75	50	-	28	38	15	75.0x60.0x1.5
30-8M-20	30	6F		76.39	75.02	83	55	-	28	38	15	83.0x68.0x1.5
32-8M-20	32	6F		81.49	80.12	87	60	-	28	38	15	87.0x72.0x1.5
34-8M-20	34	6F		86.58	85.22	91	70	-	28	38	15	91.0x73.0x1.5
36-8M-20	36	6F		91.67	90.30	97	75	-	28	38	15	97.0x79.0x1.5
38-8M-20	38	6F		96.77	95.39	102	75	-	28	38	15	102.0x82.5x1.5
40-8M-20	40	6F		101.86	100.49	106	75	-	28	38	15	106.0x90.0x1.5
44-8M-20	44	6F		112.05	110.67	120	75	-	28	38	15	120.0x99.5x1.5
48-8M-20	48	6F		122.23	120.86	128	75	-	28	38	15	128.0x107.0x1.5
56-8M-20	56	6WF		142.60	141.23	150	80	116	28	38	15	150.0x130.0x1.5
64-8M-20	64	6WF		162.97	161.60	168	80	137	28	38	15	168.0x148.0x1.5
72-8M-20	72	6WF	183.35	181.97	192	80	158	28	38	15	192.0x173.0x1.5	
80-8M-20	80	6W	CAST IRON	203.72	202.35	-	90	180	28	38	15	-
90-8M-20	90	6A		229.18	227.81	-	90	204	28	38	15	-
112-8M-20	112	6A		285.21	283.83	-	90	254	28	38	18	-
144-8M-20	144	6A		366.69	365.32	-	90	336	28	38	20	-
168-8M-20	168	6A		427.81	426.44	-	100	400	28	38	20	-
192-8M-20	192	6A		488.92	487.55	-	100	460	28	38	20	-

**Note:**

\*All dimensions are mm

- 1, Setscrew hole available with request; finished bore with keyway & setscrews available with request;
- 2, Center hole provided if there is no bore size listed;
- 3, Flange dimension: O.D.x I.D.x Thickness.

## Timing Pulley HTD 8M-30

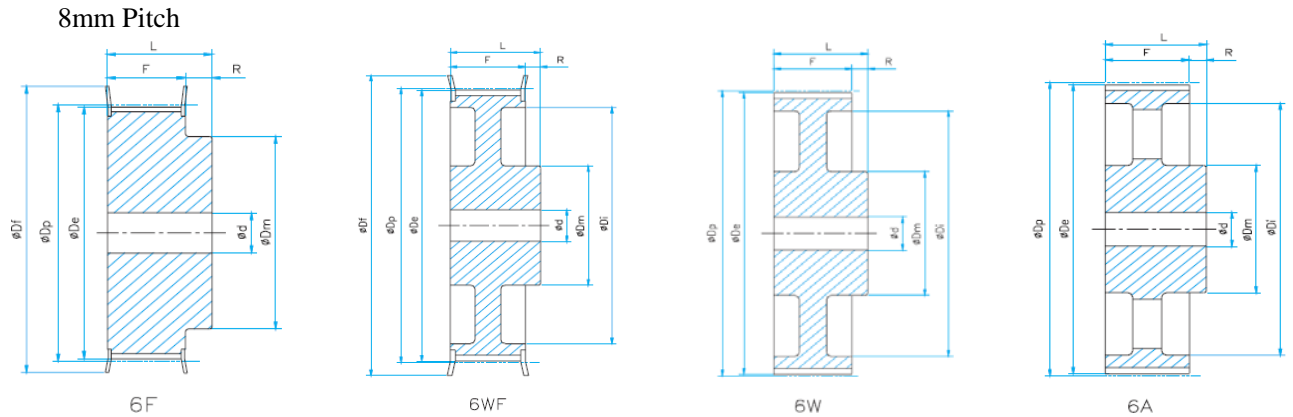

Part No.	Teeth No.	Config.	Material	Dp	De	Df	Hub Dia. Dm	Di	Width F	Length L	Bore d	Flange Dimension
22-8M-30	22	6F	STEEL	56.02	54.65	60	43	-	38	48	12	60.0x47.0x1.5
24-8M-30	24	6F		61.12	59.75	66	45	-	38	48	12	66.0x52.0x1.5
26-8M-30	26	6F		66.21	64.84	70	48	-	38	48	12	70.0x53.0x1.5
28-8M-30	28	6F		71.30	69.93	75	50	-	38	48	15	75.0x60.0x1.5
30-8M-30	30	6F		76.39	75.02	83	55	-	38	48	15	83.0x68.0x1.5
32-8M-30	32	6F		81.49	80.12	87	60	-	38	48	15	87.0x72.0x1.5
34-8M-30	34	6F		86.58	85.22	91	70	-	38	48	15	91.0x73.0x1.5
36-8M-30	36	6F		91.67	90.30	97	75	-	38	48	15	97.0x79.0x1.5
38-8M-30	38	6F		96.77	95.39	102	75	-	38	48	15	102.0x82.5x1.5
40-8M-30	40	6F		101.86	100.49	106	75	-	38	48	15	106.0x90.0x1.5
44-8M-30	44	6F		112.05	110.67	120	75	-	38	48	15	120.0x99.5x1.5
48-8M-30	48	6F		122.23	120.86	128	75	-	38	48	15	128.0x107.0x1.5
56-8M-30	56	6WF		142.60	141.23	150	90	116	38	48	15	150.0x130.0x1.5
64-8M-30	64	6WF	162.97	161.60	168	90	137	38	48	15	168.0x148.0x1.5	
72-8M-30	72	6WF	183.35	181.97	192	95	158	38	48	15	192.0x173.0x1.5	
80-8M-30	80	6W	CAST IRON	203.72	202.35	-	100	180	38	48	15	-
90-8M-30	90	6A		229.18	227.81	-	100	204	38	48	15	-
112-8M-30	112	6A		285.21	283.83	-	100	254	38	48	18	-
144-8M-30	144	6A		366.69	365.32	-	100	336	38	48	20	-
168-8M-30	168	6A		427.81	426.44	-	100	400	38	48	20	-
192-8M-30	192	6A		488.92	487.55	-	100	460	38	48	20	-

**Note:**

- 1, Finished bore available with request;
- 2, Center hole provided if there is no bore size listed;
- 3, Flange dimension: O.D.x I.D.x Thickness.

\*All dimensions are mm



## Timing Pulley HTD 8M-50

8mm Pitch

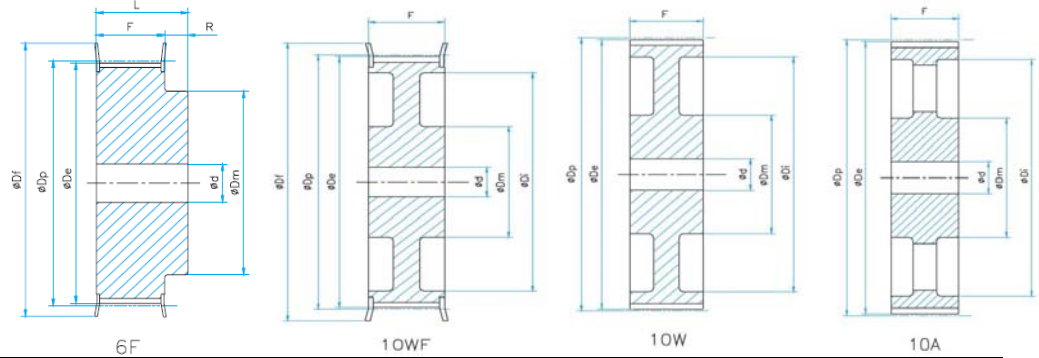

Part No.	Teeth No.	Config.	Material	Dp	De	Df	Hub Dia. Dm	Di	Width F	Length L	Bore d	Flange Dimension
22-8M-50	22	6F	STEEL	56.02	54.65	60	43	-	60	70	12	60.0x47.0x1.5
24-8M-50	24	6F		61.12	59.75	66	45	-	60	70	12	66.0x52.0x1.5
26-8M-50	26	6F		66.21	64.84	70	48	-	60	70	15	70.0x53.0x1.5
28-8M-50	28	6F		71.30	69.93	75	50	-	60	70	15	75.0x60.0x1.5
30-8M-50	30	6F		76.39	75.02	83	55	-	60	70	15	83.0x68.0x1.5
32-8M-50	32	6F		81.49	80.12	87	60	-	60	70	15	87.0x72.0x1.5
34-8M-50	34	6F		86.58	85.22	91	70	-	60	70	15	91.0x73.0x1.5
36-8M-50	36	6F		91.67	90.30	97	75	-	60	70	15	97.0x79.0x1.5
38-8M-50	38	6F		96.77	95.39	102	75	-	60	70	15	102.0x82.5x1.5
40-8M-50	40	6F		101.86	100.49	106	75	-	60	70	18	106.0x90.0x1.5
44-8M-50	44	6F		112.05	110.67	120	75	-	60	70	18	120.0x99.5x1.5
48-8M-50	48	6F		122.23	120.86	128	75	-	60	70	18	128.0x107.0x1.5
56-8M-50	56	10WF		142.60	141.23	150	90	116	60	60	18	150.0x130.0x1.5
64-8M-50	64	10WF		162.97	161.60	168	90	137	60	60	18	168.0x148.0x1.5
72-8M-50	72	10WF	183.35	181.97	192	100	158	60	60	18	192.0x173.0x1.5	
80-8M-50	80	10W	CAST IRON	203.72	202.35	-	110	180	60	60	18	-
90-8M-50	90	10A		229.18	227.81	-	110	204	60	60	18	-
112-8M-50	112	10A		285.21	283.83	-	110	254	60	60	18	-
144-8M-50	144	10A		366.69	365.32	-	110	336	60	60	20	-
168-8M-50	168	10A		427.81	426.44	-	120	400	60	60	20	-
192-8M-50	192	10A		488.92	487.55	-	130	460	60	60	20	-

**Note:**

\*All dimensions are mm

- 1, Finished bore available with request;
- 2, Center hole provided if there is no bore size listed;
- 3, Flange dimension: O.D.x I.D.x Thickness.

## Timing Pulley HTD 8M-85

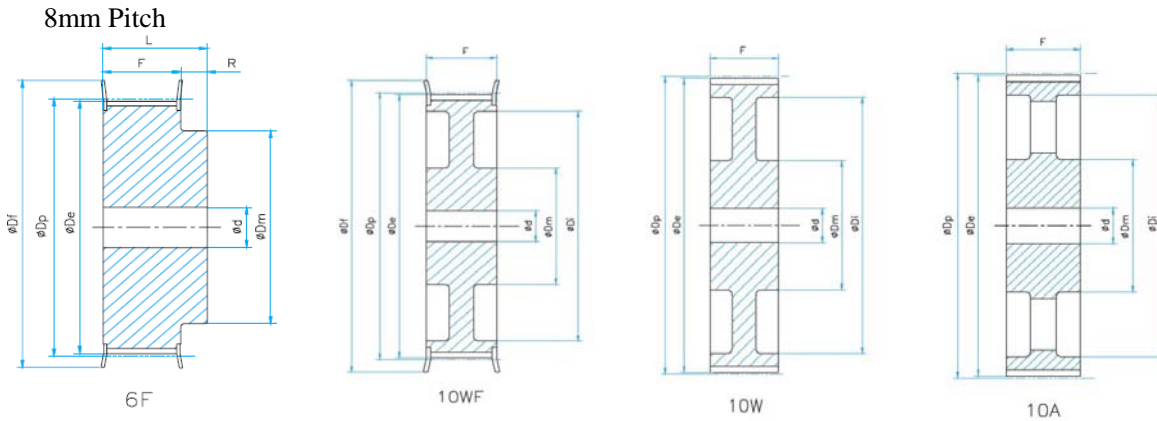

Part No.	Teeth No.	Config.	Material	Dp	De	Df	Hub Dia. Dm	Di	Width F	Length L	Bore d	Flange Dimension
22-8M-85	22	6F	STEEL	56.02	54.65	60	43	-	95	105	12	60.0x47.0x1.5
24-8M-85	24	6F		61.12	59.75	66	45	-	95	105	12	66.0x52.0x1.5
26-8M-85	26	6F		66.21	64.84	70	48	-	95	105	12	70.0x53.0x1.5
28-8M-85	28	6F		71.30	69.93	75	50	-	95	105	15	75.0x60.0x1.5
30-8M-85	30	6F		76.39	75.02	83	55	-	95	105	15	83.0x68.0x1.5
32-8M-85	32	6F		81.49	80.12	87	60	-	95	105	15	87.0x72.0x1.5
34-8M-85	34	6F		86.58	85.22	91	66	-	95	105	15	91.0x73.0x1.5
36-8M-85	36	6F		91.67	90.30	97	70	-	95	105	15	97.0x79.0x1.5
38-8M-85	38	6F		96.77	95.39	102	75	-	95	105	15	102.0x82.5x1.5
40-8M-85	40	6F		101.86	100.49	106	75	-	95	105	18	106.0x90.0x1.5
44-8M-85	44	6F		112.05	110.67	120	75	-	95	105	18	120.0x99.5x1.5
48-8M-85	48	6F		122.23	120.86	128	80	-	95	105	18	128.0x107.0x1.5
56-8M-85	56	6F		142.60	141.23	150	90	-	95	105	18	150.0x130.0x1.5
64-8M-85	64	10WF		162.97	161.60	168	100	137	95	95	20	168.0x148.0x1.5
72-8M-85	72	10WF	183.35	181.97	192	100	158	95	95	20	192.0x173.0x1.5	
80-8M-85	80	10W	CAST IRON	203.72	202.35	-	110	180	95	95	20	-
90-8M-85	90	10A		229.18	227.81	-	110	204	95	95	20	-
112-8M-85	112	10A		285.21	283.83	-	110	254	95	95	24	-
144-8M-85	144	10A		366.69	365.32	-	110	336	95	95	24	-
168-8M-85	168	10A		427.81	426.44	-	120	400	95	95	24	-
192-8M-85	192	10A		488.92	487.55	-	130	460	95	95	24	-

**Note:**

\*All dimensions are mm

- 1, Finished bore available with request;
- 2, Center hole provided if there is no bore size listed;
- 3, Flange dimension: O.D.x I.D.x Thickness.

## Timing Pulley HTD 14M-40

14mm Pitch

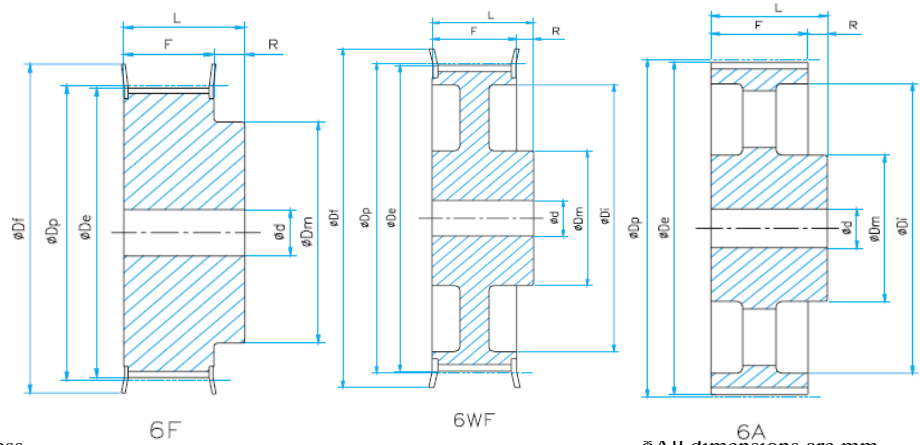

**Note:**

- 1, Finished bore available with request;
- 2, Flange dimension: O.D.x I.D.x Thickness.

\*All dimensions are mm

Part No.	Teeth No.	Config.	Material	Dp	De	Df	Hub Dia. Dm	Di	Width F	Length L	Bore d	Flange Dimension
28-14M-40	28	6F	STEEL	124.78	122.12	128	100	-	54	69	24	128.0x107.0x2.5
29-14M-40	29	6F		129.23	126.57	138	100	-	54	69	24	138.0x112.0x2.5
30-14M-40	30	6F		133.69	130.99	138	100	-	54	69	24	138.0x112.0x2.5
32-14M-40	32	6F		142.60	139.88	154	100	-	54	69	24	154.0x122.0x2.5
34-14M-40	34	6F		151.52	148.79	160	100	-	54	69	24	160.0x130.0x2.5
36-14M-40	36	6F		160.43	157.68	168	100	-	54	69	24	168.0x135.0x2.5
38-14M-40	38	6F		169.34	166.60	183	120	-	54	69	24	183.0x145.0x2.5
40-14M-40	40	6F		178.25	175.49	188	120	-	54	69	24	188.0x150.0x2.5
44-14M-40	44	6F		196.08	193.28	211	120	-	54	69	24	211.0x173.0x2.5
48-14M-40	48	6WF		213.90	211.11	226	135	170	54	69	24	226.0x190.0x2.5
56-14M-40	56	6WF	249.55	246.76	256	135	207	54	69	28	256.0x225.0x2.5	
64-14M-40	64	6WF	285.21	282.41	296	135	240	54	69	28	296.0x260.0x2.5	
72-14M-40	72	6A	CAST IRON	320.86	318.06	-	135	280	54	69	28	-
80-14M-40	80	6A		356.51	353.71	-	135	314	54	69	28	-
90-14M-40	90	6A		401.07	398.28	-	135	358	54	69	28	-
112-14M-40	112	6A		499.11	496.32	-	135	456	54	69	28	-
144-14M-40	144	6A		641.71	638.92	-	135	600	54	69	28	-
168-14M-40	168	6A		748.66	745.87	-	135	706	54	69	28	-
192-14M-40	192	6A		855.62	852.82	-	135	813	54	69	28	-
216-14M-40	216	6A		962.57	959.76	-	150	920	54	69	28	-

## Timing Pulley HTD 14M-55

14mm Pitch

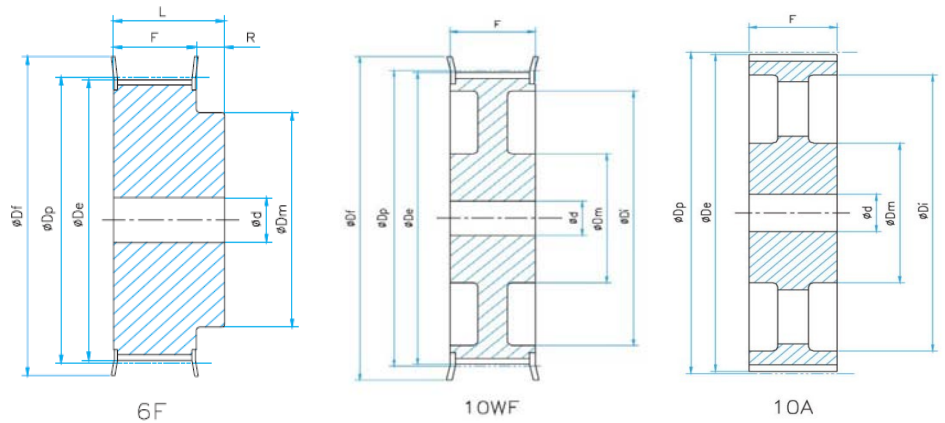

**Note:**

- 1, Finished bore available with request;
- 2, Flange dimension: O.D.x I.D.x Thickness.

\*All dimensions are mm

Part No.	Teeth No.	Config.	Material	Dp	De	Df	Hub Dia. Dm	Di	Width F	Length L	Bore d	Flange Dimension
28-14M-55	28	6F	STEEL	124.78	121.99	128	100	-	70	85	24	128.0x107.0x2.5
29-14M-55	29	6F		129.23	126.44	138	100	-	70	85	24	138.0x112.0x2.5
30-14M-55	30	6F		133.69	130.99	138	100	-	70	85	24	138.0x112.0x2.5
32-14M-55	32	6F		142.60	139.88	154	100	-	70	85	24	154.0x122.0x2.5
34-14M-55	34	6F		151.52	148.79	160	100	-	70	85	24	160.0x130.0x2.5
36-14M-55	36	6F		160.43	157.68	168	100	-	70	85	24	168.0x135.0x2.5
38-14M-55	38	6F		169.34	166.60	183	120	-	70	85	24	183.0x145.0x2.5
40-14M-55	40	6F		178.25	175.49	188	120	-	70	85	24	188.0x150.0x2.5
44-14M-55	44	6F		196.08	193.28	211	120	-	70	85	24	211.0x173.0x2.5
48-14M-55	48	10WF	CAST IRON	213.90	211.11	226	135	170	70	70	24	226.0x190.0x2.5
56-14M-55	56	10WF		249.55	246.76	256	135	207	70	70	28	256.0x225.0x2.5
64-14M-55	64	10WF		285.21	282.41	296	135	240	70	70	28	296.0x260.0x2.5
72-14M-55	72	10A		320.86	318.06	-	135	280	70	70	28	-
80-14M-55	80	10A		356.51	353.71	-	135	314	70	70	28	-
90-14M-55	90	10A		401.07	398.28	-	135	358	70	70	28	-
112-14M-55	112	10A		499.11	496.32	-	135	456	70	70	28	-
144-14M-55	144	10A		641.71	638.92	-	135	600	70	70	28	-
168-14M-55	168	10A		748.66	745.87	-	135	706	70	70	28	-
192-14M-55	192	10A		855.62	852.82	-	135	813	70	70	28	-
216-14M-55	216	10A		962.57	959.76	-	150	920	70	70	28	-

## Timing Pulley HTD 14M-85

14mm Pitch

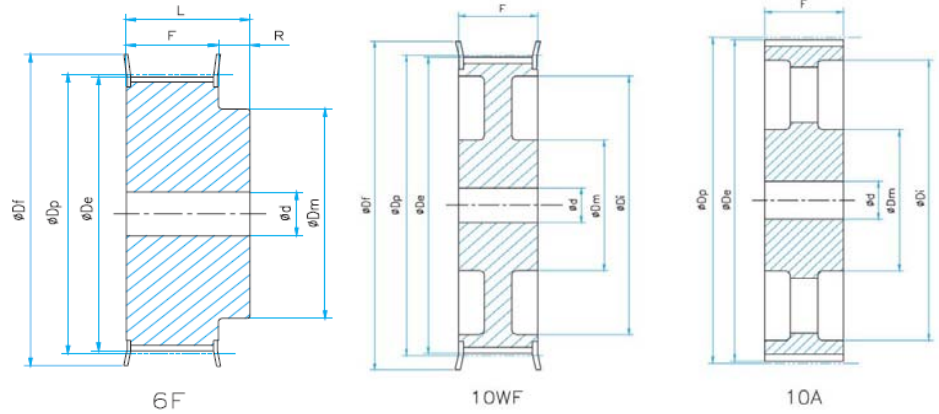

**Note:**

1, Finished bore available with request;

3, Flange dimension: O.D.x I.D.x Thickness.

\*All dimensions are mm

Part No.	Teeth No.	Config.	Material	Dp	De	Df	Hub Dia. Dm	Di	Width F	Length L	Bore d	Flange Dimension
28-14M-85	28	6F	STEEL	124.78	122.12	128	100	-	102	117	24	128.0x107.0x2.5
29-14M-85	29	6F		129.23	126.57	138	100	-	102	117	24	138.0x112.0x2.5
30-14M-85	30	6F		133.69	130.99	138	100	-	102	117	24	138.0x112.0x2.5
32-14M-85	32	6F		142.60	139.88	154	100	-	102	117	24	154.0x122.0x2.5
34-14M-85	34	6F		151.52	148.79	160	100	-	102	117	24	160.0x130.0x2.5
36-14M-85	36	6F		160.43	157.68	168	100	-	102	117	32	168.0x135.0x2.5
38-14M-85	38	6F		169.34	166.60	183	120	-	102	117	32	183.0x145.0x2.5
40-14M-85	40	6F		178.25	175.49	188	135	-	102	117	32	188.0x150.0x2.5
44-14M-85	44	6F		196.08	193.28	211	135	-	102	117	32	211.0x173.0x2.5
48-14M-85	48	6F		213.90	211.11	226	150	-	102	117	32	226.0x190.0x2.5
56-14M-85	56	10WF	CAST IRON	249.55	246.76	256	150	207	102	102	32	256.0x225.0x2.5
64-14M-85	64	10WF		285.21	282.41	296	150	240	102	102	32	296.0x260.0x2.5
72-14M-85	72	10A		320.86	318.06	-	150	278	102	102	32	-
80-14M-85	80	10A		356.51	353.71	-	150	314	102	102	32	-
90-14M-85	90	10A		401.07	398.28	-	150	358	102	102	32	-
112-14M-85	112	10A		499.11	496.32	-	150	456	102	102	32	-
144-14M-85	144	10A		641.71	638.92	-	150	600	102	102	32	-
168-14M-85	168	10A		748.66	745.87	-	150	706	102	102	32	-
192-14M-85	192	10A		855.62	852.82	-	165	813	102	102	32	-
216-14M-85	216	10A		962.57	959.76	-	160	920	102	102	32	-

## Timing Pulley HTD 14M-115

14mm Pitch

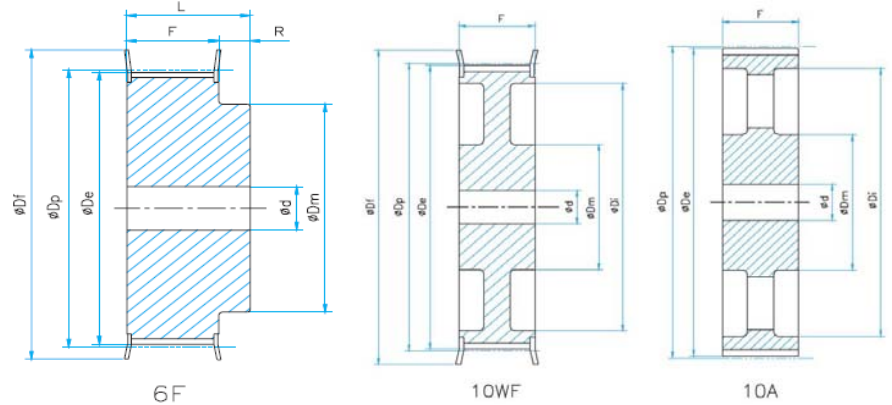

**Note:**

1, Finished bore available with request;

2, Flange dimension: O.D.x I.D.x Thickness.

\*All dimensions are mm

Part No.	Teeth No.	Config.	Material	Dp	De	Df	Hub Dia. Dm	Di	Width F	Length L	Bore d	Flange Dimension
28-14M-115	28	6F	STEEL	124.78	122.12	128	100	-	133	148	32	128.0x107.0x2.5
29-14M-115	29	6F		129.23	126.57	138	100	-	133	148	32	138.0x112.0x2.5
30-14M-115	30	6F		133.69	130.99	138	100	-	133	148	32	138.0x112.0x2.5
32-14M-115	32	6F		142.60	139.88	154	100	-	133	148	32	154.0x122.0x2.5
34-14M-115	34	6F		151.52	148.79	160	100	-	133	148	32	160.0x130.0x2.5
36-14M-115	36	6F		160.43	157.68	168	100	-	133	148	32	168.0x135.0x2.5
38-14M-115	38	6F		169.34	166.60	183	120	-	133	148	32	183.0x145.0x2.5
40-14M-115	40	6F		178.25	175.49	188	135	-	133	148	32	188.0x150.0x2.5
44-14M-115	44	6F		196.08	193.28	211	140	-	133	148	32	211.0x173.0x2.5
48-14M-115	48	6F		213.90	211.11	226	150	-	133	148	32	226.0x190.0x2.5
56-14M-115	56	6F		249.55	246.76	256	150	-	133	148	32	256.0x225.0x2.5
64-14M-115	64	10WF	CAST IRON	285.21	282.41	296	150	240	133	133	32	296.0x260.0x2.5
72-14M-115	72	10A		320.86	318.06	-	150	278	133	133	32	-
80-14M-115	80	10A		356.51	353.71	-	150	314	133	133	32	-
90-14M-115	90	10A		401.07	398.28	-	150	358	133	133	32	-
112-14M-115	112	10A		499.11	496.32	-	150	456	133	133	32	-
144-14M-115	144	10A		641.71	638.92	-	165	600	133	133	32	-
168-14M-115	168	10A		748.66	745.87	-	165	706	133	133	32	-
192-14M-115	192	10A		855.62	852.82	-	165	813	133	133	32	-
216-14M-115	216	10A	962.57	959.76	-	165	920	133	133	32	-	

## Timing Pulley HTD 14M-170

14mm Pitch

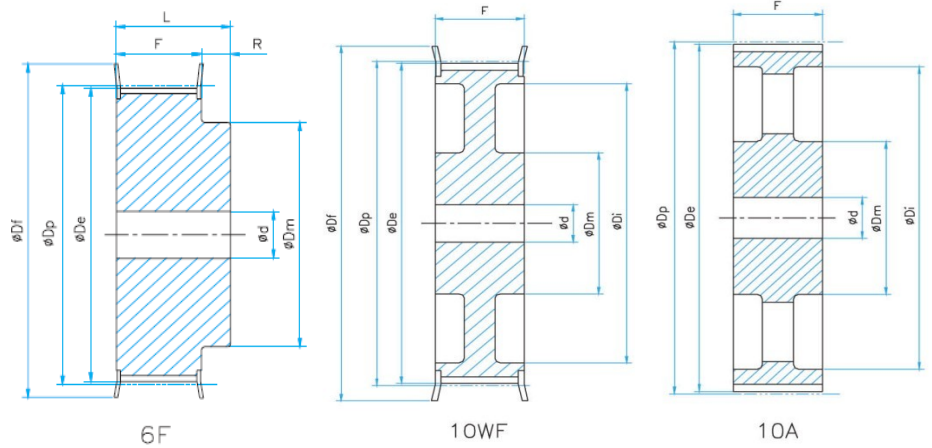

**Note:**

1, Finished bore available with request;

2, Flange dimension: O.D.x I.D.x Thickness.

\*All dimensions are mm

Part No.	Teeth No.	Config.	Material	Dp	De	Df	Hub Dia. Dm	Di	Width F	Length L	Bore d	Flange Dimension
28-14M-170	28	6F	STEEL	124.78	121.12	128	100	-	187	202	32	128.0x107.0x2.5
29-14M-170	29	6F		129.23	126.57	138	100	-	187	202	32	138.0x112.0x2.5
30-14M-170	30	6F		133.69	130.99	138	100	-	187	202	32	138.0x112.0x2.5
32-14M-170	32	6F		142.60	139.88	154	100	-	187	202	32	154.0x122.0x2.5
34-14M-170	34	6F		151.52	148.79	160	100	-	187	202	32	160.0x130.0x2.5
36-14M-170	36	6F		160.43	157.68	168	100	-	187	202	32	168.0x135.0x2.5
38-14M-170	38	6F		169.34	166.60	183	120	-	187	202	32	183.0x145.0x2.5
40-14M-170	40	6F		178.25	175.49	188	135	-	187	202	32	188.0x150.0x2.5
44-14M-170	44	6F		196.08	193.28	211	140	-	187	202	32	211.0x173.0x2.5
48-14M-170	48	6F		213.90	211.11	226	150	-	187	202	32	226.0x190.0x2.5
56-14M-170	56	6F		249.55	246.76	256	150	-	187	202	32	256.0x225.0x2.5
64-14M-170	64	10WF		285.21	282.41	296	150	240	187	187	32	296.0x260.0x2.5
72-14M-170	72	10A		CAST IRON	320.86	318.06	-	150	278	187	187	32
80-14M-170	80	10A	356.51		353.71	-	150	314	187	187	32	-
90-14M-170	90	10A	401.07		398.28	-	150	358	187	187	32	-
112-14M-170	112	10A	499.11		496.32	-	150	456	187	187	32	-
144-14M-170	144	10A	641.71		638.92	-	165	600	187	187	32	-
168-14M-170	168	10A	748.66		745.87	-	165	706	187	187	32	-
192-14M-170	192	10A	855.62		852.82	-	165	813	187	187	32	-
216-14M-170	216	10A	962.57		959.76	-	165	920	187	187	32	-