

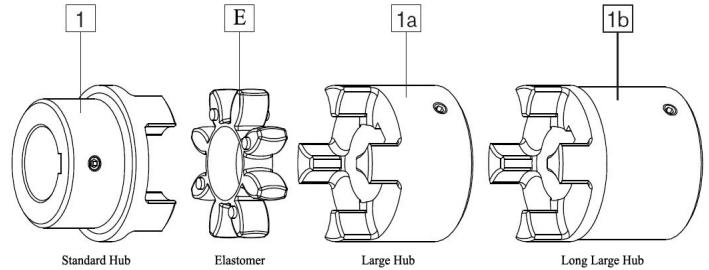

Flexible Jaw Coupling/ Flexible Star Coupling

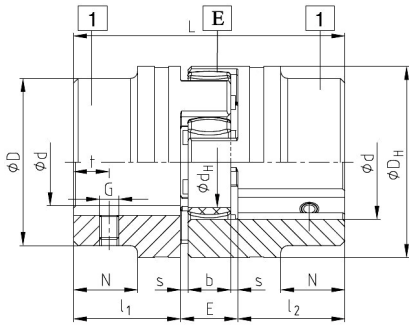

- * Bore Tolerance: H7-H8;
- * Stock bore type available;
- * Interchangeable with Rotex Couplings and Rotex GS Couplings.

Code	Hub	Material	Bore Type	Dimensions(mm)											Rated Torque (Nm)			
				Φd _{max}	ΦD	ΦD _H	ΦD ₁	L	E	l1/l2	d _H	b	s	N	92 Sh A	95-98 Sh A	80 Sh A	
7	1a	Alu.	Setscrew	7	14	14	14	22	8	7	—	6	1.0	—	1.5	1.5		
9				10	20	20	20	30	10	10	—	8	1.0	—	2	2.2		
12				12	25	25	25	34	12	11	—	10	1.0	—	3	3.5		
14	1a	Alu./Steel	Setscrew	15	30	30	30	35/42	13	11	10/—	10	1.5	—	7	10-12		
19	1	Alu. /	Clamp / Setscrew	16	32	40	—	66	16	25	18/—	12	2	20	10	17		
	1a	Steel/		24	40		40	66						25				—
	1b	Cast Iron		24	40		90	37						—				
24	1	Alu. /	/K.W. /P.B.	24	40	55	—	78	18	30	27	14	2	24	35	60		
	1a	Steel/		28	55		78	30						—				
	1b	Cast Iron		28	55		118	50						—				
28	1	Alu. /	Clamp / Setscrew	28	48	65	—	90	20	35	30	15	2.5	28	95	160		
	1a	Steel/		38	65		90	35						—				
	1b	Cast Iron		38	65		140	60						—				
38	1	Alu. /	/K.W. /T.P. /P.B.	40	66	80	—	114	24	45	38	18	3	37	190	325		
	1a	Steel/		48	78		114	45						37				
	1b	Cast Iron		48	78		164	70						62				
42	1	Steel/ Cast Iron	K.W. /T.P. /P.B.	45	75	95	—	126	26	50	46	20	3	40	265	450		
	1a			55	93		93	50						46				40
	1b			55	93		176	75						65				
48	1	Steel/ Cast Iron	K.W. /T.P. /P.B.	52	85	105	—	140	28	56	51	21	3.5	45	310	525		
	1a			62	103		103	56						45				
	1b			62	103		188	80						69				
55	1	Steel/ Cast Iron	K.W. /T.P. /P.B.	60	98	120	—	160	30	65	60	22	4	37	410	685		
	1a			74	118		118	65						37				
	1b			74	118		210	90						52				
65	1	Steel/ Cast Iron	K.W. /T.P. /P.B.	70	115	135	—	185	35	75	68	26	4.5	47	625	940		
	1a			80	133		133	75						47				
	1b			80	133		235	100						61				
75	1	Steel/ Cast Iron	K.W. /T.P.	80	135	160	—	210	40	85	80	30	5	53	1280	1920		
	1a			95	158		158	210						85				69



Code	Hub	Material	Bore Type	Dimensions(mm)											Rated Torque (Nm)		
				Φd	ΦD	ΦD _H	ΦD ₁	L	E	I ₁ /I ₂	d _H	b	s	N	92 Sh A	95-98 Sh A	80 Sh A
				90	1	Steel / Cast Iron	K.W.	100	160	200	—	245	45	100	100	34	5.5
1a	/T.P.	110	200	245	100		62										
1b	/P.B.	110	200	295	125		81										
100	1	Cast Iron	K.W. /T.P. /P.B.	115	180	225	—	270	50	110	113	38	6	89	3300	4950	
110	1	Cast Iron		125	200	255	—	295	55	120	127	42	6.5	96	4800	7200	
125	1	Cast Iron		145	230	290	—	340	60	140	147	46	7	112	6650	10000	
140	1	Cast Iron		160	255	320	—	375	65	155	165	50	7.5	124	8550	12800	

Notes:

K.W. = Keyway

T.P. = Taper Bore

P.B. = Pilot Bore

Elastomer/Spider:

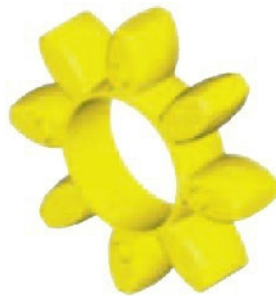

Yellow

Hardness: 92 Sh A

Working environment temperature: -40°C—+90°C

Material: PU

Application: For Medium Torque



Red

Hardness: 95-98 Sh A

-30°C—+90°C

PU

For High Torque

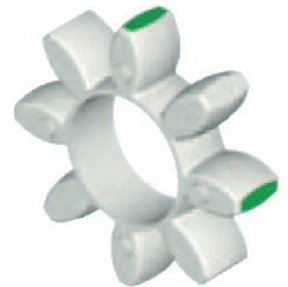

Green/Blue

Hardness: 80 Sh A

-20°C—+80°C

PU

For Low Torque