

EBG *compleo*

THE NEW CITO BM₂ 500 2.0
THERE'S MORE TO IT.



EBG *group*

team made

CITO BM₂ 500 2.0

USER & POWER UNIT.

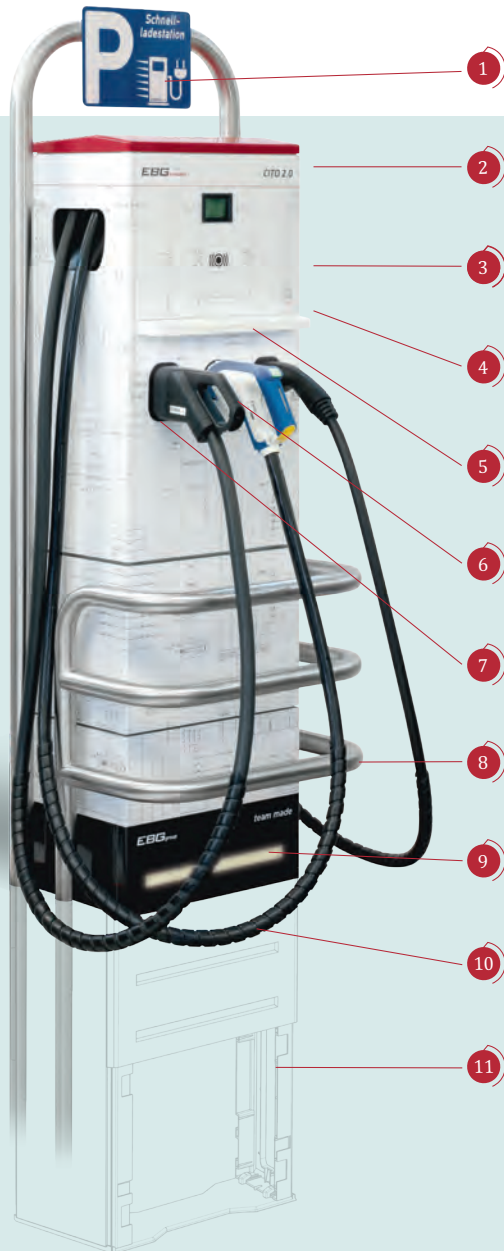

1 Integrated sign holder

2 Installation space for calibrated DC meter

3 Your design - foliation & lacquering

4 Direct OCPP backend connection

5 Near-field illumination

6 Permanent load of 50kW DC also at 40°C

7 Lockable connectors with integrated status display

8 Impact protection system

9 Surrounding lighting

10 Cable protection

11 SMC base



Very quiet (≤ 45 dBA)

12

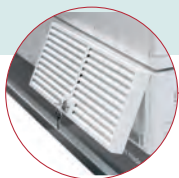

Fast filter change

13

SMC base with metal tub

14

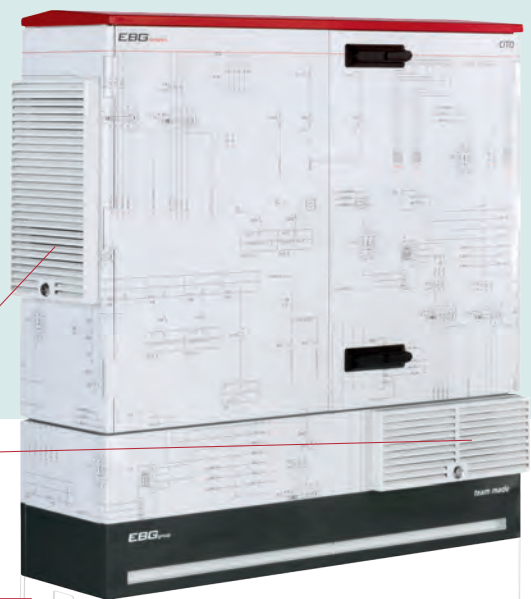

THE NEW CITO BM₂ 500 2.0

As the second generation of the CITO series, the "new generation" convinces with high stability and many attractive features. In addition to the optimized software architecture, this includes additional close-range illumination of the environment, the possibility of retrofitting a calibrated DC meter as well as a redundant, 2-part collision protection system and much more.



The proven separation of power unit and user unit offers more flexibility in the design of public spaces - optimized for best service features and low installation effort. The equipment configuration "3in1" provides the charging interfaces that are common today, charges all

standard electric vehicles and convinces with an easy-to-handle customer interface. With a very good efficiency and very low noise emission, the CITO BM₂ 500 2.0 is the further development of the successful fast charge series.

PRODUCT FEATURES AT A GLANCE

User unit:

- Intuitive operation without buttons
- Safe and stable housing made of SMC
- Four-line display for status indication
- Two-colour LED status display integrated in plug holder
- Optimized software architecture
- Illumination of the connectors
- Close-range illumination of the ground
- Automatic locking of the charging plug when not in use, release only after authentication
- Authentication via RFID or mobile phone
- Communication TCP/IP based on: OCPP via UMTS modem or Ethernet
- GPS modem for the transmission of geocoordinates to the backend system
- Possible connection to POS systems (e. g. petrol stations)
- Prepared for retrofitting a calibrated DC meter
- Built-in protection technology: DC charging point 1 x MCB, 1 x IMD, AC charging point 1 x RCD type B and 1 x MCB
- 2-part impact protection system with integrated sign holder
- Proven power electronics, more than 3,000 times in use throughout Europe

- Mounting on SMC prefabricated base (no concrete foundation required)
- Damage minimisation in the event of a possible accident, usually only the control unit has to be replaced
- > Total weight of the control unit: 85 kg

Power unit:

- Unobtrusive, safe and stable housing from SMC
- Installation up to 18m away from the user unit possible
- Integration of AC connection and power electronics
- Extension with TAB mains connection possible
- Air-cooled system with optimized noise characteristics (< 45dB)
- Lockable filter covers made of metal, filters can be changed from the outside
- Optimum accessibility of maintenance and service elements
- Mounting on SMC prefabricated base (no concrete foundation required)
- > Total weight of the power unit: 215 kg (without TAB connection)

TECHNICAL DATA SHEET

USER UNIT.

Details User Unit

Modelname:	CITO BM2 500 – User unit (HMI)
Charging mode:	Mode 3 Mode 4
Number of charging points:	1-3 charging connections for simultaneous charging of up to 2 vehicles: Single: „CCS“ 2in1: „CCS+Typ2“ 3in1: „CCS / CHAdeMO + Typ 2“
Design:	Standard: White, glossy white (9003), Optional: foil design, RAL tone as required
Housing:	Hot-pressed, glass fibre reinforced polyester (SMC)
Dimensions (HxWxD):	1530x460x330 mm (without cable)
Weight:	approx. 85 kg
Locking system:	swing lever mechanism Type 2 CCS / CHAdeMO
Charging points:	Each with attached charging cable (length 4m), charging cable interlocked in the charging station
Surrounding lighting:	Illumination of the front floor area
Near-field illumination:	Illumination of the user area
Mounting:	On SMC base with base filler (recommended); 2-part collision protection system available

Working conditions Standards/guidelines

IP degree of protection:	IP44
Mechanical impact resistance:	IK10
Operating temperature:	-25°C to +40°C ; \varnothing in 24h \leq 35°C
Standards:	DIN EN 61851-1 DIN EN61851-23

Electrical data User unit

Nominal voltage, nominal frequency:	400 V / 3~ / 50 Hz
Maximum input current:	80 A / 143 A (conditional by AC power)
Grounding system:	TN-System
Connecting terminals:	Main switch with AK max. 95mm ²
Protections AC:	RCD Type B 30mA; MCB Type C
Output power (per charging point):	AC: 22 / 43 kW; 32A/ 64 A DC: 50 kW; 200V – 480 V DC; max. 125 A
Meter AC:	MID compliant Smart Meter
Meter DC:	Prepared for MID compliant DC meter

Communication & User Interface

Modem:	UMTS
Localization:	Transmission of geocoordinates
Communication protocol:	OCPP 1.5
Authentication possibility:	RFID or mobile phone
Status display:	Display (4-line), two-color LED status display in parking position of the charging cables

TECHNICAL DATA SHEET

POWER UNIT.

Details Power Unit

Product name:	CITO BM2 500 – Power unit (PSU)
Content:	AC connection, AC/DC converter
Lightning arrester:	Combined arrester type 1+2+3
Design:	Industrial paint RAL 7035 (grey, matt); painting / foil lamination optional
Housing:	Hot-pressed, glass fibre reinforced polyester (SMC)
Dimensions (HxWxD):	1210x1115x330 mm (inkl. Sockel ab Bodengleiche)
Locking system:	Swing lever mechanism
Weight:	215 kg
Main connection:	Adherence to TAB conditions in optionally available transformer cabinet combination
Cooling:	Air-cooled system with optimized air cooling sound properties (≤ 45 dBA)
Mounting:	On SMC base with Metal tub. Base filler (recommended)
Efficiency:	>94 %
Input power factor:	>0,98

PRODUCT DIMENSIONS

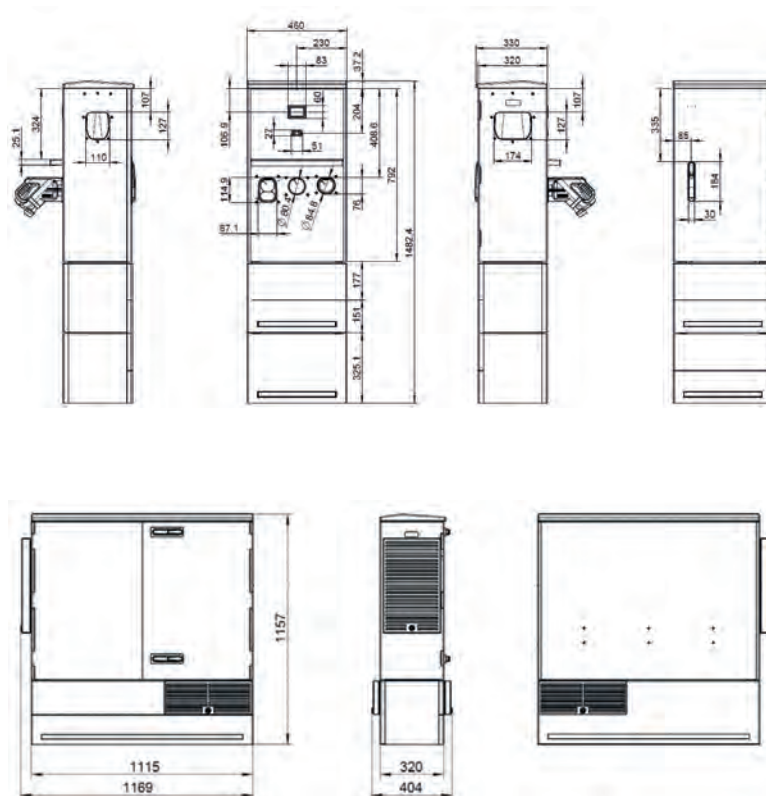

EBG *compleo*

EBG compleo GmbH

An der Wethmarheide 17

44536 Lünen

Germany

T: +49 2306 923 70

F: +49 2306 923 790

info@ebg-compleo.de

www.ebg-compleo.de

