

TS-DW, Thermo-Shaker for deep well plates



Premium
Product Class

Product video is available on the website

DEEP WELL PLATE THERMO-SHAKER PROVIDES:

- Soft or intensive sample shaking
- Rotation speed regulation, stabilization and indication
- Even rotation amplitude throughout the Thermo-Shaker platform
- Exceptional temperature uniformity across the plate
- Required operation time setting and indication
- Automatic stopping of the platform movement after expiration of the set time
- Setting and indication of the required temperature on the platform
- A variety of changeable blocks that can accommodate most popular deepwell plates
- Automatic fault diagnostics (temperature sensor, platform heating, lid heating etc.).

Separate blocks to accommodate different deepwell plates will be released. For example:

- Deep Well Plates NUNC® 96/2000 µl
- Deep Well Plates Eppendorf® 96/0.5 ml

APPLICATION FIELDS:

- Cytochemistry — for in situ reactions;
- Immunochemistry — for immunofermentative reactions;
- Biochemistry — for enzyme and protein analysis;
- Molecular biology — for nucleic acid extraction;

TS-DW Thermo-Shaker is designed for shaking and incubating deep well plates.

A multisystem principle, used in the design of the Thermo-Shaker, allows operating it as 3 independent devices: Incubator, Plate shaker and Thermo-Shaker.

TS-DW provides excellent temperature uniformity across the plate due to patented two-sided heating of the block and the lid, contour heating of the block and close proximity of heating elements to plate walls.

There is a number of interchangeable blocks to suit different plates such as Eppendorf® 96/1000 µl, Sarstedt® Megablock 96/2200 µl, Porvair® 96/2000 µl, Axygen® 96/2200 µl. Also we can manufacture a customized block on request.

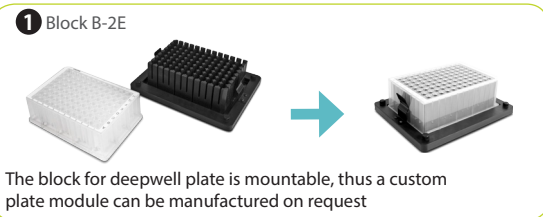

The block for deepwell plate is mountable, thus a custom plate module can be manufactured on request

Temperature setting range	+25°C ... +100°C
Temperature control range	5°C above ambient ... +100°C
Temperature setting resolution	0.1°C
Temperature uniformity @ +37°C	±0.1°C*
Temperature accuracy @ +37°C	±0.5°C*
Temperature calibration coefficient range	0.936 – 1.063 (± 0.063)
Time of platform heating from +25°C to +37°C	6 min*
Speed control range	250–1,400 rpm
Orbit	2 mm
Display	LCD, 16 × 2 signs
Digital time setting	1 min–96 hrs (1 min increment)
Overall dimensions (W × D × H)	240 × 260 × 160 mm
Weight	5.1 kg
Input current/power consumption	12 V, 4.8 A / 58 W
External power supply	Input AC 100–240 V 50/60 Hz; Output DC 12 V

* — For B-2E block

ORDERING INFORMATION: Cat. number

TS-DW without block BS-010159-A02

DESCRIPTION

SPECIFICATIONS

Interchangeable Blocks:		Cat. number
1 B-2E	Block for one deep-well plate Eppendorf® 96/1000 µl	BS-010159-AK
2 B-2S	Block for one deep-well plate Sarstedt® Megablock 96/2200 µl	BS-010159-CK
3 B-2P	Block for one deep-well plate Porvair® 96/2000 µl	BS-010159-EK
4 B-2A	Block for one deep-well plate Axygen® 96/2200 µl	BS-010159-FK
5 B-06A	Block for one deep-well plate Axygen® 96/600 µl	BS-010159-KK