



Quick Catalogue

STANDARD MACHINE ELEMENTS WORLDWIDE

elesa®



ELESA

Products range

-  **1 | OPERATING ELEMENTS**
Spoked handwheels, solid handwheels, arm handwheels, crank handles
-  **2 | CLAMPING KNOBS**
Lobe knobs, grip knobs
-  **3 | CLAMPING LEVERS**
Adjustable handles, lever handles
-  **4 | LIFT & PULL HANDLES**
Bridge handles, flush pull handles, tubular handles
-  **5 | FIXED & REVOLVING HANDLES**
Fixed handles, revolving handles, fold-away handles
-  **6 | CONTROL ELEMENTS**
Control knobs, control levers
-  **7 | POSITION INDICATORS**
Gravity indicators, positive drive indicators, direct drive indicators, handwheels with indicator
-  **8 | INDEXING AND POSITIONING ELEMENTS**
Indexing plungers, lock pins, spring plungers
-  **9 | MACHINE ELEMENTS**
Grub-screws, thrust pads, ring, washers, cam locking levers, vibration-damping elements, transfer units, magnets, bull's eye levels
-  **10 | LEVELLING ELEMENTS AND SUPPORTS**
Levelling elements, bearing end caps, connecting clamps, supports and guides
-  **11 | HINGES AND CONNECTIONS**
Plastic hinges, metal hinges, connecting angles
-  **12 | LATCHES**
Latches with knob, latches with key, hook clamps, toggle clamps
-  **13 | ACCESSORIES FOR HYDRAULIC SYSTEMS**
Plugs, breather caps, level indicators, flow indicators
-  **14 | CASTORS AND WHEELS**
Injected polyurethane wheels, technopolymer wheels, rubber wheels
-  **15 | CONNECTING CLAMPS**
Connecting clamps for tubes, tubes and accessories, linear actuators and clamp connectors
-  **RH | HANDLES FOR SPECIAL APPLICATIONS**
Handles for instruments and equipment, handles for machines and protections, stainless steel handles, "CLEAN" handles for medical and food processing equipment



ELESA

Technology and Design



Established in 1941, ELESA is the international reference for standard components destined for the mechanical, machinery and industrial equipment sectors.

An excellent combination of **technology and design** has given rise to a **diverse production** thanks to the constant commitment to follow developments in engineering plastics and metal technology. A corporate culture strongly committed to **product quality** combined with an innate sensitivity for **design and ergonomic research** led to the creation of products unique and recognisable worldwide as ELESA products.

- 180 PATENTS AND REGISTERED DESIGNS
- 38 INDUSTRIAL DESIGN AWARDS
- WORLDWIDE DISTRIBUTION
- 40,000 PRODUCT CODES AVAILABLE ON STOCK
- CUSTOMISED SOLUTIONS
- TECHNICAL COMPETENCE AT THE CUSTOMERS' SERVICE





Design and production activities are concentrated at the headquarters in Monza. An area of over 70,000 square meters - 26,000 covered - tens of millions of pieces are produced every year by utilising the **latest automated production technologies**. In the Logistics Centre over 40,000 product codes are ready to be shipped worldwide.

Quality - Environment - Safety

- Quality Management System certified according to **ISO 9001** by **British Standards Institution (BSI)** since 1993.
- Environmental Management System certified according to **ISO 14001** since 2007.
- Occupational Health and Safety Management System certified according to **BS OHSAS 18001** since 2012.
- **Authorised Economic Operator Full** certified by the European Custom Agency since 2014: recognition of full reliability of customs procedures.



FM 23747



EMS 518430



OHS 584384



ELESA is associated with:



Italian Association
of Machine Tool Manufacturers



Unione Costruttori Italiani Macchine Automatiche
per il Confezionamento e l'Imballaggio

Italian Packaging Machinery
Manufacturers Association





ELESA

Focused on the international market

ELESA guarantees the reliability of its products, designed and manufactured in Italy at the headquarters in Monza. Authentically "Made in Italy" which has become popular around the world and particularly appreciated by the most qualified machine manufacturers.



Eleza France S.A.



Eleza (UK) Ltd



Eleza USA Corporation



Eleza Scandinavia AB (SE)

ELESA products are sold in more than 60 countries worldwide through 11 subsidiaries and qualified distributors in the major industrialised countries, ensuring an efficient and timely service. The international distribution network provides all customer services in addition to professional technical advice.



STANDARD MACHINE ELEMENTS WORLDWIDE

Elesa+GANTER is the commercial joint venture between two world leaders in the production of standard industrial components. A brand in over 35 countries with subsidiaries and qualified distributors.



Elesa+Ganter Austria GmbH



Elesa-Ganter Iberica S.L.



Elesa+Ganter Polska Sp. zo.o.



Elesa+Ganter China Ltd.



Elesa+Ganter CZ s.r.o.



Elesa and Ganter India PVT LTD



Elesa+Ganter Türkiye



Elesa has been cooperating for over 45 years with Otto Ganter GmbH & Co. KG (Germany) – a qualified manufacturer of standard elements according to its own GN standards or DIN German standards, which identify the corresponding products – to offer the widest range of components for machinery and industrial equipment.





ELESA

The utmost competence

Research & Development

ELESA continues to invest in R&D and in particular in the innovation of its production technologies with the aim of creating new products or to further improve performance and reliability of existing ones.

Testing laboratory

An internal testing laboratory with the most advanced equipment and measuring instruments, studies the evolution of new technopolymers in order to extend their use in more high performing applications in the field of industrial components. All standard products in the ELESA range are subjected to mechanical, physical, chemical and durability testing in order to provide correct and reliable technical data.

The ELESA laboratory is at the disposal of customers for carrying out tests that simulate specific or particularly heavy conditions of use.

ELESA is associated with:

proplast
PLASTIC INNOVATION POLE

ELESA

Customised solutions



In addition to the widest range of standard machine elements available on the market, ELESA offers customised technical solutions in order to meet the customer's specific needs. Production flexibility, technical know-how, R&D constant activity and customer care allow for quick answers and competitive solutions.

Product customisation

Logos and text by tampoprinting, laser-engraving and moulding.

Special colours

Non standard colour options.

Special materials and shapes

Special technopolymers, stainless steel and metals; special shapes, dimensions and metal inserts.

Surface treatments

Black-oxide coating, zinc-plating, nickel plating, chrome-plating, anodising, epoxy-resin coating.

Machining service

Bosses with hole and keyway in compliance with DIN Standards.

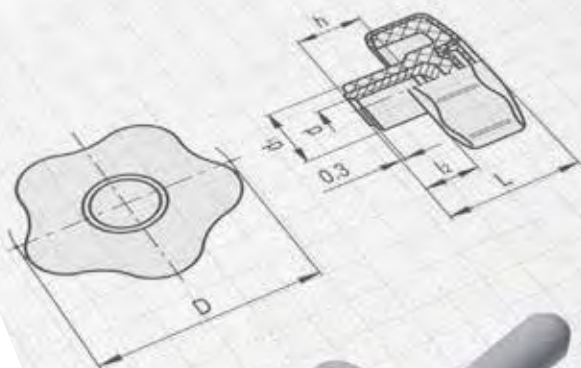

2D and 3D CAD
drawings

ELESA

Customer service



The catalogue

Always attentive to the designers' needs, ELESA offers a product catalogue in different languages also available on DVD and on elesa.com. Each product sheet features full technical descriptions, data, drawings and dimension tables allowing the designer to easily identify the correct product code and description when ordering.



www.elesa.com

From your desktop, tablet or smartphone ELESA's website is always updated, fast and easy to navigate. The **MyELESA** area allows website users to download 2D and 3D CAD drawings, create and manage favourites and add to Cart products for quotation requests.

Follow us on:





3D animations and videos

For deeper information on the technical characteristics of products and their applications.



ELESa Newsletter

Stay up to date with the latest ELESa news.

Keep updated about new products, exhibitions or interesting technical details.
Sign up on elesa.com!



Customer care

To answer all technical questions or to provide commercial information, an internal sales staff is constantly in contact with sales engineers in the field.



Road-show

To optimise customers' time, ELESa bring its product range directly to customers' premises. An easy and time-saving way to present the latest new products.

ELESa sales engineers are available to customise technical sessions to highlight specific product features.



ELESA Design

Since the 50's, ELESA has been actively involved in the cultural revision of machine tool aesthetics, that was taking shape around that time, by innovating the design of accessories and components for the mechanical industry, machinery and industrial equipment. An ongoing commitment to which ELESA has always been loyal over the decades, as proven by the 38 industrial design awards from the most prestigious juries, received in the last 30 years.

“ We design our products to offer perfect *functionality* and the best *ergonomics*, whilst keeping in mind the creation of *unique designs* recognisable the world over as ELESA products, many times we have achieved our goal. ”

The years in which ELESA products have received Industrial Design awards:

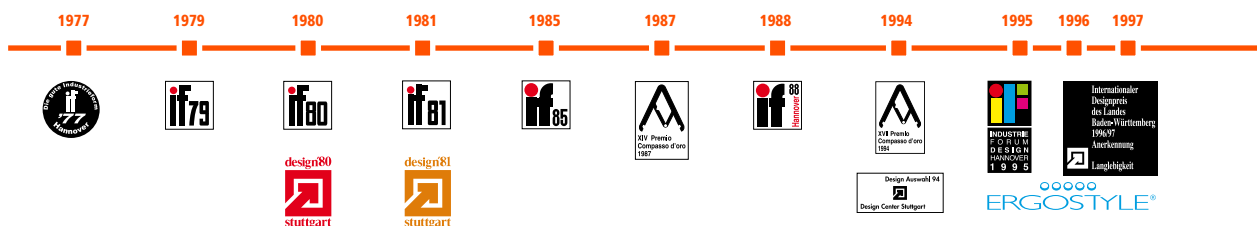



Every single detail be it aesthetic or functional is essential and can significantly improve the perception of a product.



ELESA design helps to enhance the value and quality of your products.

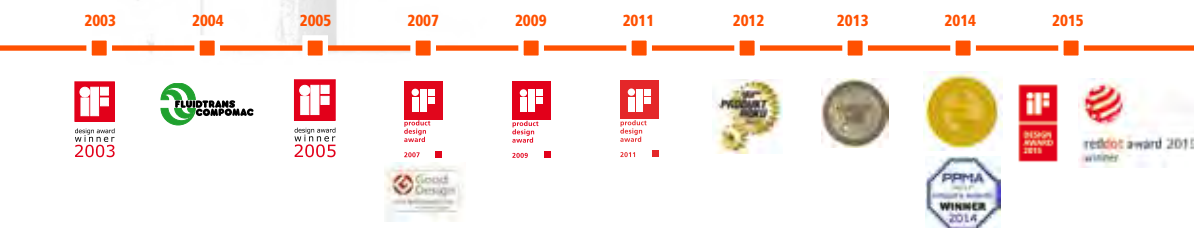

ERGOSTYLE®
by ELESA

ERGOSTYLE®
by **ELESA**



Ergonomics and Design the service of functionality and security

Ergostyle® elements were initially conceived for a series of new market segment applications including hospital and medical equipment, sports and leisure equipment, scientific instrumentation and office furniture. Nowadays Ergostyle elements are also applied in more traditional industrial sectors whose machines and equipment have undergone a profound aesthetic and design renovation over the last few decades. Elements with soft and elegant shapes with inserts in 6 Ergostyle® colours allow the components to be better integrated on machinery from an aesthetical point of view. In addition, the coloured inserts can be used to differentiate machinery functions, contributing to enhance their value.



FIVE POINTS:
a discreet trademark that distinguishes
all ERGOSTYLE® products

The 6 ERGOSTYLE® colours





ELESA SUPER - technopolymer



When the advantages of engineering plastics combine favourably with metal



“SUPER-Technopolymers” - new technopolymers with high mechanical and thermal performance - represent the latest evolution of engineering polymer materials for the industrial sector.

The most technologically advanced industries, such as automotive, aviation and electronics, have long understood the benefits of using these new generation engineering plastics. The possibility to replace metal, commonly called “metal replacement”, in more numerous applications, is now possible with the use of high performance engineering plastics.

In order to have technopolymer products in applications which have been so far a prerogative of the metal products, the design phase needs to be performed with great expertise by optimising shapes and thickness, to benefit from all the typical characteristics of polymeric materials.

ELESA has developed several components made of SUPER-technopolymer able to guarantee the following advantages:

- high mechanical performance
- corrosion resistance
- lightness
- non magnetic
- low coefficient of friction
- maintenance free
- thermal insulation
- coloured material throughout



STAINLESS STEEL, WHITE COLOUR, DIRT-PROOF SURFACES



SAFE, COMFORTABLE AND NON-SLIP GRIP



CHROME-PLATED TECHNOPOLYMER

High Performing Items:
standard components made
of engineering plastics with
innovative features and stainless
steel to meet needs
of specific industries.

ELESA

High performing items



CORROSION RESISTANCE

Components made of technopolymer with AISI 303, 304 or 316 stainless steel inserts or entirely in stainless steel. Excellent corrosion resistance for applications in sectors where provisions of law make it mandatory to use corrosion resistant materials.

- food processing, pharmaceutical and chemical



WHITE COLOUR WITH DIRT-PROOF SURFACES

Smooth surface in white colour RAL 9002 for easy cleaning and AISI 303 or 304 stainless steel inserts. Compact shape and lack of cavities avoid any deposit of dirt, dust or machining residues.

- medical and hospital equipment



SAFE, COMFORTABLE AND NON-SLIP GRIP

The soft-touch surface in thermoplastic elastomer (TPE) provides a secure, comfortable grip even under unfavourable conditions of use, such as in the presence of moisture and grease and improves the comfort for the operator's hand, allowing absorption of any vibrations during operation.

- fitness, rehab and disability aids and equipment
- high precision instruments
- equipment subject to unfavourable climatic conditions



CHROME-PLATED TECHNOPOLYMER

Technopolymer components with chrome-plated surface resistant to acetone, sea water, formic acid, ethyl alcohol, detergents and chlorine solutions.

- equipment for outdoor environments subject to unfavourable climatic conditions
- machines and tools subject to frequent cleaning cycles



SANITATION AGAINST BACTERIAL INFECTIONS

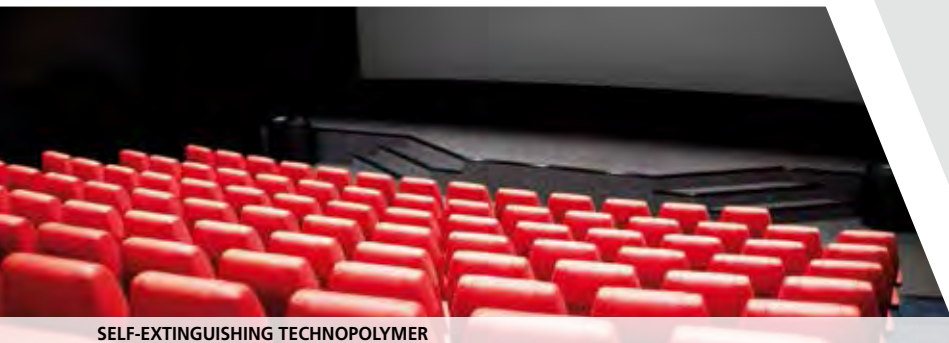

SELF-EXTINGUISHING TECHNOPOLYMER



CONDUCTIVE TECHNOPOLYMER



COMPLIANCE TO ATEX EUROPEAN DIRECTIVE

SANITATION AGAINST BACTERIAL INFECTIONS

The special technopolymer containing antimicrobial additives (mixture of silver ions on an inorganic ceramic base without chemicals, antibiotics or pesticides) prevents the deposit of any unhealthy organisms such as microbes, bacteria, mildew and fungi, preventing their reproduction.

- medical, hospital, rehab and disability aids and equipment
- machines for the food-processing and pharmaceutical industry
- urban and public fittings



SELF-EXTINGUISHING TECHNOPOLYMER

Special technopolymer certified "V0" in accordance with UL-94 V (Underwriters Laboratories) for use in public environments where flame-proof material is required.

- urban and public fittings
- entertainment equipment



CONDUCTIVE TECHNOPOLYMER

The special technopolymer prevents the accumulation of electrostatic charge between bodies with different electric potential. The ESD-C label (Electrostatic Discharge-Conductive), indelibly printed on the surface of the elements, identifies the specific conductive feature according to the standards EN 100015/1 and IEC 61340-5-1.

- assembly lines for electronic components
- "ESD- Protected" area



COMPLIANT WITH ATEX EUROPEAN DIRECTIVE

Components complying with health and safety requirements according to 94/9 /EC ATEX European directive (explosive atmospheres) for equipment in Group II, category 2GD.

- equipment and machines for use in environments subject to explosion risk



A quick glimpse
into the Elesa
product range

ELESA Quick Catalogue



The Quick Catalogue presents a significant, albeit narrow selection of the ELESa product range to quickly become familiar with the range of plastic and metal standard components entirely published on elesa.com: where you can find technical data sheets, dimensional drawings and full size tables, always updated. Available also in the paper Catalogue 166. Ask now for your free of charge copy.



elesa.com

Elesa catalogue always updated.
Free download of 2D and 3D CAD drawings.



166 Catalogue

Always on the desk.

ASK NOW FOR A FREE COPY!



Elesa S.p.A. - Headquarters in Monza (Milan) Italy

WORLDWIDE SALES NETWORK

SUBSIDIARIES

Elesa France S.A.
 Elesa (UK) Ltd.
 Elesa USA Corporation
 Elesa Scandinavia AB (SE)
 Elesa+Ganter Austria GmbH
 Elesa+Ganter Iberica S.L.
 Elesa+Ganter Polska Sp. zo.o.
 Elesa+Ganter China Ltd.
 Elesa+Ganter CZ s.r.o.
 Elesa and Ganter India PVT LTD
 Elesa+Ganter Türkiye

© COPYRIGHT ELES A 2017

All rights reserved.

No part of this catalogue can be reproduced in whole
 or in part without prior written permission from ELES A S.p.A.

Printed in Italy

Europe

Austria, Belarus, Belgium, Bosnia-Herzegovina, Bulgaria, Cyprus, Croatia, Czech Republic, Denmark, Estonia, Finland, France, Georgia, Germany, Great Britain, Greece, Hungary, Iceland, Ireland, Italy, Latvia, Lithuania, Luxemburg, Macedonia, Moldova, The Netherlands, Norway, Poland, Portugal, Rumania, Russia, Serbia, Slovakia, Slovenia, Spain, Sweden, Switzerland, Turkey, Ukraine.

Africa

Egypt, South Africa.

America

Argentina, Brazil, Canada, Mexico, United States of America.

Asia

China, India, Indonesia, Israel, Japan, Kazakhstan, Malaysia, Philippines, Singapore, South-Korea, Taiwan, Thailand, Turkmenistan, Uzbekistan, Vietnam.

Oceania

Australia, New Zealand.