

Designed for Curve and Rip Cutting - In a Single Band Saw!

- Crown shaped wheel surface provides added stability of blade.
- The foot brake permits the quick shut down of machining operations.
- Infinitely variable feed speed, feed speed, for cutting various types of wood material-both soft and hard.
- A centralized control panel is located at the normal operating position for convenient machine control.
- An amp meter indicates the percentage of motor load.
- The heavy gauge steel frame ensures maximum stability.
- The big table, 1400X850mm, provides solid support for large sawing operations.
- Pneumatic power feeder.
- Top and bottom feed roller for convenient feeding of thick and thin stocks.
 - Choice of various feed gears to feed square, round and curved stock.
 - Automatic lubricator for lubricating cooling the blade.

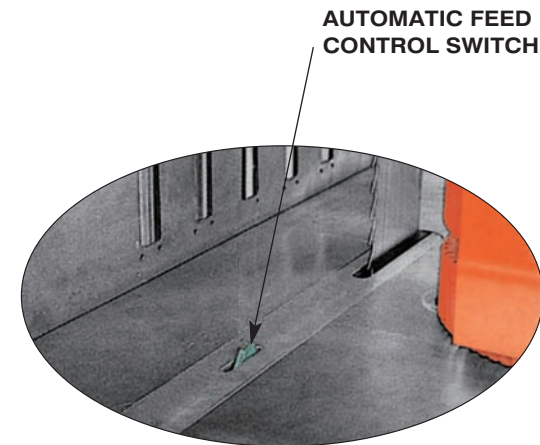

1.



AUTOMATIC FEED CONTROL SWITCH

AUTOMATIC FEED CONTROL

Eliminating the conventional handwheel adjustment of feed roller position, the feed control on this machine is air operated for automatic and convenient adjustment to suit various stocks.



The wheel cleaning cloth provides continuous cleaning & lubrication on the saw wheel.

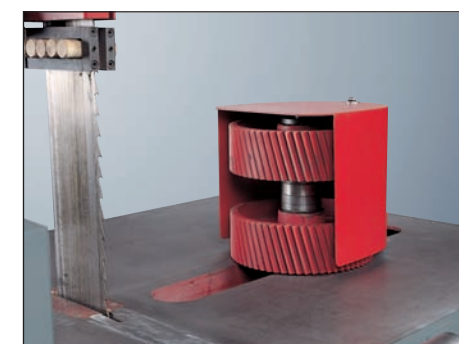

FEED ROLLER SET

The top and bottom feed roller construction is designed to feed thick and thin stock. The top feed roller may be removed when feeding thin stock.

2.

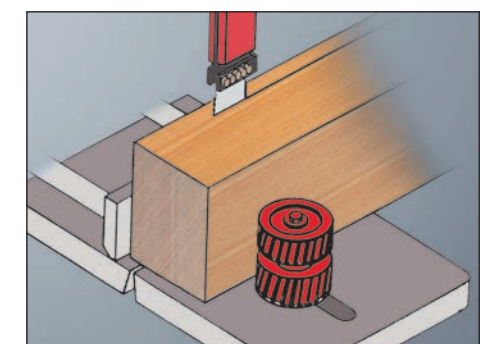

OPTIONAL FEED ROLLER

The figure shows a double bevel gear set applied for square stock. When requested, other types of feed gears are available to feed round and curved stocks.

SPECIFICATIONS

MODEL	HB-900HA
SAW WHEEL DIAMETER	900 mm (36")
TABLE SIZE	1400 × 850 mm (55 1/8" × 33 1/2")
TABLE HEIGHT FROM FLOOR	1030 mm (40 5/8")
MAX.DISTANCE FROM GUIDE TO TABLE	400 mm (15 3/4")
BLADE LENGTH	5909-5999 mm
WIDTH OF BLADE	125 mm
FENCE OPERATING	370 mm (14 5/8")
FEED OPERATING	350 mm (13 3/4")
DUST HOOD DIAMETER	ø5" × 2
AIR PRESSURE	5 kg/cm ²
FEED SPEED (VARIABLE)	8-32 m/min(26-105 ft/min)
SAW WHEEL DRIVE MOTOR	30 HP (25,40HP OPTIONAL)
FEED DRIVE MOTOR	2 HP
BLADE LINEAR SPEED	2300 m/min(7500 ft/min)
NET WEIGHT	1750 kgs
GROSS WEIGHT	2000 kg
MACHINE SIZE(L × W × H)	1980 × 1230 × 2540 mm
PACKING SIZE(L × W × H)	2650 × 1450 × 2200 mm

Design and specifications are subject to change without prior notice.

Eliminate hand feeding and increase the efficiency of straight resaw operations.



DESIGNED FOR SMOOTH CUTTING AND TROUBLE-FREE OPERATION

- Specially designed Bakelite fitted on the blade guide assembly giving rigid, positive side support.
- The table is made of cast iron and the surface is precision ground. The table can tilt to a maximum of 45 degrees, front downward, for different blade widths.
- The cast iron top and bottom saw wheels are precision machined and dynamically balanced for smooth running.
- Crown shaped wheel surface provides added stability of blade.
- The see-through guard provides operator safety and protection.
- The foot brake permits the quick shut down of machining operations.
 - The heave gauge steel frame ensures stable and vibration free cutting.
 - 4" diameter exhaust chute supplied standard.

3.



Picture shown pneumatic power feeder is optional.

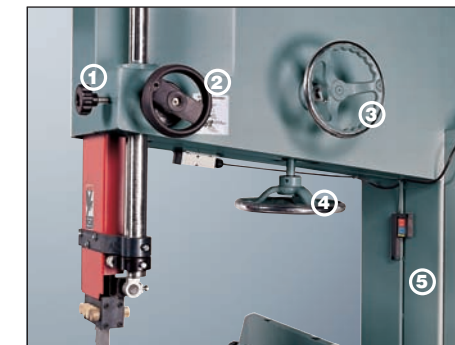

BLADE ADJUSTMENT MECHANISM

1. Blade guide fixing knob
2. Blade guide raising hand wheel
3. Blade track adjustment hand wheel or knob
4. Blade tension hand wheel
5. Blade tension indicator



CONVENIENT TABLE TILTING

Warm gear trunnion allows for effortless tilting of the table.



ELECTRICAL CONTROL PANEL

The electrical control switches are centralized on a control panel for operation convenience. The blade start is controlled by a Y-starting switch for safe and smooth starting of the blade.

SPECIFICATIONS

MODEL	HB-600	HB-700	HB-800
SAW WHEEL DIAMETER	600 mm (24")	700 mm (28")	800 mm (32")
TABLE SIZE	800 x 605 mm (31 - 1/2" x 23 - 7/8")	1000 x 700 mm (39 - 3/8" x 27 - 5/8")	1150 x 800 mm (45 - 1/4" x 31 - 1/2")
TABLE TILTING	0° ~ 45°	0° ~ 45°	0° ~ 30°
THROAT CAPACITY	580 mm (22 - 7/8")	678 mm (26 - 3/4")	778 mm (30 - 5/8")
HEIGHT CAPACITY	350 mm (13 - 3/4")	420 mm (16 - 1/2")	390 mm (15 - 3/8")
WIDTH OF WHEEL	68 mm	75 mm	90 mm
BLADE SPEED	710 RPM (4458 F.P.M)	600 RPM (4396 F.P.M)	600 RPM (5024 F.P.M)
BLADE LENGTH	4394~4454 mm (173"~175 - 3/8")	5100~5150 mm (200 - 3/4"~202 - 3/4")	5485~5515 mm (216"~217 - 1/8")
BLADE WIDTH	75 mm(3")	75 mm(3")	100 mm(4")
DUST HOOD DIAMETER	ø4" x 2	ø4" x 2	ø4" x 2
MOTOR	5 HP 3ø	7.5 HP 3ø	15 HP 3ø
NET WEIGHT	340 kg (748 lbs)	500 kg (1100 lbs)	665 kg (1463 lbs)
GROSS WEIGHT	450 kg (990 lbs)	650 kg (1430 lbs)	880 kg (1936 lbs)
MACHINE SIZE (L x W x H)	1060 x 800 x 2070 mm	1330 x 900 x 2290 mm	1500 x 930 x 2420 mm
PACKING SIZE (L x W x H)	2160 x 630 x 1100 mm	2380 x 720 x 1210 mm	2530 x 850 x 1410 mm

Design and specifications are subject to change without prior notice.

4.

Designed for Curve and Rip Cutting - In a Single Band Saw!



HB-950A



HB-600A

2 in 1 Machine for Rip and Curve Sawing

Now you have a choice of combining scroll sawing and rip sawing in the one machine. Very heavy-duty design with an affordable price.



MITER GAUGE

Manufactured from cast aluminum, this miter gauge is suitable for straight and angle cutting. It provides 60° angle adjustment at the right and the left side with easy-to-read graduated scale.



BLADE GUIDE

Convenient side guide adjustment is made through micrometric adjustment knob for narrow blades. Blade guide mechanism is equipped with bearing, providing rigid back-up support of blade.



The table can be tilted 45° front downward by direct hand tilting.



Laminated with wider 2" (50 mm.) rubber.

SAW WHEEL

The saw wheel suits blade widths from 1/4" to 2" (50MM) making this machine ideal for curve cutting and rip cutting.

The saw wheels are laminated with rubber for accurate blade tracking. Positive grip and maximum blade durability.

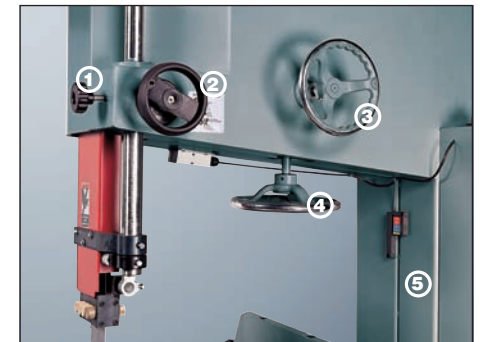

BLADE ADJUSTMENT MECHANISM

1. Blade guide fixing knob
2. Blade guide raising hand wheel
3. Blade track adjustment knob
4. Blade tension hand wheel
5. Blade tension indicator

SPECIFICATIONS

MODEL	HB-600A	HB-950A
SAW WHEEL DIAMETER	600 mm (23-1/2")	940 mm (37")
TABLE SIZE	800 × 605 mm (31 - 1/2" × 23 - 3/4")	1150 × 800 mm (45 - 1/4" × 31 - 1/2")
TABLE TILTING	0° ~ 45°	0° ~ 45°
THROAT CAPACITY	580 mm (28 - 3/4")	927 mm (36" ~ 1/2")
HEIGHT CAPACITY	350 mm (13 - 3/4")	560 mm (22")
WIDTH OF WHEEL	50 mm (2")	50 mm (2")
BLADE SPEED	710 RPM (4458 F.P.M)	533 RPM (5500 F.P.M)
BLADE LENGTH	4410~4480 mm (173-5/8" ~ 176 - 1/2")	6580~6630mm (259"~261")
BLADE WIDTH	6.3 mm~50 mm(1/4" ~ 2")	6.3 mm~50 mm(1/4" ~ 2")
DUST HOOD DIAMETER	ø4" × 2	ø4" × 2
MOTOR	5 HP	10 HP
NET WEIGHT	340 kg	720 kg
GROSS WEIGHT	450 kg	930 kg
MACHINE SIZE (L×W×H)	1060 × 800 × 2070 mm	1620 × 830 × 2880 mm
PACKING SIZE (L × W × H)	2160 × 630 × 1100 mm	2970 × 760 × 1550 mm

Design and specifications are subject to change without prior notice.

Saw Wheel Laminated with Rubber



- The side guide is micrometrically adjustable providing convenient adjustment for narrow blades.
- The saw wheel are laminated with rubber for accurate blade tracking and slippage prevention.
- The table is made of cast iron and the surface is precision ground. The table can tilt to a maximum of 45 degrees, front downward, for bevel cuts.
- Blade tension can be conveniently adjusted by means of a hand wheel. A tension scale allows the operator to correctly adjust the tension for different blade widths.
- The see-trough guard provides operator safety and protection.
- The foot brake permits the shutdown of machining operations.
- The heavy gauge steel frame ensures stable and vibration-free cutting.
- 4" diameter exhaust supplied as standard.



Convenient side guide adjustment is made by a micrometric adjustment knob for use with narrow blades.

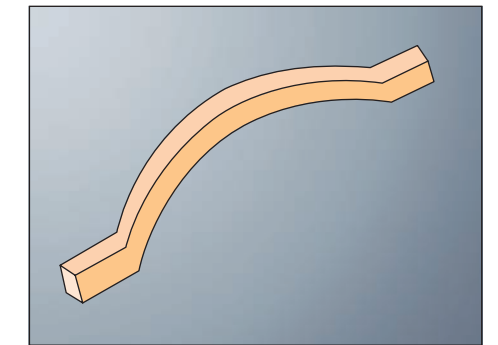
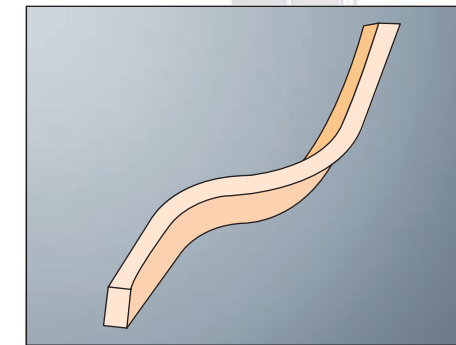
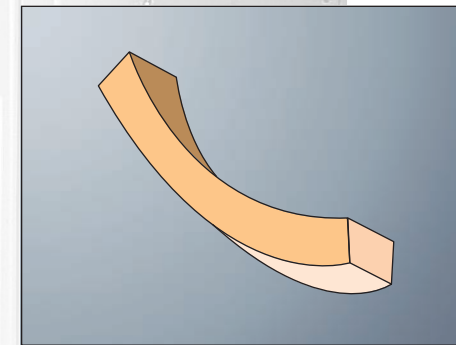

RUBBER LAMINATED SAW WHEEL

The saw wheels on models HB-450R, HB-500R, 600R and 700R are Laminated with rubber for accurate blade tracking, a positive grip and maximum blade durability.

SPECIFICATIONS

MODEL	HB-450R	HB-500R	HB-600R	HB-700R
SAW WHEEL DIAMETER	450 mm (18")	500 mm (20")	600 mm (24")	700 mm (28")
TABLE SIZE	610 × 500 mm (23 - 1/2" × 19")	680 × 520 mm (26 - 3/4" × 20 - 1/2")	800 × 608 mm (31 - 1/2" × 20 - 1/2")	1000 × 700 mm (39 - 3/8" × 27 - 5/8")
TABLE TILTING	0° ~ 45°	0° ~ 45°	0° ~ 45°	0° ~ 45°
THROAT CAPACITY	430 mm (17")	475 mm (18" ~ 3/4")	580 mm (22 - 7/8")	678 mm 26 - 3/4")
HEIGHT CAPACITY	245 mm (9 - 3/8")	300 mm (11 - 7/8")	350 mm (13 - 3/4")	420 mm (16 - 1/2")
WIDTH OF WHEEL	30 mm	35 mm	35 mm	40 mm
BLADE SPEED	995 RPM (4685 F.P.M)	850 RPM (4450 F.P.M)	710 RPM (4458 F.P.M)	680 RPM (4980 F.P.M)
BLADE LENGTH	3855~3885 mm (151" - 3/4" × 153")	3969~3999 mm (156 - 1/4" × 157 1/2")	4410~4480 mm (173 - 5/8" × 176 - 3/8")	5130~5180 mm (202" × 204")
BLADE WIDTH	6.3 mm~32 mm (1/4" ~ 1 - 1/4")	6.3 mm~32 mm (1/4" ~ 1 - 1/4")	6.3 mm~32 mm (1/4" ~ 1 - 1/4")	6.3 mm~32 mm (1/4" ~ 1 - 1/4")
DUST HOOD DIAMETER	ø4" × 1	ø4" × 1	ø4" × 1	ø4" × 1
MOTOR	2 HP, 220 V, 1 Ph	2 HP	3 HP	5 HP
NET WEIGHT	210 kg	280 kg	315 kg	450 kg
GROSS WEIGHT	280 kg	350 kg	450 kg	600 kg
MACHINE SIZE (L × W × H)	860 × 560 × 1890 mm	970 × 700 × 1880 mm	1060 × 800 × 2070 mm	1330 × 900 × 2290 mm
PACKING SIZE (L × W × H)	1970 × 560 × 890 mm	1970 × 580 × 1010 mm	2160 × 630 × 1100 mm	2380 × 650 × 1210 mm

Design and specifications are subject to change without prior notice.

HF-150 MECHANICAL POWER FEEDER

Eliminates hand feeding and increases efficiency of straight cutting operations. The feed direction is reversible and the infinitely variable feed speed makes it possible to feed all types of wood. Powered by a 1 HP motor, the power feeder provides powerful and smooth feeding performance. Width is conveniently adjusted by turning a handwheel. Feed roller is covered for safety guard. The entire power feeder assembly is easy to mount on the table. If required, the roller surface can be laminated with rubber to prevent scratching on the workpiece surface.



SPECIFICATIONS	
MODEL	HF-150
LENGTH OF ROLLER	150 mm
DIAMETER OF ROLLER	200 mm
FEED SPEED	16~66 F.P.M Variable
MOTOR	1 HP
AIR PRESSURE	Mechanical
FENCE ADJUSTMENT RANGE	120 mm
FEED OPENING	125 mm
NET WEIGHT	90 kg
GROSS WEIGHT	110 kg
FEEDER SIZE (L x W x H)	640 x 440 x 500 mm
PACKING SIZE (L x W x H)	700 x 500 x 670 mm

Design and specifications are subject to change without prior notice.

HF-150 A PNEUMATIC POWER FEEDER

Eliminate hand feeding and increase the efficiency of straight cutting operations.

The feed roller motion is controlled by an air cylinder, providing automatic and convenient adjustment for various stocks. The feeding pressure is adjustable. Width is conveniently adjusted by turning a handwheel. The feed roller running is driven by a 1 HP motor, providing powerful and smooth feeding performance. Feed roller is covered for added safety. Feed roller clamping and releasing motions are controlled by a foot switch for operation convenience. If required, the roller surface can be laminated with rubber to prevent scratching of the workpiece surface.

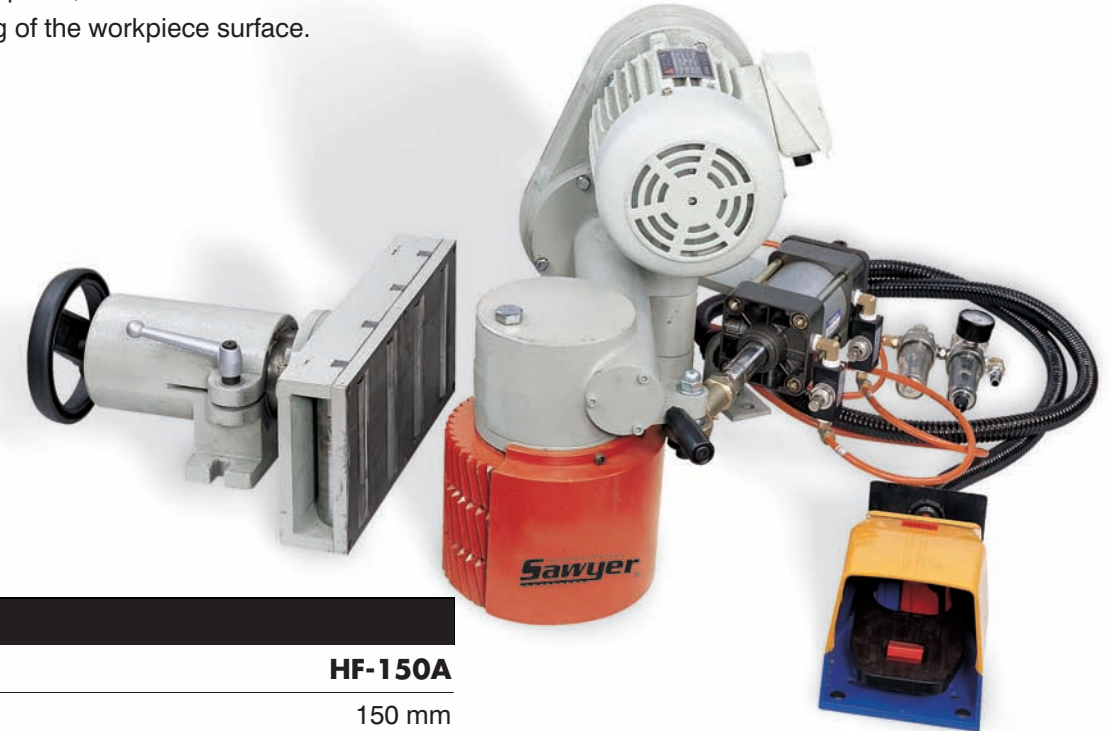

SPECIFICATIONS	
MODEL	HF-150A
LENGTH OF ROLLER	150 mm
DIAMETER OF ROLLER	200 mm
FEED SPEED	16~66 F.P.M Variable
MOTOR	1 HP
AIR PRESSURE	5 kg/cm ²
FENCE ADJUSTMENT RANGE	120 mm
FEED OPENING	125 mm
NET WEIGHT	110 kg
GROSS WEIGHT	130 kg
FEEDER SIZE (L x W x H)	640 x 440 x 500 mm
PACKING SIZE (L x W x H)	700 x 500 x 670 mm

Design and specifications are subject to change without prior notice.

Woodworking Machinery
Sawyer[®]

Band Saw Series

*A Perfect Solution for Versatility
Great Slicing Capacity and Ease of Operation!*

Introducing the cost-effective from
HOON HSIANG

Rugged construction!

High accuracy!

High safety!

Woodworking Machinery
Sawyer[®]

HOON HSIANG INDUSTRIAL CO., LTD.

NO. 38, LANE 100, SEC. 3, GWO FENG RD., FENG YUAN CITY,
TAICHUNG HSIEN, TAIWAN

PHONE : +886-4-2528 4543

FAX : +886-4-2528 4491

[http : //www.sawyer.com.tw](http://www.sawyer.com.tw)

S/E 034-2006-12 Surway, Tel:04-23227907

CE

HOON HSIANG INDUSTRIAL CO., LTD.