

Lamello

# Divario P-18

Self-clamping, invisible  
fitting for slide insertion

P-System



interzum

Award

Best of the best



# Your advantages with the Divario P-18

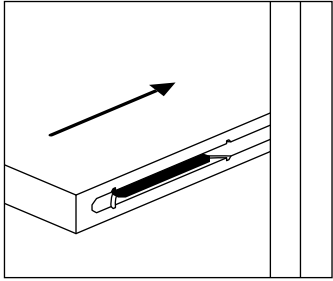

## Sliding insertion

Insertion between two fixed sides or shelves via a guiding groove

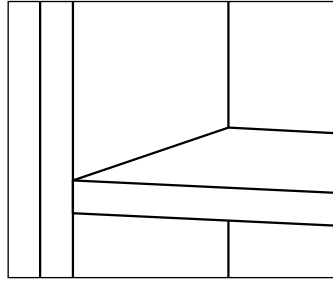

## Invisible

Guiding groove covers the fittings

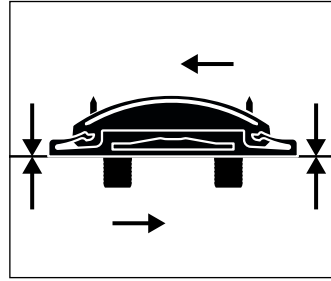

## Clamped joint

No resistance while inserting until shortly before building the clamping force

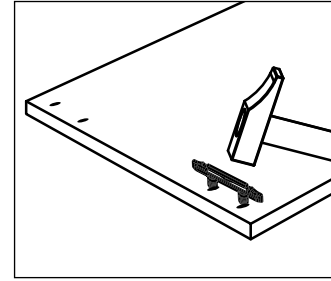

## Fast installation

Quick installation of the fittings without glue after transport. Drill holes in the surface are possible with CNC without angle aggregates (eg. Nesting machines)

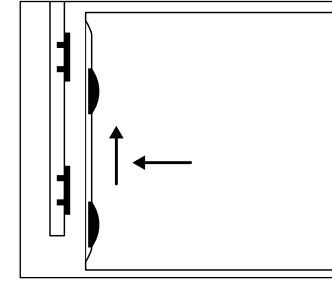

## Assemble by sliding

Partially routed guiding groove for completely invisible furniture joints

## How it works

Find the Divario P-18 video on [www.lamello.com](http://www.lamello.com)



1. Groove with Zeta P2 / CNC

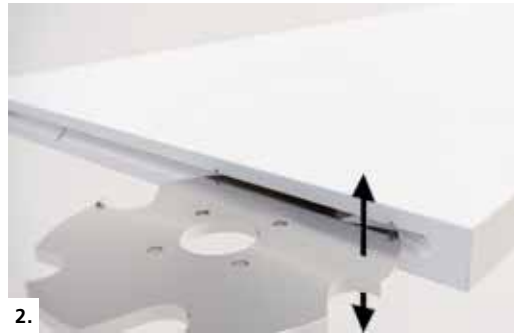

2. Cut P-System groove



3. Insert Divario P-18

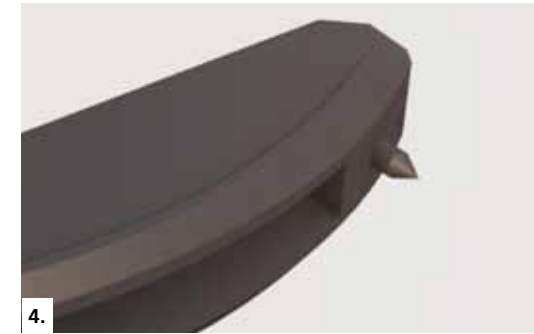

4. Drive in the positioning pin

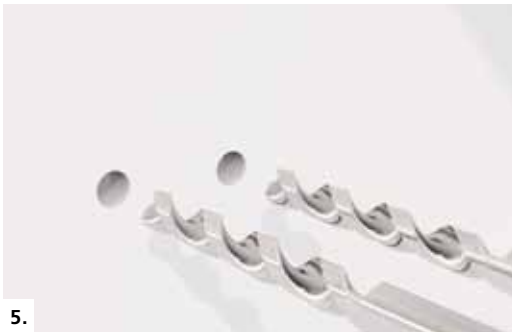

5. Drill holes Ø 8mm



6. Insert Divario P-18

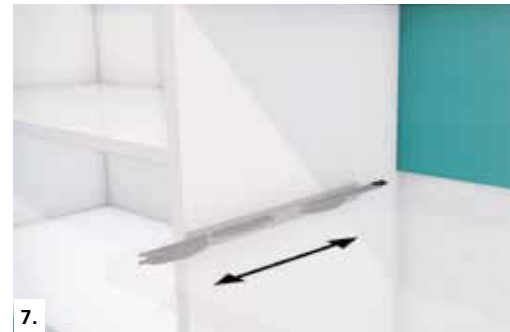

7. Insert the shelf



8. Clamped invisible joint

# Installation with Zeta P2

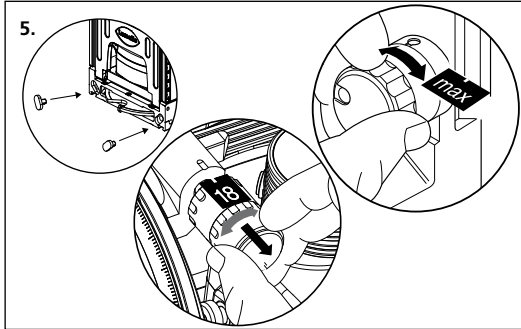
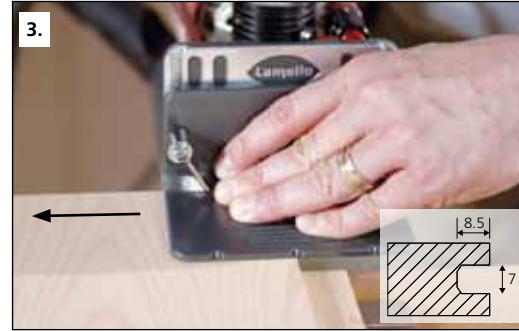
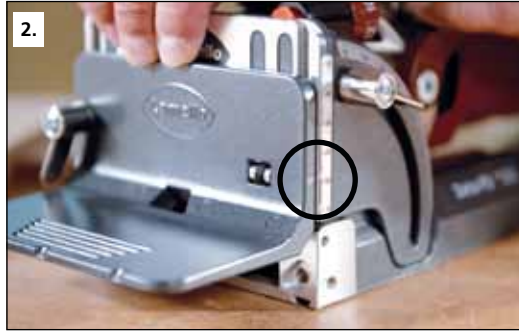
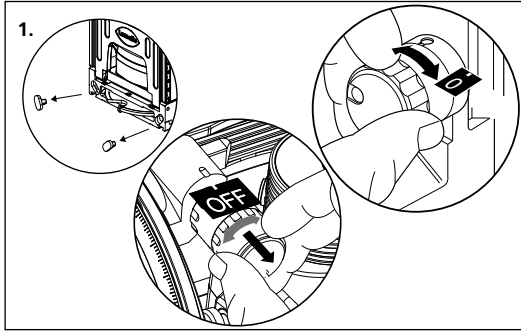

Alternatively, drill  $\varnothing 8 \times 32$  mm holes using

CNC	Blum Minipress	Mafell Duo Dowel System
		

«I think it's incredible that the Divario P-18 is equally suited to highly mechanised production using CNC technology and to non-industrial manufacture.»

Christoph Foreman, Product Manager Lamello AG



hülsta, D-48702 Stadthlohn

Perfect furniture. Shelves and separation walls are press fitted and there is no need for joints.



«Large components can be transported individually and joined efficiently on site by slide insertion.»

Adolf Fink, Managing Director of Tischlerei Fink, Langen bei Bregenz, Austria



## Divario P-18



Divario P-18	Art.No.
Starterset with 80 pairs incl. installation tool.....	145550S
Carton with 80 pairs .....	145550
Carton with 300 pairs .....	145560
Carton with 1000 pairs .....	145570



Divario P-18 Installation tool	Art.No.
for fixing the Divario in the workpiece .....	125500

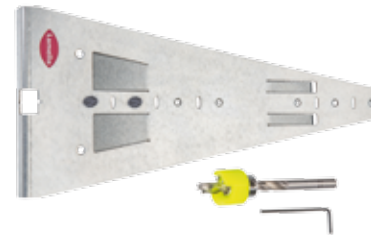

Divario P-18 Marking jig	Art.No.
incl. drill with centering point and rotating depth collar for the precise drilling of Divario drill holes by hand.....	125510

## Zeta P2



Zeta P2	Art.No.
with carbide tipped profile groove cutter .....	101402
with diamond tipped profile groove cutter.....	101402D

# More P-System products

Tenso P-14



pairs	Art.No.
80	<b>145410</b>
300	<b>145420</b>
1000	<b>145431</b>

Clamex P Medius 14/10



pairs	Art.No.
80	<b>145370</b>
300	<b>145371</b>
1000	<b>145357</b>

Clamex P-14



pairs	Art.No.
80	<b>145334</b>
300	<b>145346</b>
1000	<b>145356</b>

Clamex P-10



pairs	Art.No.
80	<b>145372</b>
300	<b>145373</b>
1000	<b>145374</b>

Bisco P-14



pieces	Art.No.
80	<b>145301</b>
300	<b>145302</b>
1000	<b>145303</b>

Bisco P-10



pieces	Art.No.
80	<b>145304</b>
300	<b>145305</b>

- I want a **demo** of P-System / Divario P-18
- Yes I want to **test Zeta P2** in my application
- Yes, I am interested in using **P-System on a CNC machine**, please contact me
- Send me the **P-System brochure**
- Send me the **Lamello catalogue**

Company

Name

First name

Street

City

Phone

Fax

E-Mail



**Pioneering  
wood joining**

**Lamello AG**  
**Verbindungstechnik**  
 Hauptstrasse 149  
 CH-4416 Bubendorf

T +41 61 935 36 36  
 F +41 61 935 36 06  
 info@lamello.com  
 www.lamello.com