

# WOODWORKING DRILL

品牌推广 | 绵阳·室内设计  
T:0816-2344338 134-0401-3393 (摄影 设计 印刷)

商以诚为本 业以信为基  
BUSINESS BUILDS ON INTEGRITY

绵阳市雅森五金工具有限公司  
Mianyang Yasen Hardware Tools Co.,Ltd.

地址：中国·四川省绵阳市  
Add：Mianyang City, Sichuan Province, China

Tel：+86-816-2406189

Fax：+86-816-2406190

E-mail：mianyanyasen@sina.com

Web site：www.yasentools.com / yasengj.en.alibaba.com



雅森®  
—YASEN—

造精工之雅，兴木业之森

BUILD THE ELEGANCE OF PERFECT，PROSPER THE FLOURISH OF CARPENTRY

# ABOUT YASEN

## 关于雅森

绵阳市雅森五金工具有限公司坐落于中国美丽的科技之城——绵阳。雅森在木工工具领域拥有超过10年的经验，已成为大陆顶级木工钻制造商的象征之一。建立伊始就立足打造精品木工排钻钻头，将科技与生产完美结合，专注于排钻钻头的设计、研发、生产、定制及配套解决方案的提供，在市场的风雨洗礼中，绵阳雅森五金工具始终坚持用户至上、质量为本、信誉第一、服务第一的原则，始终将客户需求放在最前端。坚持“造精工之雅，兴木业之森”的工艺准则，对产品严格把关，不允许任何次品流入市场。

公司采用全套数控先进生产线和先进的生产工艺，刀头材质一律采用超细颗粒钨钢，精度高、韧性好、耐磨锋利为雅森刀具的突出特点。

公司现有产品有木工钻头系列、快速接头系列，T.C.T.整体合金直刀系列等木工刀具，全方位服务木业。雅森在饱受行业市场重重考验的同时，也造就了一批经验最为丰富的团队。无论是管理层，执行层还是服务人员，均能以一流的专业素质、热情的服务。协助客户解决一切的问题，我公司秉承“专业、创新、服务一流”的经营理念，本着“质量第一、客户至上！”的经营宗旨，为木业发展提供更耐用的精品刀具。

Mianyang Yasen hardware Tools Co., Ltd is located in the Chinese beautiful city of science and technology, Mianyang. More than 10 years of experience in the woodworking tools filed, the name of Yasen has become one of the symbol at the top quality woodworking drills manufacturer in the mainland. In the moment of commencement, Yasen based on creating the high-quality woodworking drill bits and focusing on the R & D, designing, production and customization, providing a complete set of the solutions. Under the rain and wind in the market, Yasen always adheres to the principle of customer utmost, quality-oriented, prestige first, service first, and always focus on customer and satisfy the customer demand. Adhering to the technology criterion of "Build the elegance of perfect, prosper the flourish of carpentry", and do not allow any defective products into the market.

Yasen has a full set of advanced CNC machining production lines and advanced production technology. The material of cutter bit is the ultrafine particles of tungsten steel. High precision, good toughness, sharp and wearable are the Yasen's prominent characteristics.

Now, there are woodworking drill bits series, adaptors series, T.C.T. solid carbide drill series and so on. All of our service is around the woodworking tools. Yasen have grown and Yasen have changed, but at the same time, Yasen also made an experienced team. Whatever the management level, the executive level or the service all can assist the customers to solve all of the problems with the classic quality and enthusiastic service professionally. Moreover, our company follows the professional standard of operation philosophy—Profession, Innovation, Service class, and the management aim—Quality first, Customer superior. Providing the most durable professionally high-quality cutter for the development of wood industry.

### 科学管理流程

#### SCIENTIFIC MANAGEMENT PROCESS

**研发：**在涉及的材料、工艺与难点技术方面，设立专业技术团队，对产品研发中的加工工艺等提供实践与理论保障。

R & D: At the aspect of material, technology and technology key point, Yasen sets up professional technical team to ensure the processing technology and machining theory in the research and development.

**设计：**对产品研发成果进行工程制造技术转化，形成产品；图纸、制造工艺、技术标准化，为产品生产提供最专业的支持，保证成品达到预期的设计要求。

Design: Our team engineers the R & D achievements with manufacturing engineering technology and then forming products. The craft, manufacturing technique and technology standardization provides professional supports for products production. All of them ensure that the finished product meets the design requirements.

**生产制造：**严格执行工艺标准，按照标准化制造出合格的产品，严格把关，拒绝次品进入市场。

Manufacturing: carrying out the craft standard strictly and manufacturing qualified products on the basis of standard. Stringent quality checks and do not allow any defective products into the market.

### 严谨工艺管理

#### STRICT CRAFTWORK MANAGEMENT

严格按照客户要求，让工作不留遗憾，让客户无可挑剔。严格按照客户设计工艺组织生产，将质量与艺术赋予每一个产品。

Focusing on customers' interests, we let our work without regret and meet customer needs, giving the quality and art to each product.

### 高效服务

#### EFFICIENT SERVICE

用户选择雅森体现的是一种信任，而我们服务客户就是将这种信任积蓄更加完美的延伸。把服务理念贯穿于企业运营的每一个环节，形成企业核心文化。满足客户的需求是我们的立身之本，客户满意是我们永恒的追求。一切以满足客户的需求为最高准则，一切以取得客户的信誉为最好的评价。

The user selected Yasen is an embodiment of trust, and our service is to extend this trust be more perfect. Every aspect of the service concept in enterprise operation formed the enterprise culture. To meet the customers' need is our foundation. Customer's satisfaction is our eternal pursuit. Meeting customers' needs is our highest rule and obtaining the customer's credibility is our best evaluation.





雅森精工 专注木业 所以专业  
Attention to wood, so professional

科学的刀尖设计，轻快地切削加工  
数控加工中心一次加工成型，保证产品精度  
有效控制跳动及钻头定位中心  
电泳涂层，涂层更薄，切屑更顺畅  
精良的选材，超细颗粒合金刀头  
银纤低温焊接

Scientific blade design and machining smoothly  
CNC machining center adopts one-time molding technology to guarantee the precision of products  
Controlling of run-out and the center position of drill bit effectively  
E-coat makes the coat be thinner and makes the cutting be more unhindered  
Superior material selection, ultrafine particles alloy cutter  
Silver fiber welding at low temperature

精心做好每一件产品  
真诚服务每一位用户

Do a good job in every product  
Provide sincere service to every user

A close-up, high-contrast photograph of a drill bit. The bit is shown from a low angle, looking up towards the tip. The cutting edges are sharp and metallic, with a blueish-grey hue. The background is dark and out of focus.

DRILL



## 先进科技与优秀传统的完美结合 ADVANCED TECHNOLOGY AND EXCELLENT TRADITION

绵阳市雅森五金工具有限公司是集研发、生产、销售、服务于一体的先锋企业，将现代化先进科技与优秀传统技术有效结合，拥有雄厚的技术实力和强大的生产能力。雅森出品的科技型合金钻头、专业型合金钻头、排钻快换钻头、T.C.T.整体式合金直刀等系列木工工具产品，都在原有的经典设计的基础上，融入行业最新技术，保证产品品质，使产品整体效果（加工强度与加工持续性）更加趋于完美。

Mianyang Yasen Hardware Tools Co., Ltd. is one of the pioneer enterprises with R & D, production, sales and service, combining modern advanced technology and traditional technology, and having strong technical strength and strong production capacity. Now, there are solid carbide dowel drills series, flute dowel drills series, economical dowel drills series, adaptors series and T.C.T. straight bits series, hinge boring bits series and so on. All of our products adopted the latest technology based on the classic design, ensuring the quality of products and making integral effect of products (strength and continuousness) is more perfect.

## 值得信赖的技术和服务 RELIABLE TECHNOLOGY AND SERVICE

雅森的拓业之道，是执着于“务实-进取-创新-品质”的企业理念，力求成为所服务行业领域内值得信赖的技术和服务提供商。在努力提升自身核心竞争力的同时，通过优质产品、专业的技术、至诚的服务，协助客户持续提高其竞争力。

"Pragmatic - Progressive - Innovation - Quality" is Yasen's business philosophy, and Yasen strives to become the provider who has reliable technology and best service. At the same time, in efforts to enhance our core competitiveness to help customers improve their competitiveness through high quality products, professional technology and sincere service.

**务实** 遵循客户导向的研发与生产，将客户的需求放在首位，履行自身的各项承诺和责任。

**进取** 保持不断进取的意识，才能应对客户不同的需求、行业激烈的竞争

**创新** 将精力不断投入到产品与服务的创新，以先进的技术，赢取市场份额和利润率

**品质** 高品质是赢得客户信赖的关键，因此，雅森始终将严格的品质把控贯彻到最细微之处。

**Pragmatic:** Following the customer oriented development and manufacture, putting customer at the first place and fulfilling our own commitments and responsibilities.

**Progressive:** Keeping the enterprising consciousness to respond to customer requirements and competition.

**Innovation:** Putting energy into the innovation of the products and services continuously, using advanced technology to win market share and profit rate.

**Quality:** High quality is the key to win the customers' trust. Therefore, Yasen always controls the quality strictly in every minute of the production.

# STRENGTH COMES FROM COHESION 力量来自于凝聚



## 诚人造诚品 HONEST PEOPLE PRODUCE CREDIBLE PRODUCT

“诚人造诚品”是雅森共同的价值观。雅森人相信，只有用心的员工和团队，才能生产出可靠优质的产品、提供令客户满意的服务。公司以此统领各项决策的发展思路，提供了“以人为本，以质为本，以诚为本”的行为标准，引导团队与客户并肩开拓。

这是一个年轻而进取的团队，年轻带来澎湃的创业热情，而进取则意味着美好未来的无限可能；同时，雅森更是一个专业而敬业的团队，每一个雅森人都具备了出色的专业知识与奉献精神。

Producing the integrity of goods, Yasen shares some of the same values. Only the intentions of the staff and team can produce high quality products and provide satisfactory services. So, our company dominates the development thought through this idea and offers a "people-oriented, quality-oriented and honest" behavior standard, guiding the team and customer to open up together.

This is a young and enterprising team with rushed entrepreneurial zeal, because enterprising spirit means better future possibilities; at the same time, Yasen is more than a professional and responsible team and everyone has excellent professional knowledge and dedication.

## 拓共赢之路 WIN-WIN ROAD

未来的成功，取决于我们提供解决方案的效率和能力，更取决于我们拓业的执着信念。雅森对未来愿景的定义，包含四个方面：

The success in the future is not only depends on our efficiency and ability of providing solutions, but also depends on our persuasion. Yasen's definition of vision for the future which includes the following four aspects:

**客户收益更大** 客户赢则雅森赢，因此将客户的利益放在首位，全力以赴协助客户提升竞争力。

**Customer return maximum**

The customer's success is Yasen's success, so Yasen will put the interests of customers in the first place and try our best to help our clients achieve competitiveness.

**员工个人发展** 企业营造帮助员工取得个人成功的环境，员工才能让团队充满活力。

**Employee individual development**

The enterprise creates the environment which helps the staff to obtain individual success and let the team be full of vitality.

**企业成熟壮大** 成为个性化服务、国际化定位和规模化发展的机械设计与制造公司。

**Company strong**

Become a manufacturing company which contains the personalized service, internationalization orientation and scale development.

**建设更好未来** 为构建可持续发展的城市和环境做出更大的贡献。

**Build better future**

Make greater contribution for building the sustainable city and environment.





钻头使用注意事项 PRECAUTION FOR USE

- 1、由于钻头的钻尖和刃口非常锋利，所以在拆装的过程中应该轻拿轻放，避免碰撞和撞伤，不使用时应放回专用包装盒内，并做好防尘和防锈。
- 2、使用之前应复查刃口尺寸是否标示尺寸相符，避免不必要的加工浪费。
- 3、钻头在装进快换接头后要测量接头和钻头的总长，根据需要可以调整钻头柄部内的螺钉来控制需要的长度。
- 4、选择高精度并适合自身机床的快换接头，高精度的接头配上高精度的钻头是保证加工质量的方式之一。
- 5、快换接头要注意防尘和防锈，要注意锁紧钻头的螺钉的使用情况；如果钻头锁不紧将会影响打孔效果，甚至会损坏钻头和接头。
- 6、排钻机的钻排、钻座在不使用时一定要除尘和防锈，它的精度直接影响打孔质量及设备使用寿命。

- 1、The drill bit and the blade edge are very sharp and handling with care in the process of dismantling to avoid collisions. Back it to the special packing box, and make dust and rust prevention when it is not in use.
- 2、Check the blade edge before using in order to avoid unnecessary wastes.
- 3、Measure the adaptor and bit total length after installed. Adjust the screw in the drill shank to control the length.
- 4、Choose the adaptor which is suitable for the machine. High-precision adaptor and high-precision drill is one way to ensure the quality of machining.
- 5、Must pay attention to the dust and rust prevention of adaptor and the screw in the drill bit. It will affect the final result or even might damage the drill bit and adaptor if screw is not lock.
- 6、Pay attention to the dust and rust prevention for the boring head and boring anchor when the boring machine is not in use.



钻头使用过程中常见问题 COMMON PROBLEMS IN THE COURSE OF USING

（一）加工后的孔出现崩边现象 The phenomenon of edge collapse

- 原因：1、划线刀不锋利，两划线刀不等高

2、中心尖与柄部同心度不符合标准

3、机床自身主轴跳动大

4、加工板材（工件）有移动现象

5、主轴转动和刀具给进速度不匹配

6、排钻快换接头同心度不高和其它技术数据不达标
- Reason: 1、Crossed blade is not sharp and the two crossed blade is unequal-high. 2、Center point of drill and shank concentricity are not meet the criteria. 3、The machine is on the condition of wrong spindle run- out. 4、The board processing (artifact) is on the move. 5、Spindle rotation and cutter speed is not match. 6、The adaptor concentricity is low and other technical data are not up to standard.

（二）加工后孔出现椭圆现象 The phenomenon of ellipse

- 原因：1、中心尖与柄部不同心，或者中心尖不锋利

2、打孔过程中工件有移动现象

3、主轴转动和刀具给进速度不匹配

4、排钻快换接头同心度不高和其它数据技术不达标

5、排钻机钻轴松动或已损坏
- Reason: 1、The center point and the shank is misalignment, or the center point is not sharp.2、The artifact is on the move during drilling.3、Spindle rotation and tool feed speed is not match.4、The adaptor concentricity is low and other technical data are not up to standard.5、The spindle of boring machine is loose or damaged.

（三）加工过程中冒烟、烧糊 The phenomenon of smoke or burn

- 原因：1、刃口不锋利，应更换钻头

2、螺旋槽（排屑槽）堵塞，导致排屑不畅

3、工件（加工材料）湿度超标，板材胶含量太重或者胶水质量不好（中纤板和胶合板尤其突出）

4、刀具的进给速度与加工的材料及打孔深度不匹配

5、选择适合加工材料的钻头类型
- Reason: 1、The blade edge is not sharp, the drill bit should be replaced.2、Spiral groove (chip groove) is congestion that will lead to chip removal poorly.3、Artifact (material) is humidity over limit or the glue quality is not good ( especially the fiber board and plywood )4、The tool feed speed is not match with the material and the depth.5、Choose the suitable drill bit type for processing materials.

CONTENTS  
产品目录

科技型钻头

• 科技 I 型A款(KJ1-A)	Solid Carbide Dowel Drills A (KJ1-A)	09
• 科技 I 型B款(KJ1-B)	Solid Carbide Dowel Drills B (KJ1-B)	10
• 科技 I 型C款(KJ1-C)	Solid Carbide Dowel Drills C (KJ1-C)	10
• 科技 I 型通孔钻(KJ1-V)	Dowel Drills for Through Hole (KJ1-V)	11

• 科技 II 型A款(KJ2-A)	Flute Dowel Drills A (KJ2-A)	12
• 科技 II 型B款(KJ2-B)	Flute Dowel Drills B (KJ2-B)	13
• 科技 II 型C款(KJ2-C)	Flute Dowel Drills C (KJ2-C)	13
• 科技 II 型通孔钻(KJ2-V)	Flute Dowel Drills for Through Hole(KJ2-V)	14

专业型钻头

• 专业型（ZY-57/70）	Economical Dowel Drills	15
• 加长型（ZY-80/90/100）	Long Type Economical Dowel Drills	16
• 专业型通孔钻（ZY-V）	Economical Dowel Drills for Through Hole	16

分体钻(FT-57/70) Hinge Boring Bits 17

科技型铰链钻(KJ-FT-57/70) Solid Carbide Hinge Boring Bits 18

排钻快换接头 Adaptors 19

T.C.T整体合金直刀(TCT) T.C.T. Solid Carbide Straight Bits 20

非标定制 Customization 21



雅森®  
—YASEN—

## 产品介绍 PRODUCT INTRODUCTION

### 科技 I 型A款 (KJ1-A) Solid Carbide Dowel Drills (A)

mdf	chipboard	laminated board	hardwood	softwood	plywood
中密度板	刨花板	贴面板	硬木	软木	胶合板
★★★★★	★★★★★	★★★★★	★★★★★	★★★★★	★★★★★

单位(unit)=mm

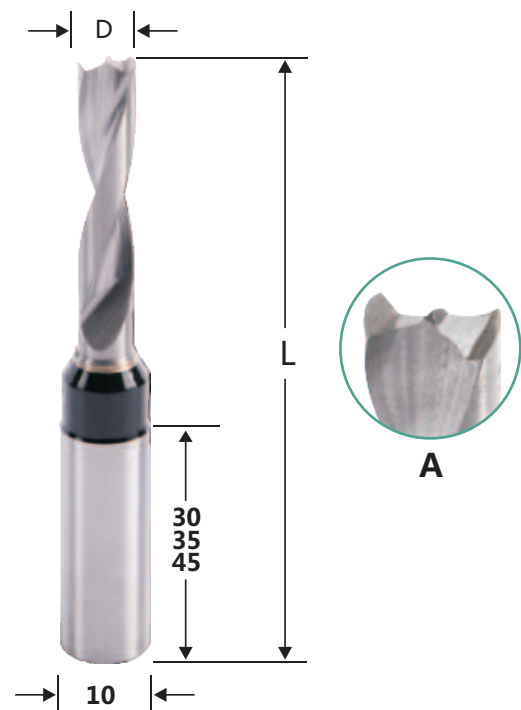

编号/N	旋向/R	刃径/D	总长/L
10101/10201	R/L	2	57/70
10102/10202	R/L	2.5	57/70
10103/10203	R/L	3	57/70
10104/10204	R/L	3.5	57/70
10105/10205	R/L	4	57/70
10106/10206	R/L	4.5	57/70
10107/10207	R/L	5	57/70
10108/10208	R/L	6	57/70
10109/10209	R/L	8	57/70

#### Manufacturing Process:

- 1、Fine particles of tungsten steel round bar and low temperature welding process ensure the quality of weld.
- 2、Epsilon-type blade edge and the negative rear angle design of crossed blade ensure the smooth bottom of the hole.
- 3、The four axis cnc machining center tool guarantees the accuracy effectively by the one-step molding technology.

### 科技 I 型B款 (KJ1-B) Solid Carbide Dowel Drills (B)

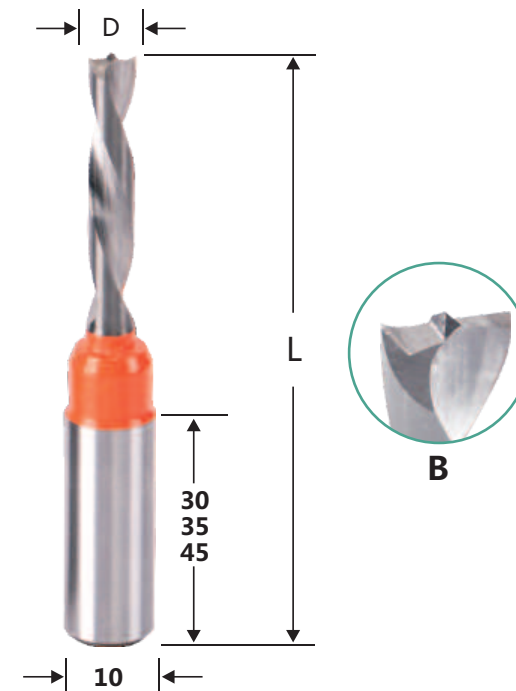

### 科技 I 型C款 (KJ1-C) Solid Carbide Dowel Drills (C)

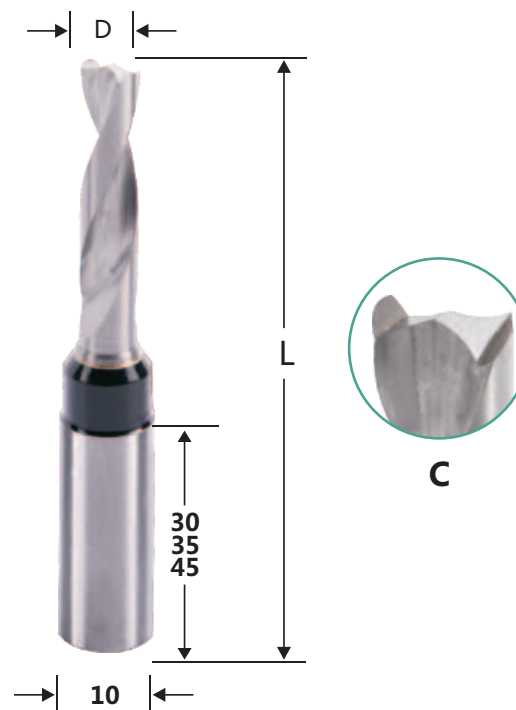

mdf	chipboard	laminated board	hardwood	softwood	plywood
中密度板	刨花板	贴面板	硬木	软木	胶合板
★★★★★	★★★	★★★★★	★★★★★	★★★★★	★★★

单位(unit)=mm

编号/N	旋向/R	刃径/D	总长/L
20101/20201	R/L	2	57/70
20102/20202	R/L	2.5	57/70
20103/20203	R/L	3	57/70
20104/20204	R/L	3.5	57/70
20105/20205	R/L	4	57/70
20106/20206	R/L	4.5	57/70
20107/20207	R/L	5	57/70
20108/20208	R/L	6	57/70
20109/20209	R/L	8	57/70

#### Manufacturing Process:

- 1、Fine particles of tungsten steel round bar and low temperature welding process ensure the quality of weld.
- 2、Epsilon-type blade edge and the negative rear angle design of crossed blade ensure the smooth bottom of the hole.
- 3、The four axis cnc machining center tool guarantees the accuracy effectively by the one-step molding technology.

mdf	chipboard	laminated board	hardwood	softwood	plywood
中密度板	刨花板	贴面板	硬木	软木	胶合板
★★★★★	★★★★★	★★★★★	★★★★★	★★★★★	★★★★★

单位(unit)=mm

编号/N	旋向/R	刃径/D	总长/L
30101/30201	R/L	2	57/70
30102/30202	R/L	2.5	57/70
30103/30203	R/L	3	57/70
30104/30204	R/L	3.5	57/70
30105/30205	R/L	4	57/70
30106/30206	R/L	4.5	57/70
30107/30207	R/L	5	57/70
30108/30208	R/L	6	57/70
30109/30209	R/L	8	57/70

#### Manufacturing Process:

- 1、Fine particles of tungsten steel round bar and low temperature welding process ensure the quality of weld.
- 2、W-type blade edge and the negative rear angle design of crossed blade ensure the drill with smooth.
- 3、The four axis cnc machining center tool guarantees the accuracy effectively by the one-step molding technology.



科技 I 型通孔钻  
(KJ1-V)  
Dowel Drills for Through Hole

mdf	chipboard	laminated board	hardwood	softwood	plywood
中密度板	刨花板	贴面板	硬木	软木	胶合板
★★★★★	★★★★★	★★★★★	★★★★	★★★★	★★★★

单位(unit)=mm

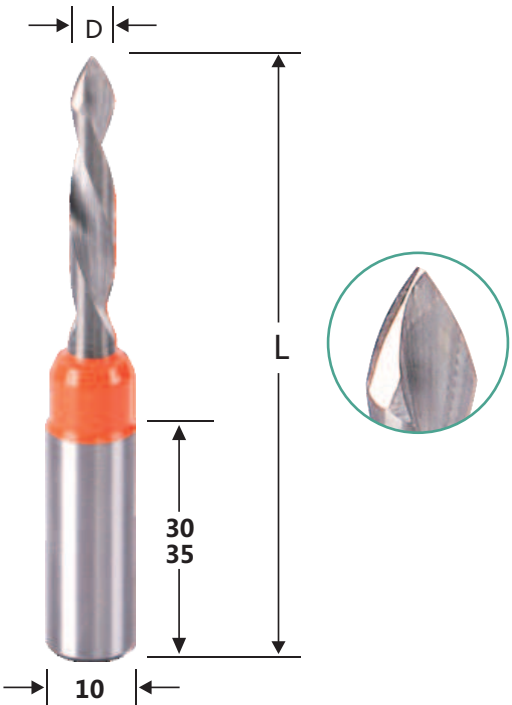

编号/N	旋向/R	刃径/D	总长/L
40101/40201	R/L	3	57/70
40102/40202	R/L	3.5	57/70
40103/40203	R/L	4	57/70
40104/40204	R/L	4.5	57/70
40105/40205	R/L	5	57/70
40106/40206	R/L	5.5	57/70
40107/40207	R/L	6	57/70
40108/40208	R/L	8	57/70

Manufacturing Process:

- 1、Fine particles of tungsten steel round bar and low temperature welding process ensure the quality of weld.
- 2、v-type blade edge and fast speed of drilling ensure the artifact does not collapse.
- 3、The five axis cnc machining center tool guarantees the accuracy effectively by the one-step molding technology.



科技 II 型 A 款  
(KJ2-A)  
Flute Dowel Drills (A)

mdf	chipboard	laminated board	hardwood	softwood	plywood
中密度板	刨花板	贴面板	硬木	软木	胶合板
★★★★★	★★★★★	★★★★	★★★★	★★★★	★★★★

单位(unit)=mm

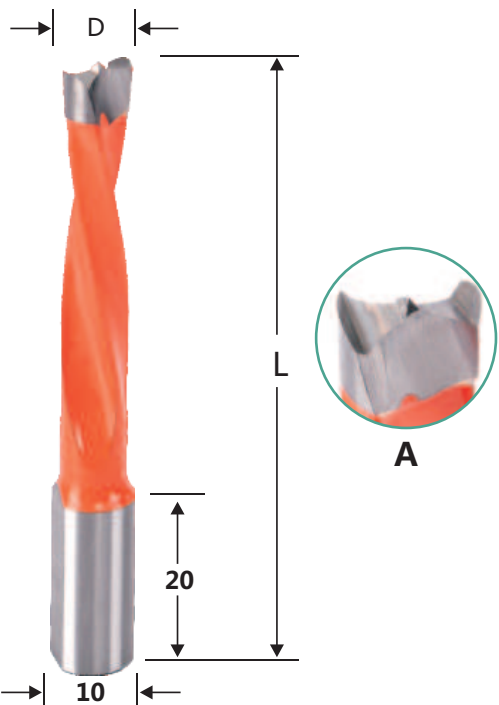

编号/N	旋向/R	刃径/D	总长/L
60101/60201	R/L	5	57/70
60102/60202	R/L	6	57/70
60103/60203	R/L	7	57/70
60104/60204	R/L	8	57/70
60105/60205	R/L	8.5	57/70
60106/60206	R/L	9	57/70
60107/60207	R/L	9.8	57/70
60108/60208	R/L	10	57/70
60109/60209	R/L	11	57/70
60110/60210	R/L	12	57/70
60111/60211	R/L	15	57/70

Manufacturing Process:

- 1、Fine particles of tungsten steel cutter head and low temperature welding process ensure the quality of weld.
- 2、Epsilon-type blade edge and the negative rear angle design of crossed blade ensure the smooth bottom of the hole.
- 3、The four axis cnc machining center tool guarantees the accuracy effectively by the one-step molding technology.
- 4、Special surface treatment process reduces friction.





科技Ⅱ型B款  
(KJ2-B)  
Flute Dowel Drills (B)

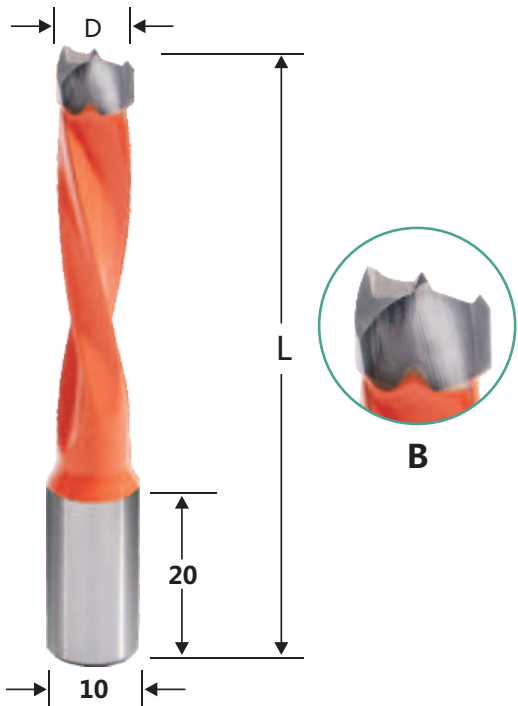

mdf	chipboard	laminated board	hardwood	softwood	plywood
中密度板	刨花板	贴面板	硬木	软木	胶合板
★★★★	★★★	★★★★★	★★★★	★★★★★	★★★

单位(unit)=mm

编号/N	旋向/R	刃径/D	总长/L
70101/70201	R/L	5	57/70
70102/70202	R/L	6	57/70
70103/70203	R/L	7	57/70
70104/70204	R/L	8	57/70
70105/70205	R/L	8.5	57/70
70106/70206	R/L	9	57/70
70107/70207	R/L	9.8	57/70
70108/70208	R/L	10	57/70
70109/70209	R/L	11	57/70
70110/70210	R/L	12	57/70
70111/70211	R/L	15	57/70

Manufacturing Process:

- 1、Fine particles of tungsten steel cutter head and low temperature welding process ensure the quality of weld.
- 2、Epsilon-type blade edge and the negative rear angle design of crossed blade ensure the smooth bottom of the hole.
- 3、The four axis cnc machining center tool guarantees the accuracy effectively by the one-step molding technology.
- 4、Special surface treatment process reduces friction.

mdf	chipboard	laminated board	hardwood	softwood	plywood
中密度板	刨花板	贴面板	硬木	软木	胶合板
★★★★★	★★★★★	★★★	★★★★	★★★★	★★★

单位(unit)=mm

编号/N	旋向/R	刃径/D	总长/L
80101/80201	R/L	5	57/70
80102/80202	R/L	6	57/70
80103/80203	R/L	7	57/70
80104/80204	R/L	8	57/70
80105/80205	R/L	8.5	57/70
80106/80206	R/L	9	57/70
80107/80207	R/L	9.8	57/70
80108/80208	R/L	10	57/70
80109/80209	R/L	11	57/70
80110/80210	R/L	12	57/70
80111/80211	R/L	15	57/70

Manufacturing Process:

- 1、Fine particles of tungsten steel cutter head and low temperature welding process ensure the quality of weld.
- 2、W-type blade edge and the negative rear angle design of crossed blade.
- 3、The four axis cnc machining center tool guarantees the accuracy effectively by the one-step molding technology.
- 4、Special surface treatment process reduces friction.

科技Ⅱ型通孔钻  
(KJ2-V)  
Flute Dowel Drills for Through Hole

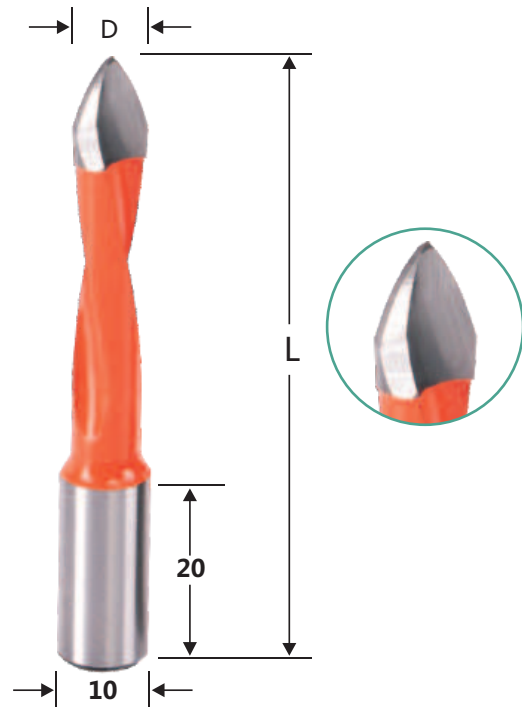

mdf	chipboard	laminated board	hardwood	softwood	plywood
中密度板	刨花板	贴面板	硬木	软木	胶合板
★★★★★	★★★★★	★★★★	★★★★★	★★★★★	★★★

单位(unit)=mm

编号/N	旋向/R	刃径/D	总长/L
90101/90201	R/L	5	57/70
90103/90203	R/L	6	57/70
90105/90205	R/L	7	57/70
90106/90206	R/L	8	57/70
90107/90207	R/L	9	57/70
90109/90209	R/L	10	57/70
90110/90210	R/L	12	57/70

Manufacturing Process:

- 1、Fine particles of tungsten steel cutter head and low temperature welding process ensure the quality of weld.
- 2、v-type blade edge and fast speed of drilling ensure the artifact does not collapse.
- 3、The five axis cnc machining center tool guarantees the accuracy effectively by the one-step molding technology.
- 4、Special surface treatment process reduces friction.

科技Ⅱ型C款  
(KJ2-C)  
Flute Dowel Drills (C)

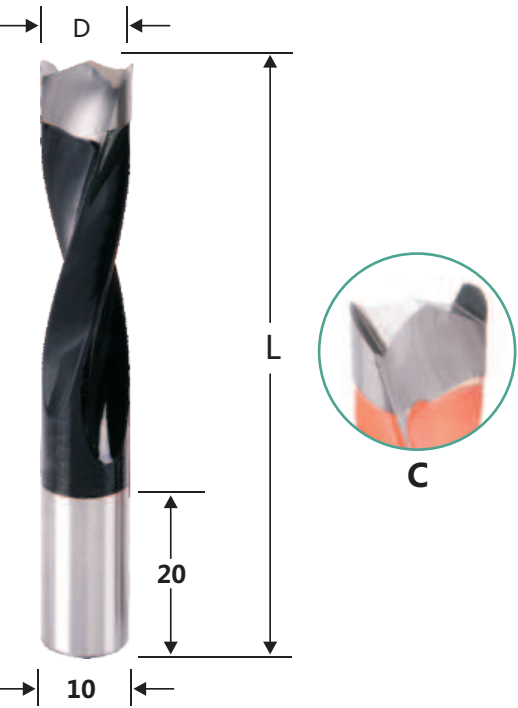



专业型  
( ZY-57/70 )  
Economical Dowel Drills

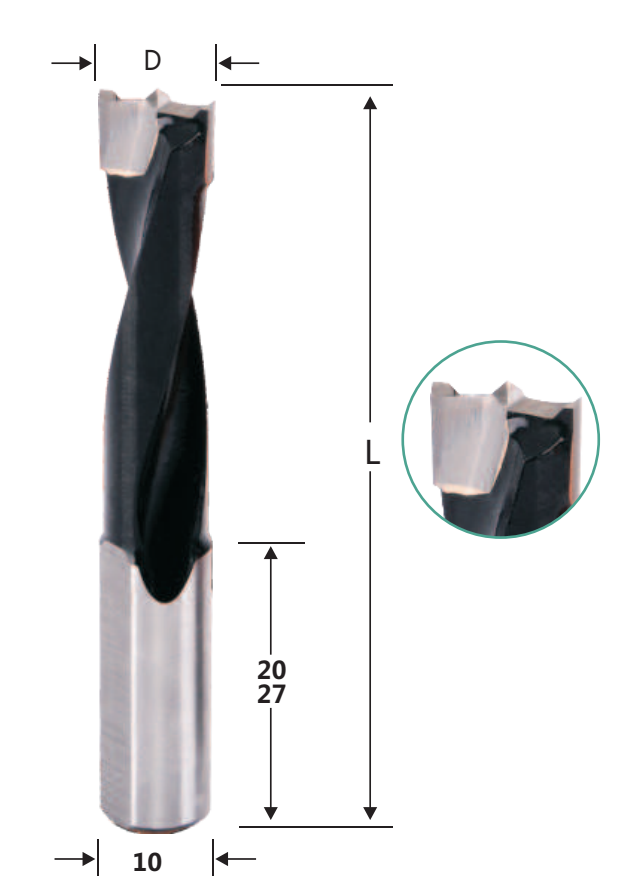

Manufacturing Process:

- 1、Fine particles of tungsten steel cutter head and low temperature welding process ensure the quality of weld.
- 2、The four axis cnc machining center tool guarantees the accuracy effectively by the one-step molding technology.
- 3、Special surface treatment process reduces friction.



mdf	chipboard	laminated board	hardwood	softwood	plywood
中密度板	刨花板	贴面板	硬木	软木	胶合板
★★★★	★★★★	★★★★	★★★★	★★★★★	★★★

单位(unit)=mm

编号/N	旋向/R	刃径/D	总长/L
110101/110201	R/L	3	57/70
110102/110202	R/L	3.5	57/70
110103/110203	R/L	4	57/70
110104/110204	R/L	4.5	57/70
110105/110205	R/L	4.8	57/70
110106/110206	R/L	5.0	57/70
110107/110207	R/L	5.5	57/70
110108/110208	R/L	6	57/70
110109/110209	R/L	6.2	57/70
110110/110210	R/L	6.5	57/70
110111/110211	R/L	7.0	57/70
110112/110212	R/L	7.5	57/70
110113/110213	R/L	7.8	57/70
110114/110214	R/L	8	57/70
110115/110215	R/L	8.5	57/70
110116/110216	R/L	9	57/70
110117/110217	R/L	9.5	57/70
110118/110218	R/L	9.8	57/70
110119/110219	R/L	10	57/70
110120/110220	R/L	10.2	57/70
110121/110221	R/L	10.5	57/70
110122/110222	R/L	11	57/70
110123/110223	R/L	11.5	57/70
110124/110224	R/L	12	57/70
110125/110225	R/L	13	57/70
110126/110226	R/L	14	57/70
110127/110227	R/L	15	57/70



加长型  
( ZY-80/90/100 )  
Long Type Economical Dowel Drills

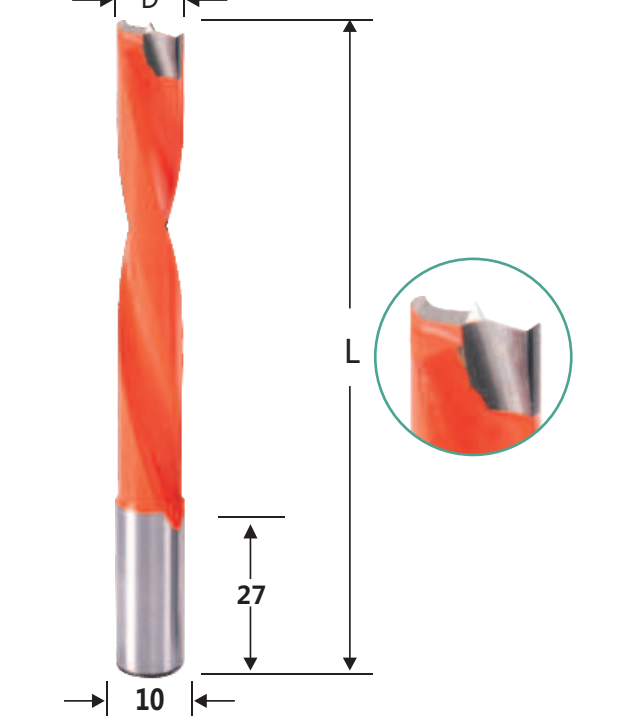

专业型通孔钻  
( ZY-V )  
Economical Dowel Drills for Through Hole

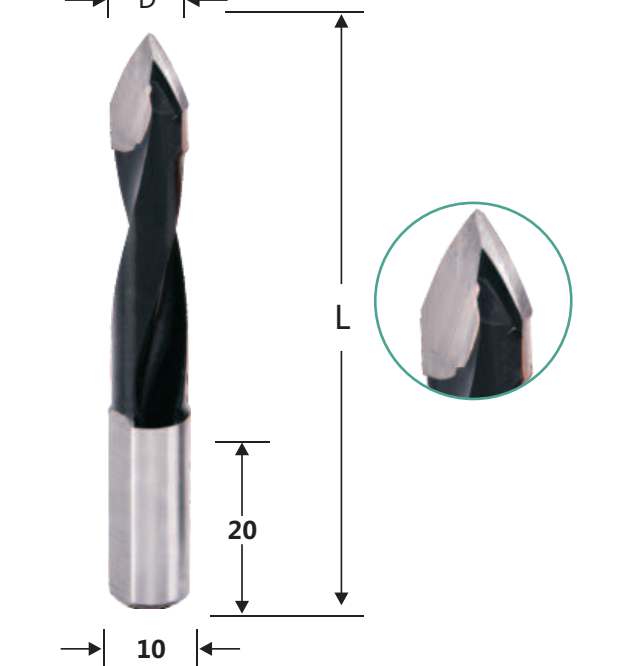

mdf	chipboard	laminated board	hardwood	softwood	plywood
中密度板	刨花板	贴面板	硬木	软木	胶合板
★★★★	★★★★	★★★★	★★★★	★★★★★	★★★

单位(unit)=mm

编号/N	旋向/R	刃径/D	总长/L
120101/120201	R/L	8	80/90/100
120102/120202	R/L	9	80/90/100
120103/120203	R/L	10	80/90/100
120104/120204	R/L	12	80/90/100
120105/120205	R/L	15	80/90/100

Manufacturing Process:

- 1、Fine particles of tungsten steel cutter head and low temperature welding process ensure the quality of weld.
- 2、The four axis cnc machining center tool guarantees the accuracy effectively by the one-step molding technology.
- 3、Special surface treatment process reduces friction.

mdf	chipboard	laminated board	hardwood	softwood	plywood
中密度板	刨花板	贴面板	硬木	软木	胶合板
★★★★	★★★★	★★★★	★★★★	★★	★★

单位(unit)=mm

编号/N	旋向/R	刃径/ D	总长/L
130101/130201	R/L	5	57/70
130102/130202	R/L	6	57/70
130103/130203	R/L	7	57/70
130104/130204	R/L	8	57/70
130105/130205	R/L	9	57/70
130106/130206	R/L	10	57/70
130107/130207	R/L	12	57/70
130108/130208	R/L	15	57/70

Manufacturing Process:

- 1、Fine particles of tungsten steel cutter head and low temperature welding process ensure the quality of weld.
- 2、The four axis cnc machining center tool guarantees the accuracy effectively by the one-step molding technology.
- 3、Special surface treatment process reduces friction.

分体钻  
(FT-57/70)  
Hinge Boring Bits

mdf	chipboard	laminated board	hardwood	softwood	plywood
中密度板	刨花板	贴面板	硬木	软木	胶合板
★★★★★	★★★★★	★★★★★	★★★★★	★★★★★	★★★★★

单位(unit)=mm

编号/N	旋向/R	刃径/D	总长/L	编号/N	旋向/R	刃径/D	总长/L
140101/140201	R/L	12	57/70	140116/140216	R/L	30	57/70
140102/140202	R/L	15	57/70	140117/140217	R/L	32	57/70
140103/140203	R/L	16	57/70	140118/140218	R/L	34	57/70
140104/140204	R/L	17	57/70	140119/140219	R/L	35	57/70
140105/140205	R/L	18	57/70	140120/140220	R/L	36	57/70
140106/140206	R/L	19	57/70	140121/140221	R/L	37	57/70
140107/140207	R/L	20	57/70	140122/140222	R/L	38	57/70
140108/140208	R/L	21	57/70	140123/140223	R/L	40	57/70
140109/140209	R/L	22	57/70	140124/140224	R/L	50	57/70
140110/140210	R/L	23	57/70	140125/140225	R/L	53	57/70
140111/140211	R/L	24	57/70	140126/140226	R/L	55	57/70
140112/140212	R/L	25	57/70	140127/140227	R/L	60	57/70
140113/140213	R/L	26	57/70	140128/140228	R/L	65	57/70
140114/140214	R/L	27	57/70	140129/140229	R/L	70	57/70
140115/140215	R/L	28	57/70	140130/140230	R/L	80	57/70



Manufacturing Process:

- 1、Fine particles of tungsten steel cutter head and low temperature welding process ensure the quality of weld.
- 2、The four axis cnc machining center tool guarantees the accuracy effectively by the one-step molding technology.
- 3、Special surface treatment process reduces friction.



科技型铰链钻  
(KJ-FT-57/70)  
Solid Carbide Hinge Boring Bits

单位(unit)=mm

编号/N	旋向/R	刃径/D	总长/L
150101/150201	R/L	15	57/70
150102/150202	R/L	16	57/70
150103/150203	R/L	17	57/70
150104/150204	R/L	18	57/70
150105/150205	R/L	19	57/70
150106/150206	R/L	20	57/70
150107/150207	R/L	25	57/70
150108/150208	R/L	30	57/70
150109/150209	R/L	35	57/70

Manufacturing Process:

- 1、Fine particles of tungsten steel cutter head and low temperature welding process ensure the quality of weld.
- 2、The four axis cnc machining center tool guarantees the accuracy effectively by the one-step molding technology.
- 3、high angle cyclone design makes the drilling more light and drill bit more durable.

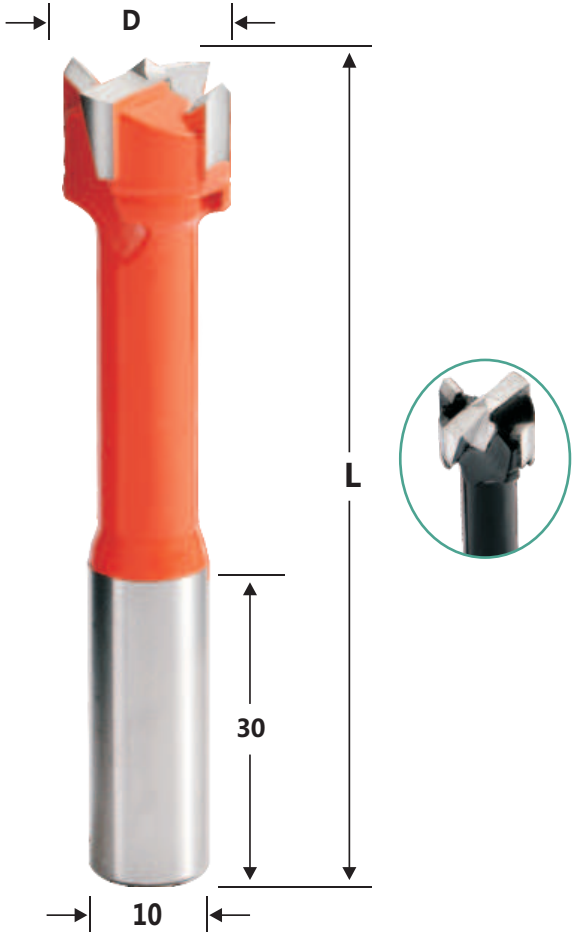



# 排钻快换接头 Adaptors

单位(unit)=mm



型号/type : A型

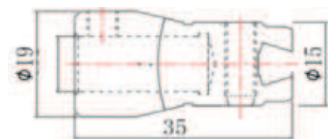

型号/type : B-12-S型



型号/type : B-12-30°型

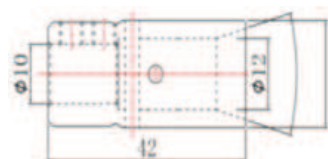

型号/type : B-14-40型 一字销/十字销

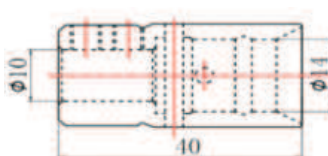

型号/type : B-14-45型 一字销/十字销

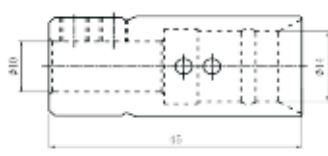

型号/type : G型

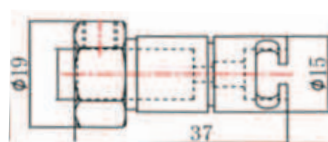

型号/type : C-M8-R/L

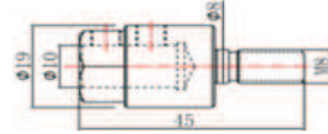

型号/type : C-M10-R/L

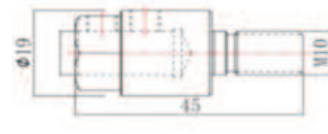

型号/type : D-M8-R/L

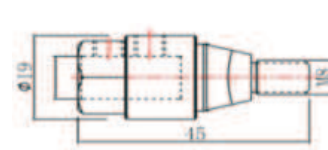

型号/type : D-M10-R/L

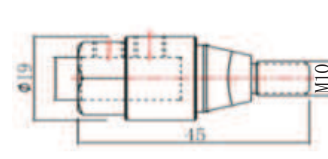

型号/type : E型



型号/type : F型

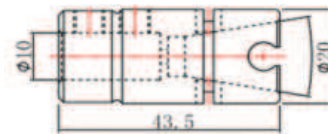

型号/type : H型

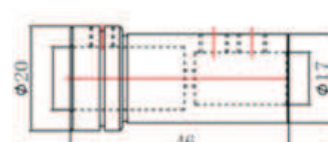

# T.C.T整体合金直刀 (TCT)

T.C.T. Solid Carbide Straight Bits

mdf	chipboard	hardwood	softwood	plywood
中密度板	刨花板	硬木	软木	胶合板
★★★★	★★★★	★★★★	★★★★★	★★★

单位(unit)=mm  
注: 1/2, 1/4 为英制单位

编号/N	柄径/SD	齿数/FLUTE	刃径/D	刃长/L
160101/160201/160301	1/2, 1/4, 6, 8, 10, 12	1	1	4
160102/160202/160302	1/2, 1/4, 6, 8, 10, 12	1	1.5	5
160103/160203/160303	1/2, 1/4, 6, 8, 10, 12	2	2	6
160104/160204/160304	1/2, 1/4, 6, 8, 10, 12	2	3	10/12/15
160105/160205/160305	1/2, 1/4, 6, 8, 10, 12	2	3.5	12/15
160106/160206/160306	1/2, 1/4, 6, 8, 10, 12	2	4	10/12/15
160107/160207/160307	1/2, 1/4, 6, 8, 10, 12	2	4	20
160108/160208/160308	1/2, 1/4, 6, 8, 10, 12	2	4.5	15
160109/160209/160309	1/2, 1/4, 6, 8, 10, 12	2	5	12
160110/160210/160310	1/2, 1/4, 6, 8, 10, 12	2	5	15
160111/160211/160311	1/2, 1/4, 6, 8, 10, 12	2	5	20
160112/160312	1/2, 6, 8, 10, 12	2	5.5	12
160113/160313	1/2, 6, 8, 10, 12	2	5.5	15
160114/160314	1/2, 6, 8, 10, 12	2	6	12
160115/160315	1/2, 6, 8, 10, 12	2	6	15
160116/160316	1/2, 6, 8, 10, 12	2	6	20
160117/160317	1/2, 6, 8, 10, 12	2	6	25
160118/160318	1/2, 6, 8, 10, 12	2	7	25
160119/160319	1/2, 6, 8, 10, 12	2	8	25/30
160120/160320	1/2, 6, 8, 10, 12	2	10	30

## Manufacturing Process:

1. Fine particles of tungsten steel with the technology of low temperature welding process.
2. The four axis CNC grinding machine has the technology of one-step molding make higher precision.



# 非标定制

Customization

mdf	chipboard	hardwood	softwood	plywood
中密度板	刨花板	硬木	软木	胶合板
★★★★	★★★★	★★★★	★★★★★	★★★

单位(unit)=mm  
注: 1/2 为英制单位

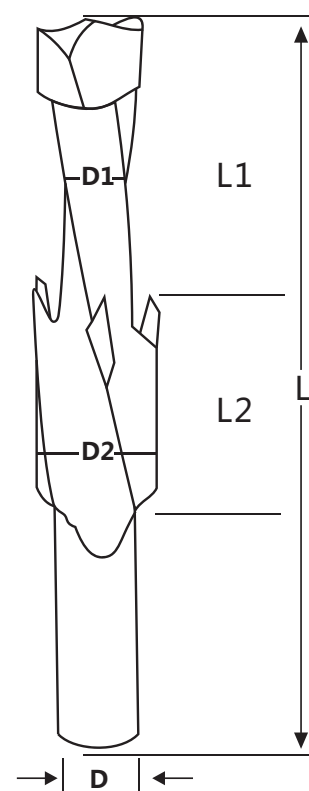

D1xL1+D2xL  
D=? L2=?

## Manufacturing Process:

- 1、Fine particles of tungsten steel with the technology of low temperature welding process.
- 2、The four axis CNC grinding machine has the technology of one-step molding make higher precision.

**雅森® CONTENTS**

更多产品资讯尽在: <http://yasengj.1688.com>

# 工业级木工排钻

## INDUSTRIAL WOODWORKING DRILL BITS

### 科技 I 型 KJ1

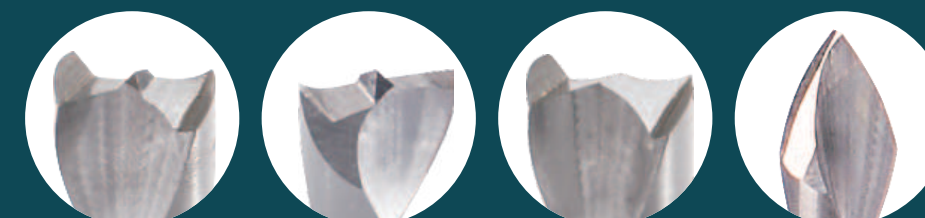

A

B

C

V

### 科技 II 型 KJ2

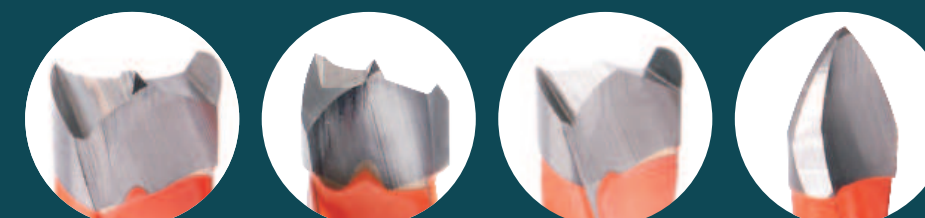

A

B

C

V

造精工之雅，兴木业之森

BUILD THE ELEGANCE OF PERFECT , PROSPER THE FLOURISH OF CARPENTRY