

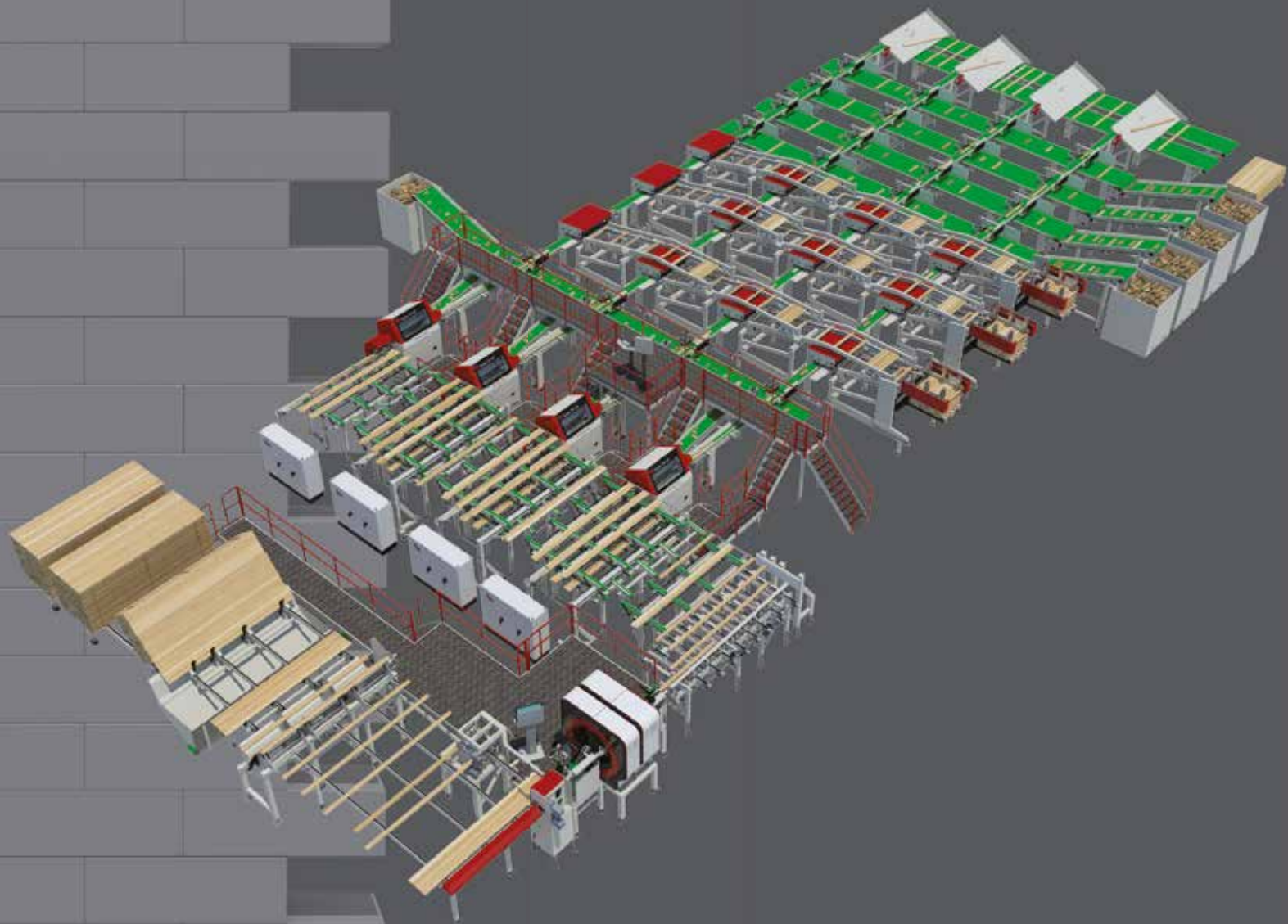

Opti-Solutions
Customized system solutions



Optimization of staff and wood resources

03 Customized system solutions

04 Total Supplier

06 Opti-Solutions

- Door manufacturer
- Building components manufacturer
- Flooring manufacturer
- Moulding & millwork manufacturer
- Pallet manufacturer
- Moulding & millwork manufacturer
- Furniture manufacturer

20 Additional products

22 System TM service

Customized system solutions

System TM is the leading manufacturer globally of customized system solutions for the solid wood industry, and has more than 35 years' experience.

We are experts in combining different main machines with material handling, giving our customers highly integrated and fully optimized lines with regards to capacity, yield and staff resources. The success of our business is based on our understanding of the customer's needs, while creative use of knowledge and technology forms the foundation of our core competencies.

Opti-Solutions are characterized by:

- ▶ One total supplier
- ▶ Individually designed and manufactured with regards to capacities, processes and layout
- ▶ 100% workpiece control throughout the line
- ▶ Complete hard- and software integration between all functions of the line
- ▶ Low labor costs and optimal line utilization
- ▶ Higher efficiency of all main machines
- ▶ Project management

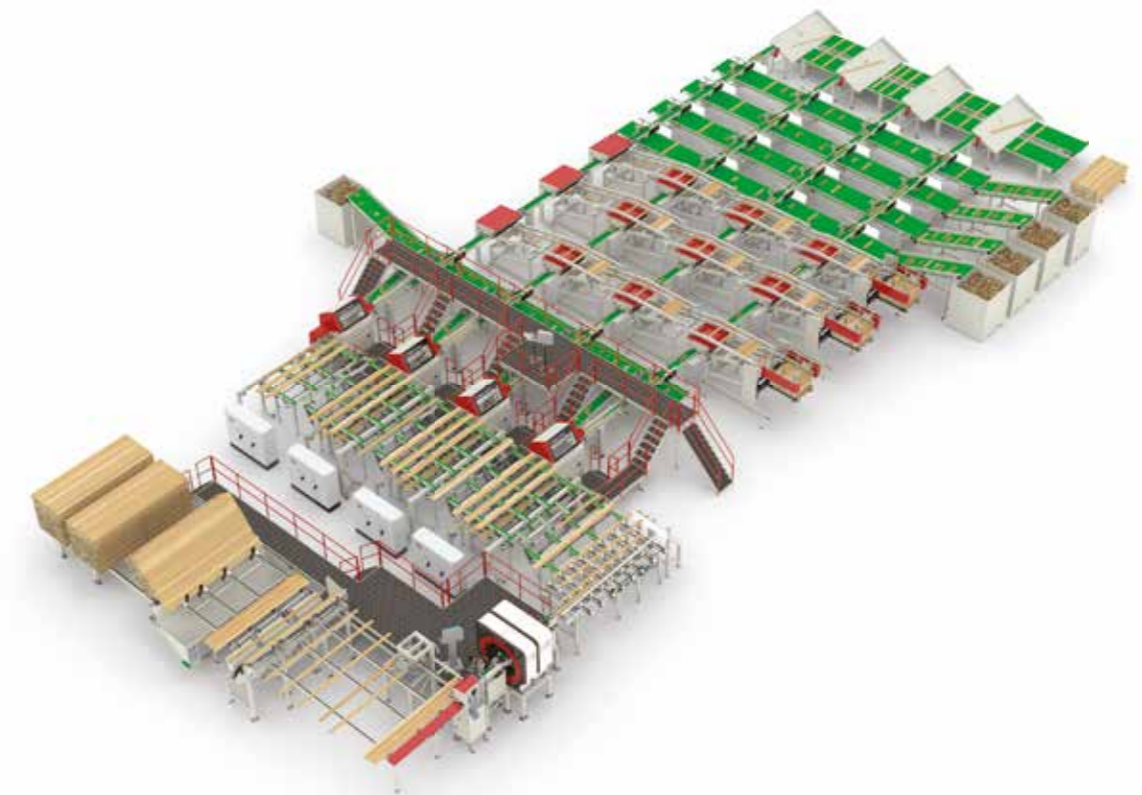

▶ **Make a wise move**

- let an Opti-Solution increase your production capacity and reduce your labor cost!!

Total supplier

System TM as your total supplier

When choosing System TM as your total supplier you will benefit from the vast experience of our entire team. System TM takes full responsibility for the entire process, and will be your only supplier when you invest in a single system or an entire system solution.

The competencies of System TM covers everything from line design, installation, commissioning and staff training to service and maintenance - all to make your production as efficient as possible. With our technical expertise and experience, we can advise you on all technical aspects and we offer the best support and advice in the industry.

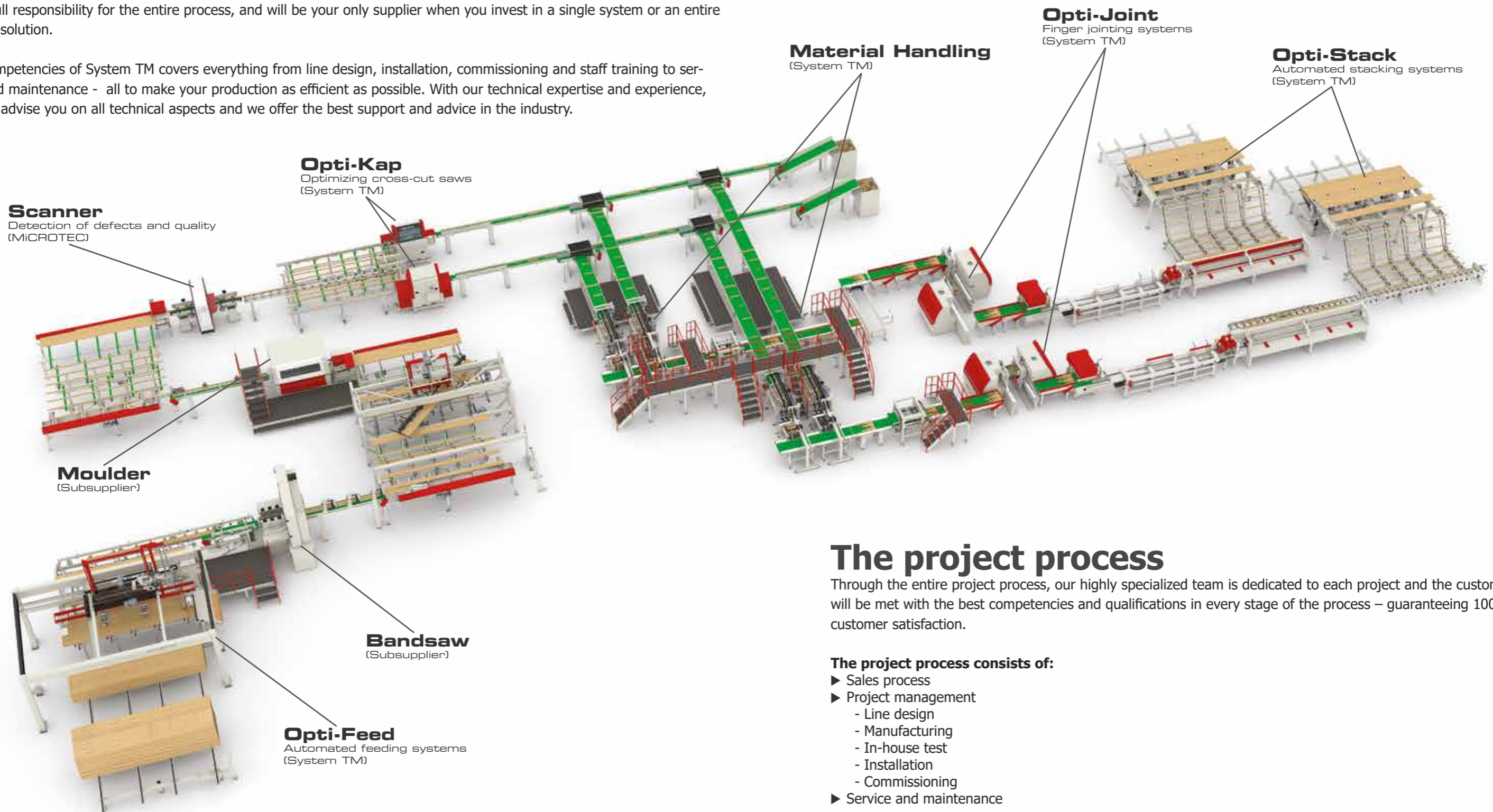

The project process

Through the entire project process, our highly specialized team is dedicated to each project and the customer will be met with the best competencies and qualifications in every stage of the process – guaranteeing 100% customer satisfaction.

The project process consists of:

- ▶ Sales process
- ▶ Project management
 - Line design
 - Manufacturing
 - In-house test
 - Installation
 - Commissioning
- ▶ Service and maintenance

Door manufacturer

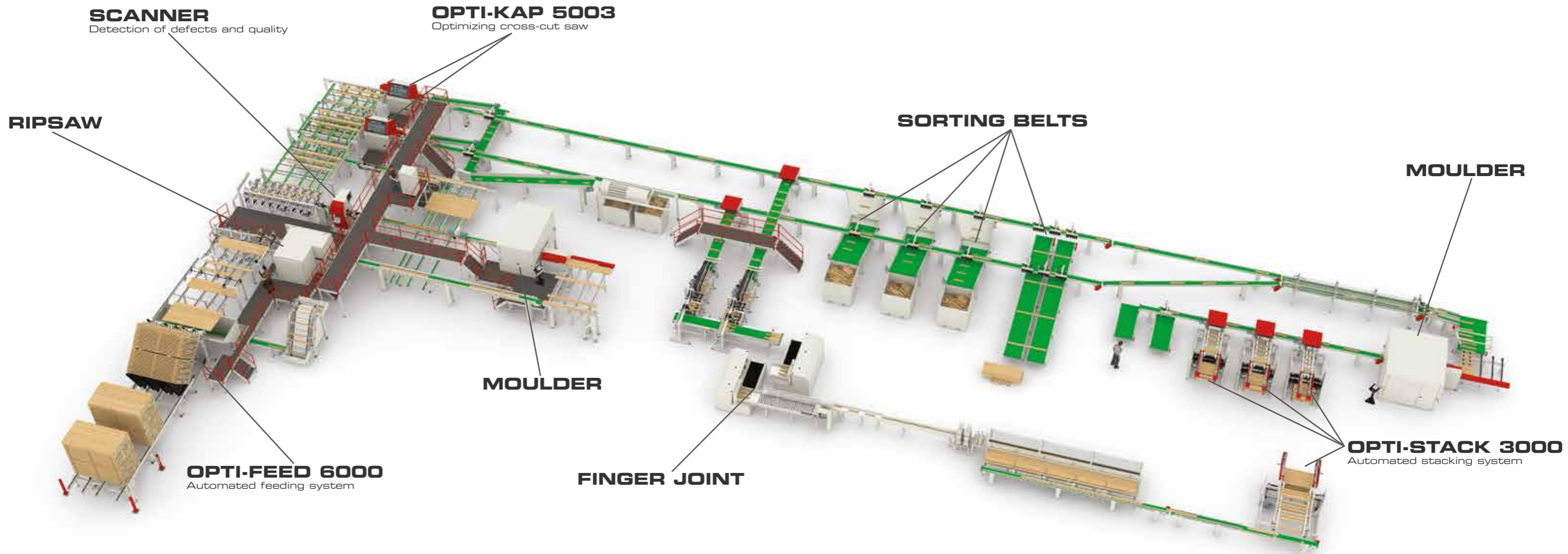

This Opti-Solution is an optimizing cross-cut line consisting of an Opti-Feed 6000 automatic feeding system that destacks, separates and turns the workpieces before a rip saw.

The rip saw splits the workpieces before a moulder that calibrates the top and bottom surface for an optimal scanning detection.

Two Opti-Kap 5003 cross-cut saws cut the wood according to the scanning result for the best wood utilization. After cross-cutting the workpieces are sorted for finger joint or fixed lengths components. All workpieces are stacked by four automated Opti-Stack 3000 stacking machines.

Production:	Doors
Wood species:	Softwood
Number of operators:	☺☺☺
Country:	France 

Building components manufacturer

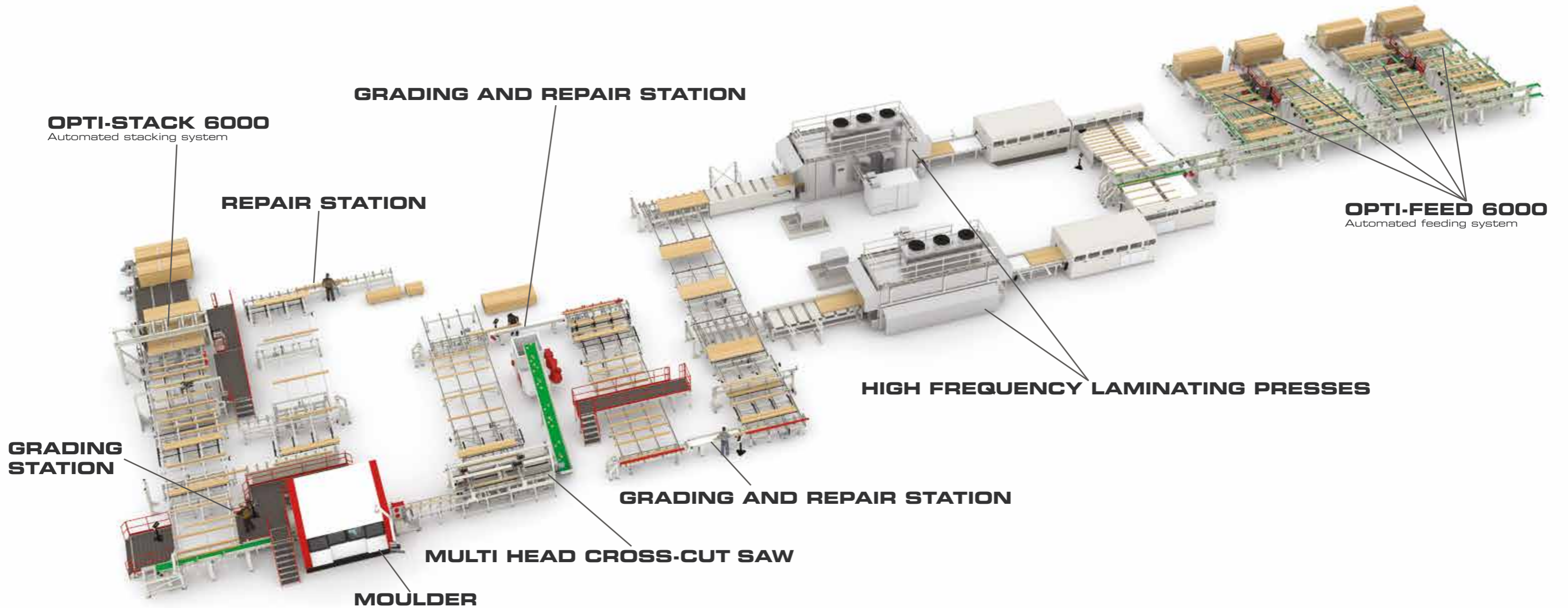

This Opti-Solution is a material handling system that consists of four feeding systems, model Opti-Feed 6000, feeding four different qualities to two high frequency laminating presses.

After laminating, the beams are separated in a buffer system and automatically transported to two grading and repair stations. If needed, the beams are repaired manually by two operators. After the grading and repair stations the beams are transported through a multi head cross-cut saw, model MK2 where the ends are trimmed before moulding.

After the moulder the beams are once again quality checked and repaired if needed, then labelled and transported to the automated stacking machine, model Opti-Stack 6000.

Production:	Building components
Wood species:	Softwood
Number of operators:	👤👤👤👤👤
Country:	Romania 🇷🇴

Flooring manufacturer

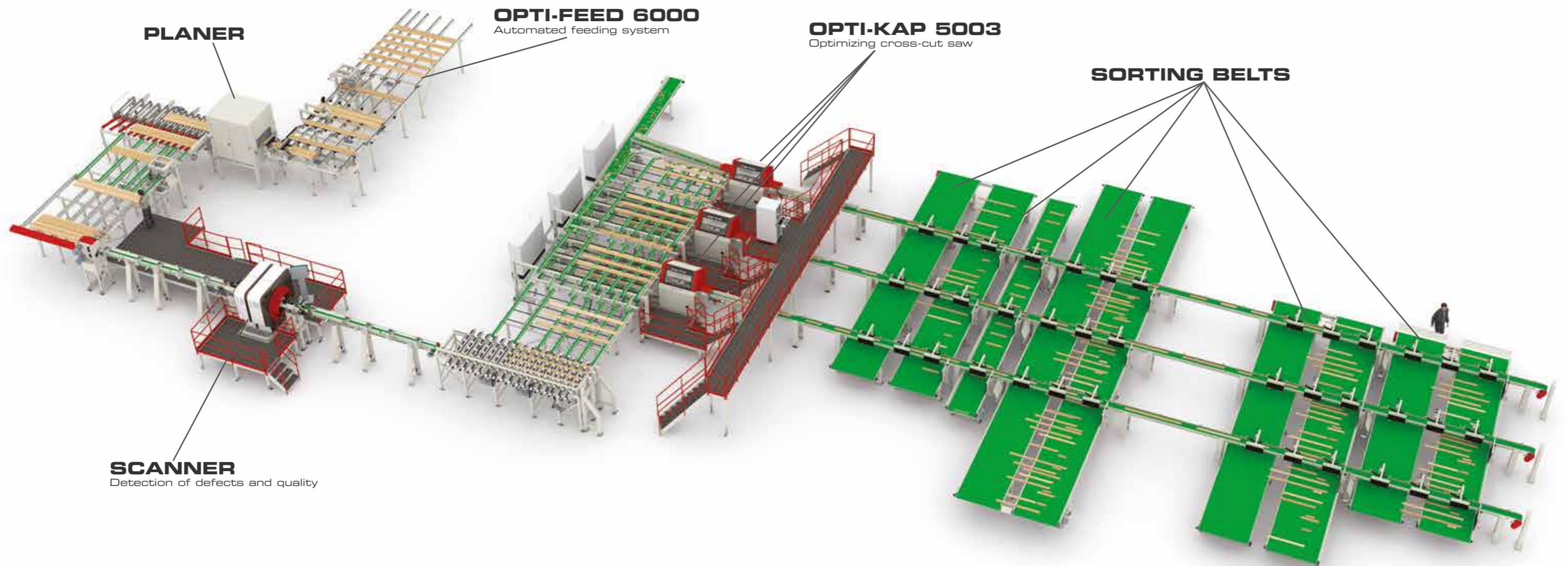

PLANER

OPTI-FEED 6000
Automated feeding system

OPTI-KAP 5003
Optimizing cross-cut saw

SORTING BELTS

SCANNER
Detection of defects and quality

This Opti-Solution is an optimizing cross-cut line consisting of an Opti-Feed 6000 feeding system, that feeds batches of workpieces to a planer. After the planer, the workpieces are automatically transported to a Microtec 502 scanner including x-ray, for detection of defects and quality.

Through a queue control system, the workpieces are then transported to three optimizing cross-cut saws model Opti-Kap 5003, that cuts the workpieces into flooring components. The cross-cut components are then sorted according to the correct lengths, qualities and widths.

Production:	Flooring
Wood species:	Hardwood
Number of operators:	2
Country:	USA 

Moulding & millwork manufacturer

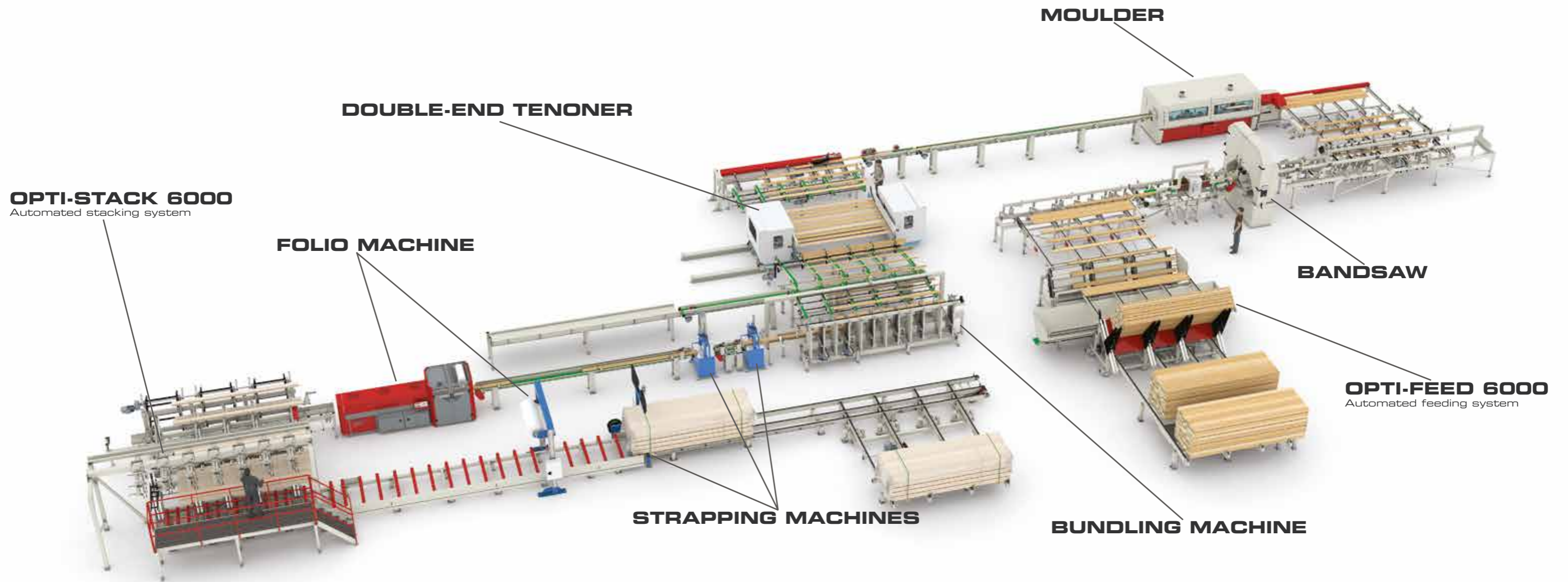

This Opti-Solution is a material handling system consisting of an automatic infeed system model Opti-Feed 6000, that automatically feeds the workpieces to a bandsaw. The bandsaw splits the workpieces into two or three pieces, and the workpieces are subsequently singulated and orientated in the correct order before entering a moulder.

After the moulding process, the workpieces are transported to a double-end tenoner for end profiling, and afterwards automatically bundled in a bundling station. The bundled workpieces are immediately strapped or folioed, and then stacked into big packs by an automatic stacking machine model Opti-Stack 6000. After stacking the full pack is then folioed and strapped.

Production:	Moulding & millwork
Wood species:	Softwood
Number of operators:	2
Country:	France 

Pallet manufacturer

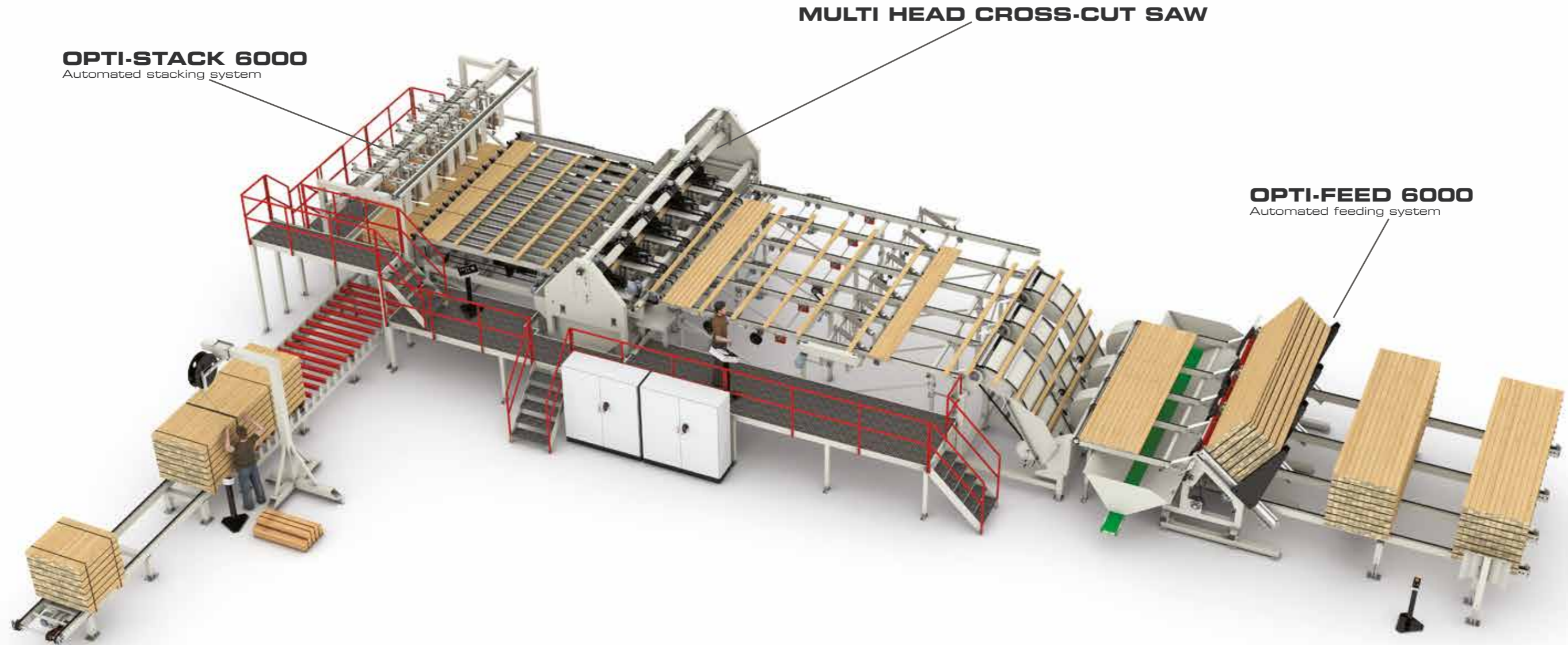

OPTI-STACK 6000
Automated stacking system

MULTI HEAD CROSS-CUT SAW

OPTI-FEED 6000
Automated feeding system

This Opti-Solution is a multi head cross-cut line consisting of an automatic infeed system model Opti-Feed 6000, that automatically feeds the workpieces to a feeding chain conveyor.

The feeding chain conveyor creates layers of the workpieces, and feed the layers into a multi head cross-cut saw model MK5, for multiple cross-cutting. The cross-cut workpieces are then transported to a continuous stacking machine model Opti-Stack 6000, also capable of placing stabilizing sticks in the packs if needed.

After stacking, the packs are automatically separated and transported to a strapping area.

Production:	Pallet
Wood species:	Softwood
Number of operators:	2
Country:	Ireland 

Moulding & millwork manufacturer

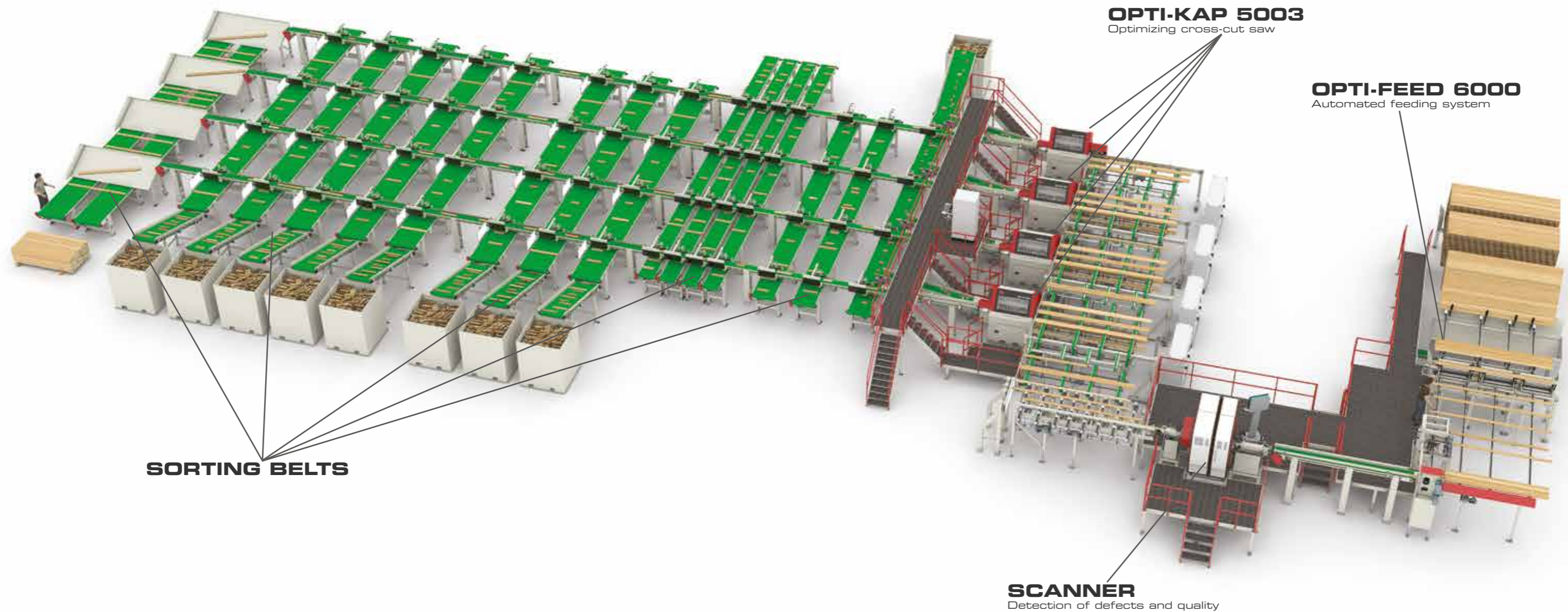

This Opti-Solution is an optimizing cross-cut line consisting of an automatic infeed system model Opti-Feed 6000. The infeed system automatically feeds the workpieces to a Microtec Goldeneye 502 scanner including x-ray, for detection of defects and quality.

Through a queue control system, the workpieces are then transported to four optimizing cross-cut saws model Opti-Kap 5003, that cuts the workpieces into moulding and millwork components. The cross-cut components are then sorted according to the correct lengths and qualities.

Production:	Moulding & millwork
Wood species:	Softwood
Number of operators:	2
Country:	Brazil 

Furniture manufacturer

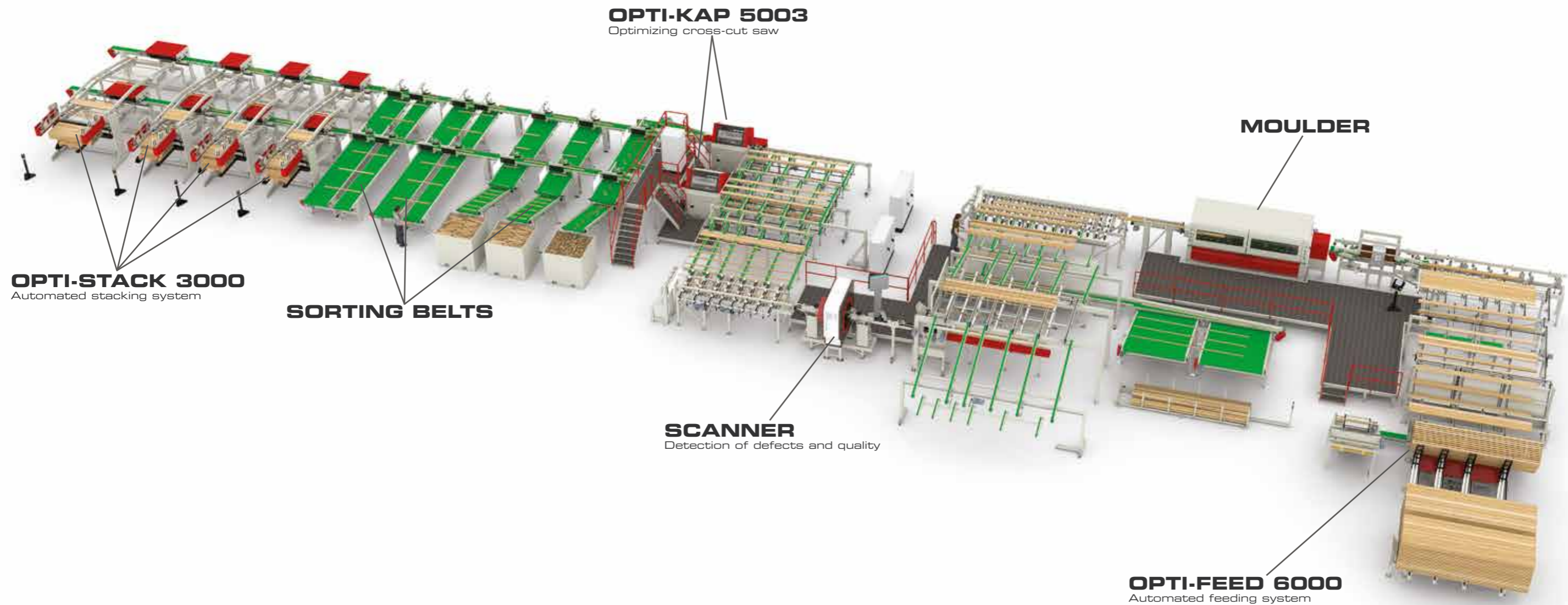

This Opti-Solution is an optimizing cross-cut line consisting of an automatic infeed system model Opti-Feed 6000. The infeed system feeds the raw material to a moulding machine, that splits the workpieces into lamellas. After the moulder, the lamellas are automatically singulated and transported to a Microtec Goldeneye 501 scanner, for detection of defects and quality.

Through a queue control system, the workpieces are then transported to two optimizing cross-cut saws model Opti-Kap 5003, that cuts the workpieces into furniture components.

After cross-cutting, the components are sorted for either finger joint components or fixed lengths, stacked manually or automatically by four stacking machines model Opti-Stack 3000.

Production:	Furniture
Wood species:	Softwood
Number of operators:	2
Country:	Poland 

Additional products

System TM A/S

All products and system solutions from System TM can be equipped with an automatic handling or scanning system for best lumber utilization and capacity, with a minimum use of labor power.

In order to meet all customer demands, our range of material handling systems consist of both standard and fully customized system solutions.



Opti-Feed
Automated feeding systems



Opti-Kap
Optimizing cross-cut saws



Opti-Stack
Automated stacking systems



Opti-Joint
Automated finger jointing systems

MICROTEC

All products and system solutions from System TM can be equipped with an automatic scanning system for best lumber utilization and production optimization.

The scanner partner of System TM is a technology leader within the scanning industry. Their scanners are extremely reliable and accurate when recognizing wood defects in order to automate, streamline and optimize your production.

The identification of the characteristics of the lumber, is based on a Multi-Sensor scanning technology that recognizes knots, cracks, pitch pockets, holes, stains, waness and other board defects as well as their location. With unheard precision, and at a very high speed, the sensors scan the boards for the best possible lumber utilization.

A product or system solution from System TM, combined with today's scanning technology and optimizing software, ensure the best production optimization, at an unbeatable high capacity.

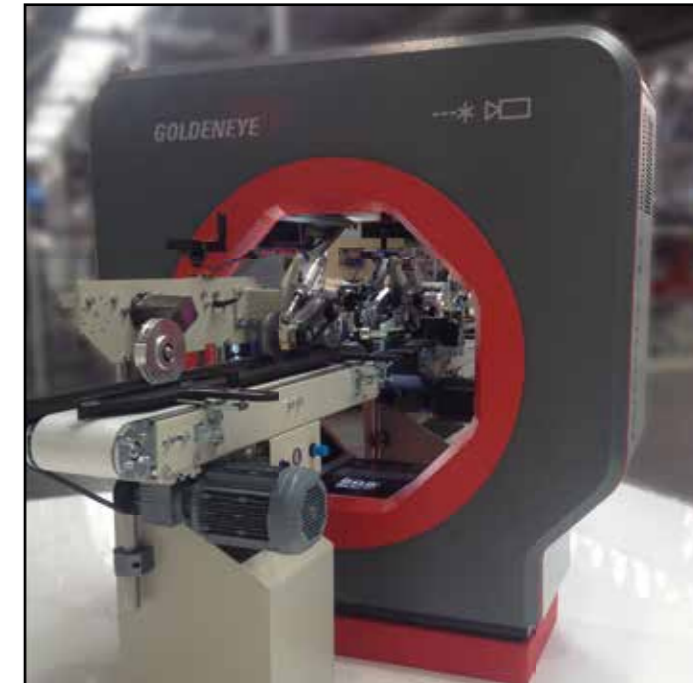

► The Microtec Multi-Sensor Scanner Goldeneye 300 series

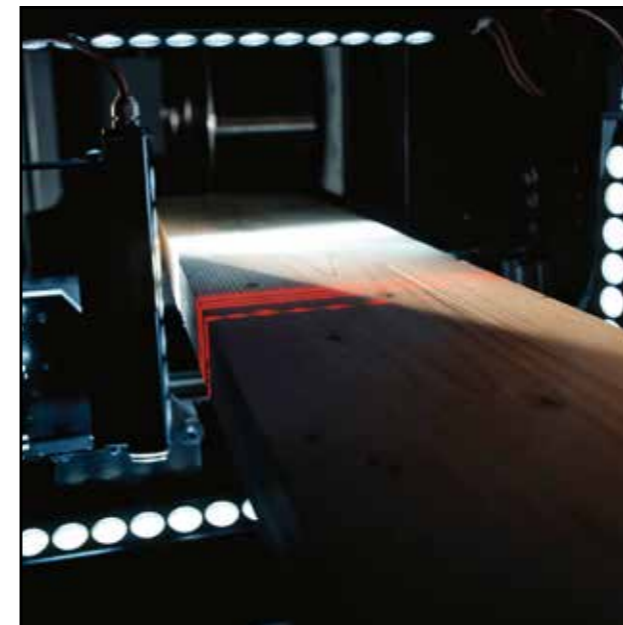

► The multi sensor scanning technology scan the workpieces for best wood utilization.

System TM service

Optimal performance with a strong service- and support team

System TM service is a key strategic business unit. The service department focuses on providing you with service and support and we continuously develop our services to meet your requirements.

System TM service offers you services to ensure uninterrupted operation, with the best possible productivity and utilization. Systematic maintenance minimizes production downtimes, and ensures smooth operation with minimum risk of unexpected events.

System TM service is a team of professionally educated, trained and experienced service engineers and technicians ready to provide full technical support and services. With more than 35 years of experience designing, building, integrating and maintaining automated wood material handling systems, System TM is highly qualified to offer total service and support.

This includes:

- ▶ Service and maintenance contracts
- ▶ Customized kit for each customer to provide a successful start
- ▶ Modification, upgrading and extension of existing machines, controls and software
- ▶ Relocation, renovation, installation and start-up of machine installations
- ▶ Production and system analysis and optimization
- ▶ Staff/operator education on how to handle and maintain the machines
- ▶ Advisory and consultancy service
- ▶ Spare parts and enhancements
- ▶ Warranty
- ▶ Helpdesk and online telephone support - 24 hours worldwide





System TM A/S
Skovdalsvej 35, P.O. Box 249
DK-8300 Odder, Denmark

(Office) + (45) 86 54 33 55
(Fax) + (45) 86 54 32 19
E-mail: tm@systemtm.com
www.systemtm.com



Optimization of staff and wood resources

*System TM cannot be held responsible for any misprints or omissions